

PROCESS ID # 45187  
U.P.R.N No.....

R.P.O. Vol. 58 Fol. 511  
C.T. Vol. 4143 Fol. 487

Cadastral Sheet E.6 O. 35E  
2/c & d  
Ward of Tamana & Turure  
County of St. Andrew

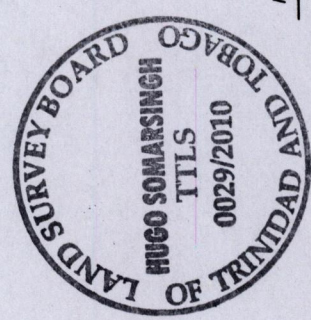
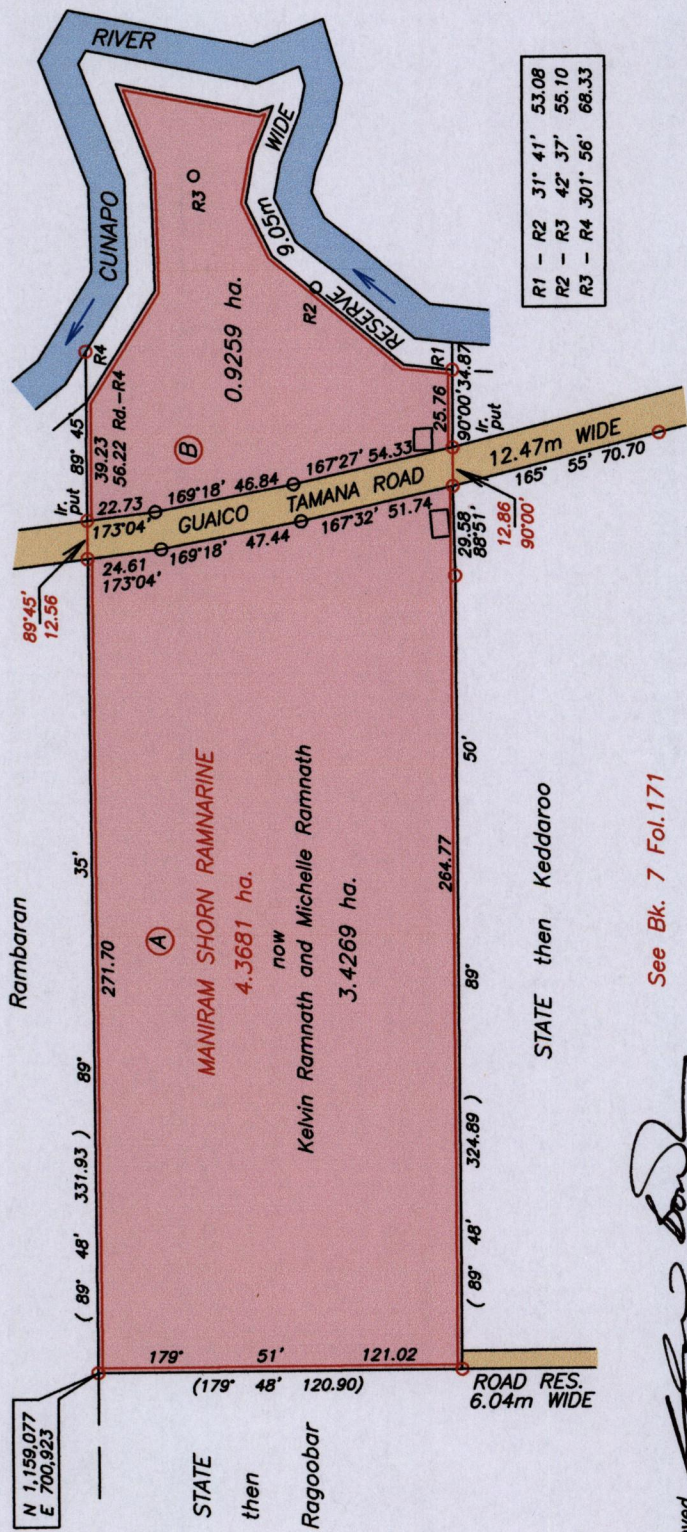

SCALE 1/2500  
Distances are in metres  
Co-ordinate are based on GPS finding  
WGS 84 U.T.M. Zone 20 +/- 3.00m

Approved, *[Signature]*  
Director of Surveys 2012.5.31

- Denotes Iron found unless otherwise stated
- Bearings are Cassini Grid based on Solar Observations
- Note To obtain compass bearings add 12 minutes
- Plan of 2 Parcels of land coloured pink in the Ward of Tamana & Turure
- Containing together four point three five two eight hectares
- Surveyed by me, with due authority in September 2010
- In accordance with Regulation 25 (1) of the Land Surveyors' Regulations 1998 certify that this plan is correct.
- Checked by: *[Signature]* 28/5/12
- Entered on: *[Signature]* 28/5/12

Trinidad and Tobago Land Surveyor..... 17th December 2010

1433  
1955/67

67



1433/67