

Process ID # 51375
R.P.O. Vol. 132 Fol. 243
C.T. Vol. 3152 Fol. 201

U.R.P.N.

Cadastral Sheet G.11.C. 62F
Ward of Siparia
County of St. Patrick
Ref.: Plan A.E. 52
Bk. 712 Fol. 34

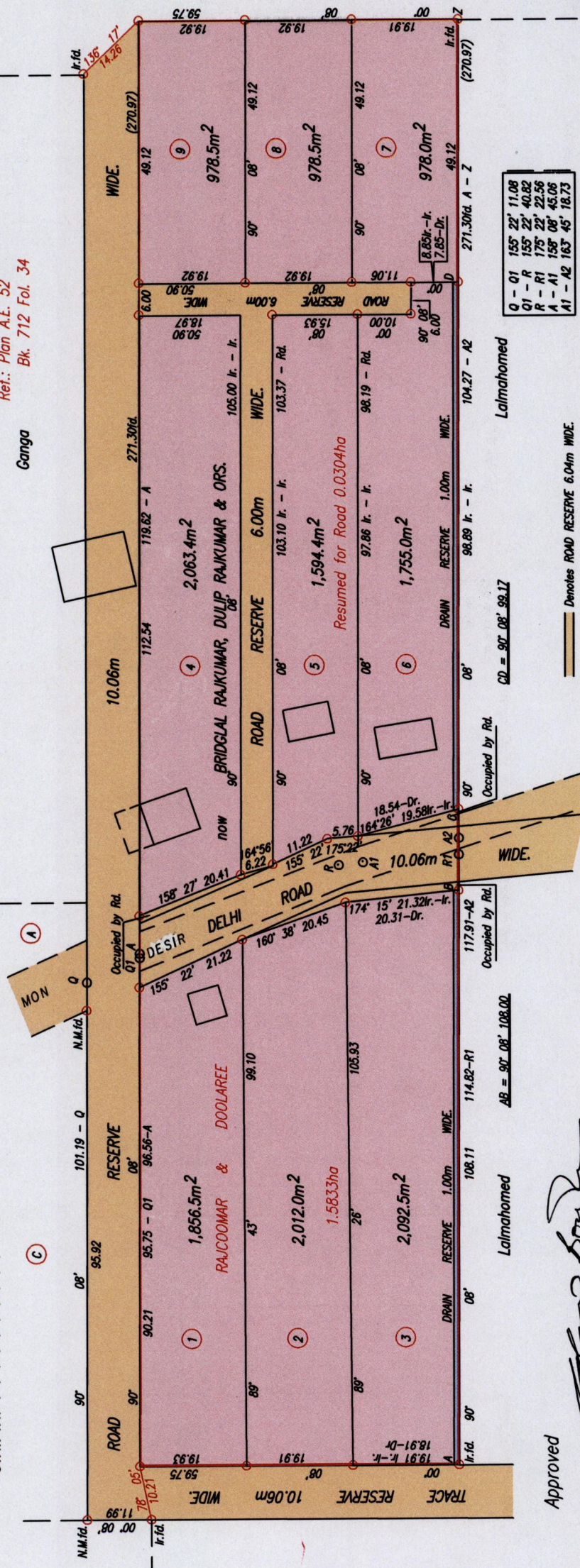
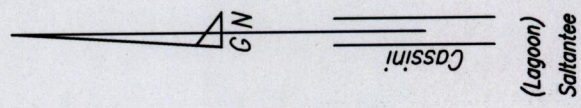

Q - Q1	155° 22' 11.08
Q1 - R	155° 22' 40.82
R - R1	175° 22' 22.56
A - A1	155° 08' 45.06
A1 - A2	163° 45' 18.73

Note: Line Q-Q1 & Q1-R1 represents Center Line of MON, DELHI ROAD 10.06m WIDE.
Line A-A1 & A1-A2 represents Center Line of ROAD RESERVE 6.04m WIDE.



SCALE 1:1000
Distances are in metres

○ Denotes Iron put except otherwise stated
Bearings are Cassini Grid based on Solar Observations

Approved
Director of Surveys 2012.5.31

Plan of 9 Parcels of land coloured pink in the Ward of Siparia
Containing together fourteen thousand, three hundred and eight point eight square metres.
Surveyed by me, with due authority, on 13th. & 15th. July, 1994
In accordance with Regulation 25 (1) of the Land Surveyors' Regulations 1998,
I certify that this plan is correct.

Ganeshdath Ramcharitar

Entered on
Checked by *mm 4/5/2012* Trinidad & Tobago Land Surveyor 2012
13/4



1433/62