

PROCESS ID # 50534
RPO Vol. 104 Fol. 561
CT. Vol. 1701 Fol. 345

Ward of Siparia
County of St.Patrick
Cadastral Sheet (G.18.B&F.), 53E
1/C

Coordinates

Ir.f.d. A :N 1120090
E 669802

Error Statement : ±4m

Datum Definition : U.T.M. Zone 20 Naparima

Source : Magellan Hand Held GPS

Parcel Address: Philip Trace

Penal Rock Road

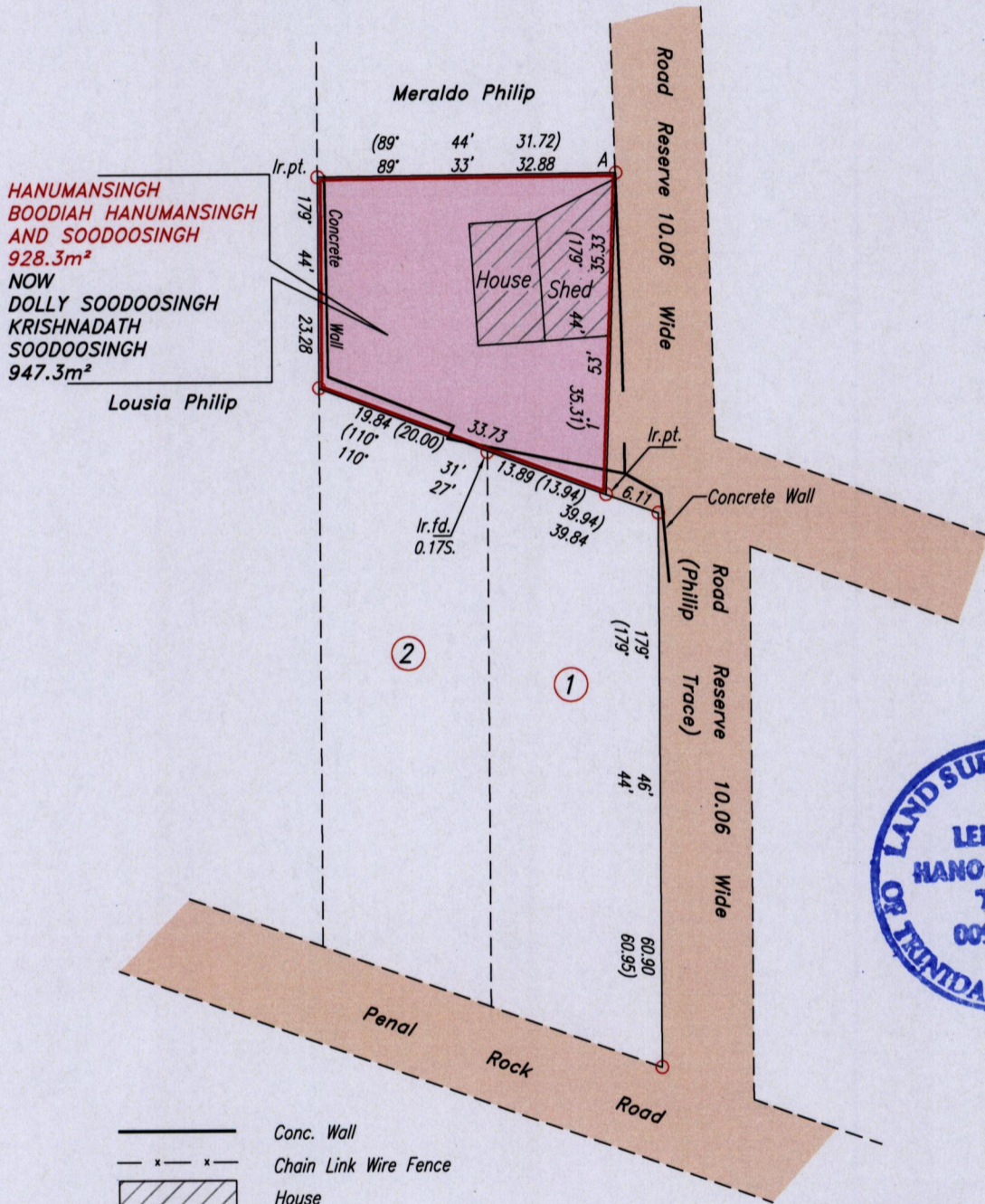

Approved *[Signature]*
Director of Surveys 2012-6-29

Ref: Bk. 985 fol 46
Bk. 966 fol 81
SCALE 1:750

○ Denotes Iron found except otherwise stated.

Note: Bearings are U.T.M. grid based on solar observations. Distances are in metres.

Plan of a Parcel of land coloured pink in the Ward of St.Patrick

Containing nine hundred and forty seven point three square metres.

Surveyed by me, with due authority, in February 2012

In accordance with Regulation 25(1) of the Land Surveyors' Regulations 1998, I certify that this plan is correct.

Checked by *[Signature]* 27/6/2012

Entered *[Signature]* 04-08-2012

[Signature]
Trinidad & Tobago Land Surveyor 21/06/2012.

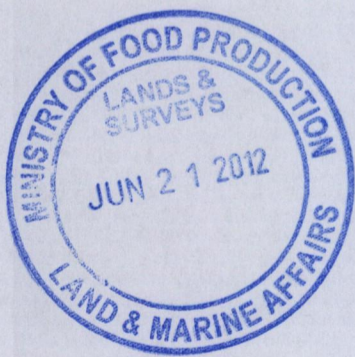

1433/59