

R.P.O. Vol. 21 Fol. 607
C.T. Vol. 1782 Fol. 137

REMAINING PORTION PLAN

Ward of Savana Grande
County of Victoria
Cadastral Sheet D.24.N. 54 B
4/a

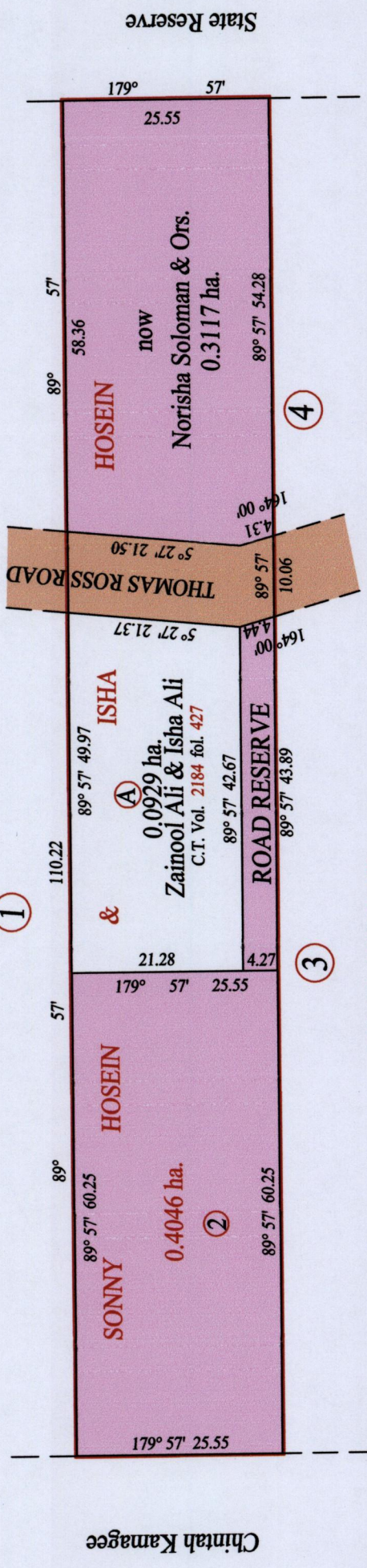
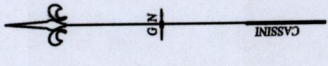
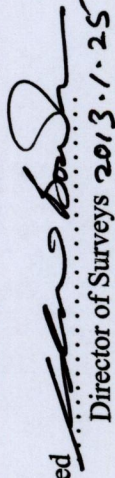

Approved 
Director of Surveys 2013.1.25

Vide Bk. 999 fol.157

SCALE : 1:750

Note: Bearings are cassini grid based on solar observations Distances are in metres
This is a true copy of a diagram of point four zero four six of a hectare, originally transferred to Sonny Hosein and Isha Hosein, showing a portion coloured pink and containing point three one one seven of a hectare being the remainder after one (1) previous transfer of another portion of the land. In accordance with Regulation 25 (1) of the Land Surveyors' Regulations 1998, I certify that this plan is correct.

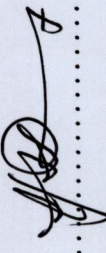
Checked by  24/1/12

Entered on Trinidad & Tobago Land Surveyor 16/11/2012



