

PROCESS ID # 58904

R.P.O. Vol. 39 Fol. 635

C.T. Vol. 4857 Fol. 519

U.P.R.N. No. : .....

Cadastral Sheet 62F G.11.B

1/b & 2/a

Ward of La Brea

County of St. Patrick

Original Survey in Bk. 711 Fol. 244

Coordinates are WGS84 Datum ± 5m  
F - 655,020mE 1,127,283mN

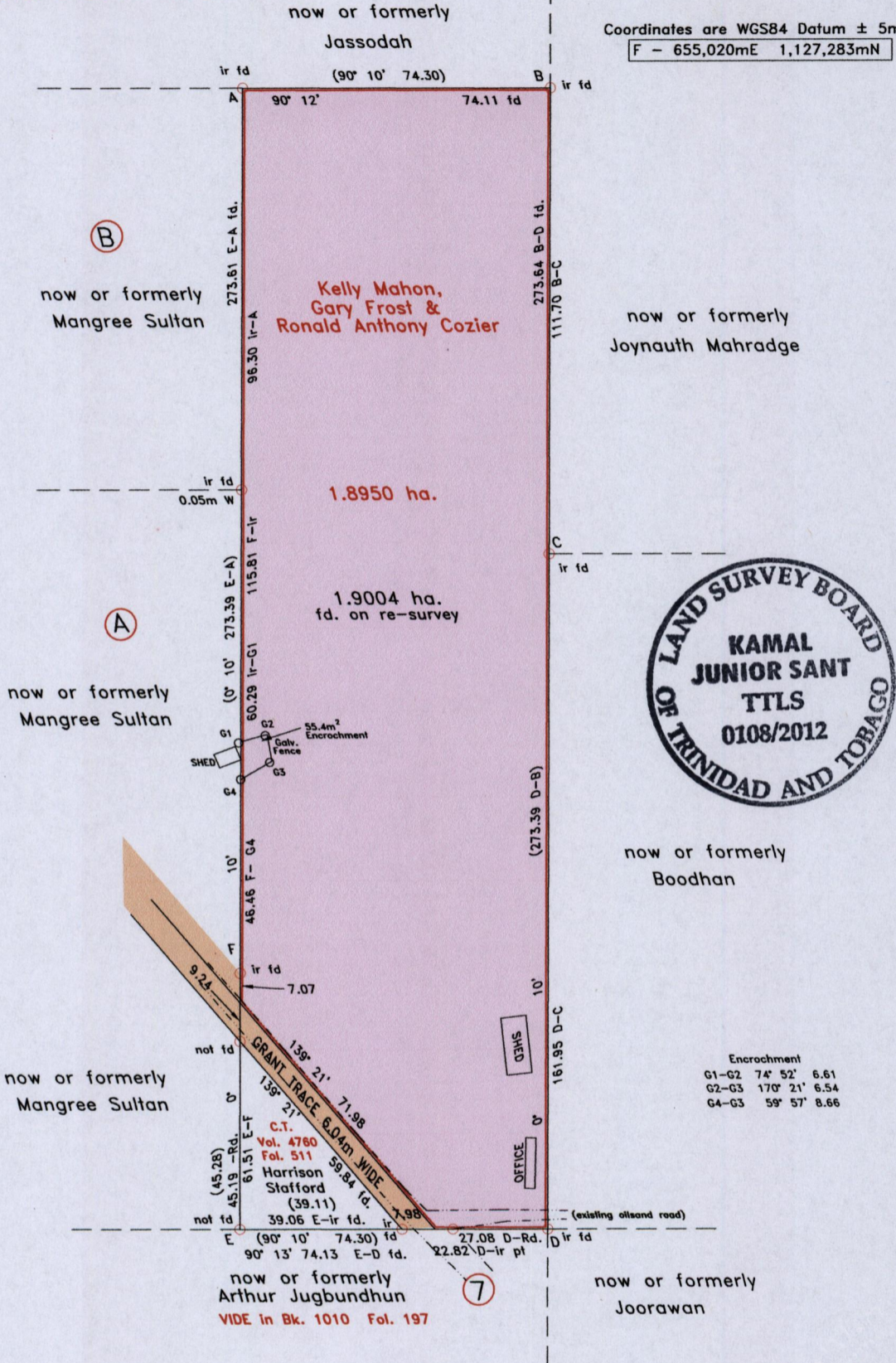
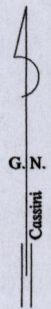

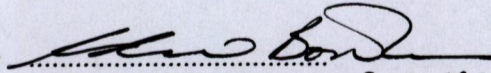
Approved by   
Director of Surveys 2013.1.14

Scale 1 : 1,500  
Distances are in metres

○ Denotes iron put unless otherwise stated  
Bearings are Cassini grid based on solar observations.  
Coordinates are WGS84 Datum, UTM Zone 20N projection based handheld GPS.  
PLAN of a parcel of land coloured pink in the Ward of La Brea.  
Containing one point nine zero zero four hectares.  
Surveyed by me with due authority, on 25th August, 2012.  
In accordance with Regulation 25(1) of the Land Surveyors' Regulations 1998,  
I certify that this plan is correct.

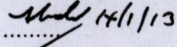
Checked by   
Entered on .....

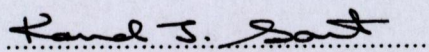

Trinidad & Tobago Land Surveyor 21st September, 2012.

275 82  
914 7284  
447 469 775 28 75 10000 10000

ROYAL CANADIAN MOUNTED POLICE  
POLICE MONTÉE ROYALE

10000 10000

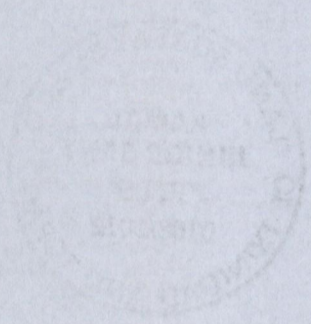

*Handwritten signature or text*

*Handwritten text*

1433 / 194