

1433

1899

R.P.O. Vol. 207 fol. 21
C.T. Vol. 3316 fol. 413
PROCESS ID # 57343

Ward of Siparia
County of St. Patrick
Cadastral Sheet G.14.F 64.D.
1/d

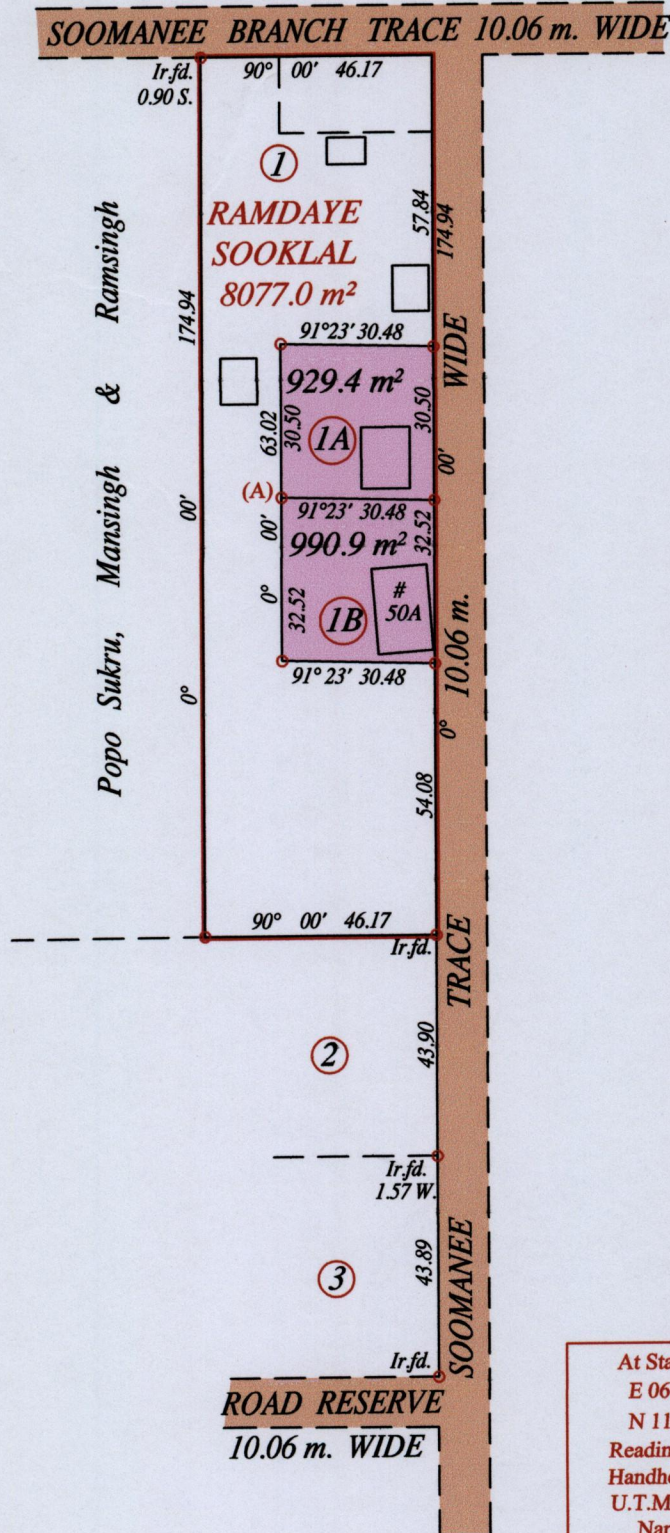

At Station (A)
E 0674613
N 1143765
Reading taken with
Handheld G.P.S.
U.T.M. Zone 20
Naparima
+ 5 m.

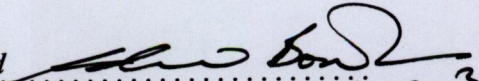
Approved 
Director of Surveys 2012.12.3

Vide Bk. 1017 fol. 49

o Denotes Iron put except stated otherwise. SCALE : 1:1500
Note: Bearings are cassini grid based on solar observations Distances are in metres
PLAN of 2 Parcels of land coloured pink in the Ward of Siparia
Containing together one thousand nine hundred and twenty point three square metres
Surveyed by me, with due authority, in April 2009
In accordance with Regulation 25 (1) of the Land Surveyors' Regulations 1998,
I certify that this plan is correct.

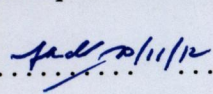
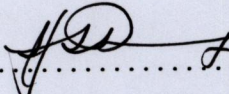
Checked by  

Entered on Trinidad & Tobago Land Surveyor 17.10.2012

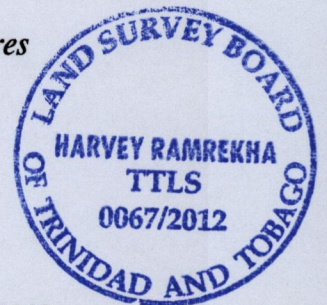



1433/189