

1433/1433

1330

35C
Cadastral Sheet 1/b E.2.1.
Ward of Turure
County of St. Andrew

VESTING ORDER

Process ID # 48771
R.P.O. Vol. 148 Fol. 52
Original Bk.184 Fol.305

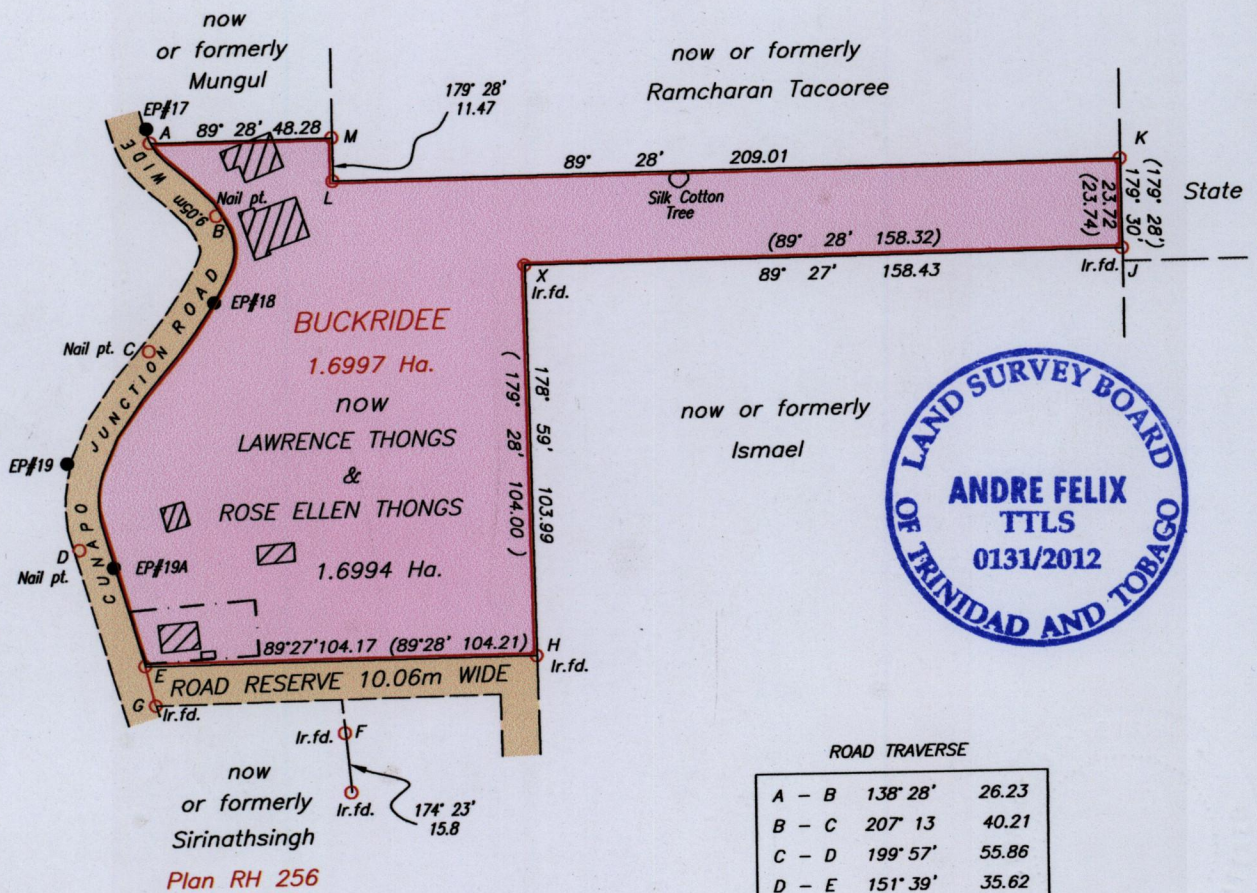
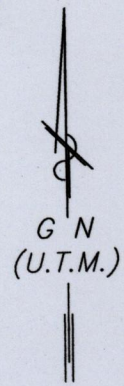

E = N 1165871
E 703858 +/- 3.0m

X = N 1165976
E 703961 +/- 3.0m

UTM Naparima 1955 Datum Zone 20
Hand Held GPS

- ==== Denotes Drain
- - - - Denotes Fence
- ▨ Denotes Building
- EP Electricity Pole

Approved 2013.1.10
Director of Surveys

○ Denotes Iron put unless otherwise stated
Bearings are U.T.M. Grid based on Solar observations

SCALE 1:2000
Distances are in METRES

PLAN of a Parcel of land coloured pink in the Ward of Turure
Containing one point six nine nine four hectares
Surveyed by me, with due authority, in December 2011 for Lucy Thongs
In accordance with Regulation 25 (1) of the Land Surveyors' Regulations 1998,
I certify that this Plan is correct.

Checked by 20/10/12 T.T.L.S.
Entered on 22.02.2013 11th October, 2012.
Trinidad & Tobago Land Surveyor

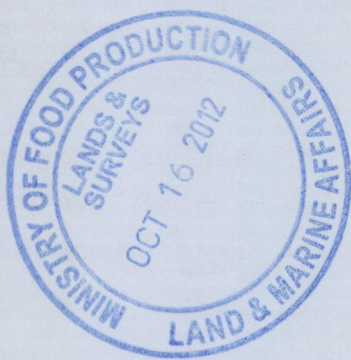

1433/180