

R.P.O. Vol. Fol.
C.T. Vol. 5000 Fol. 103
Process Id# 54681

Ward of Naparima
County of Victoria
Cadastral Sheet G 8 N, 63 C.
G 13 B
3c

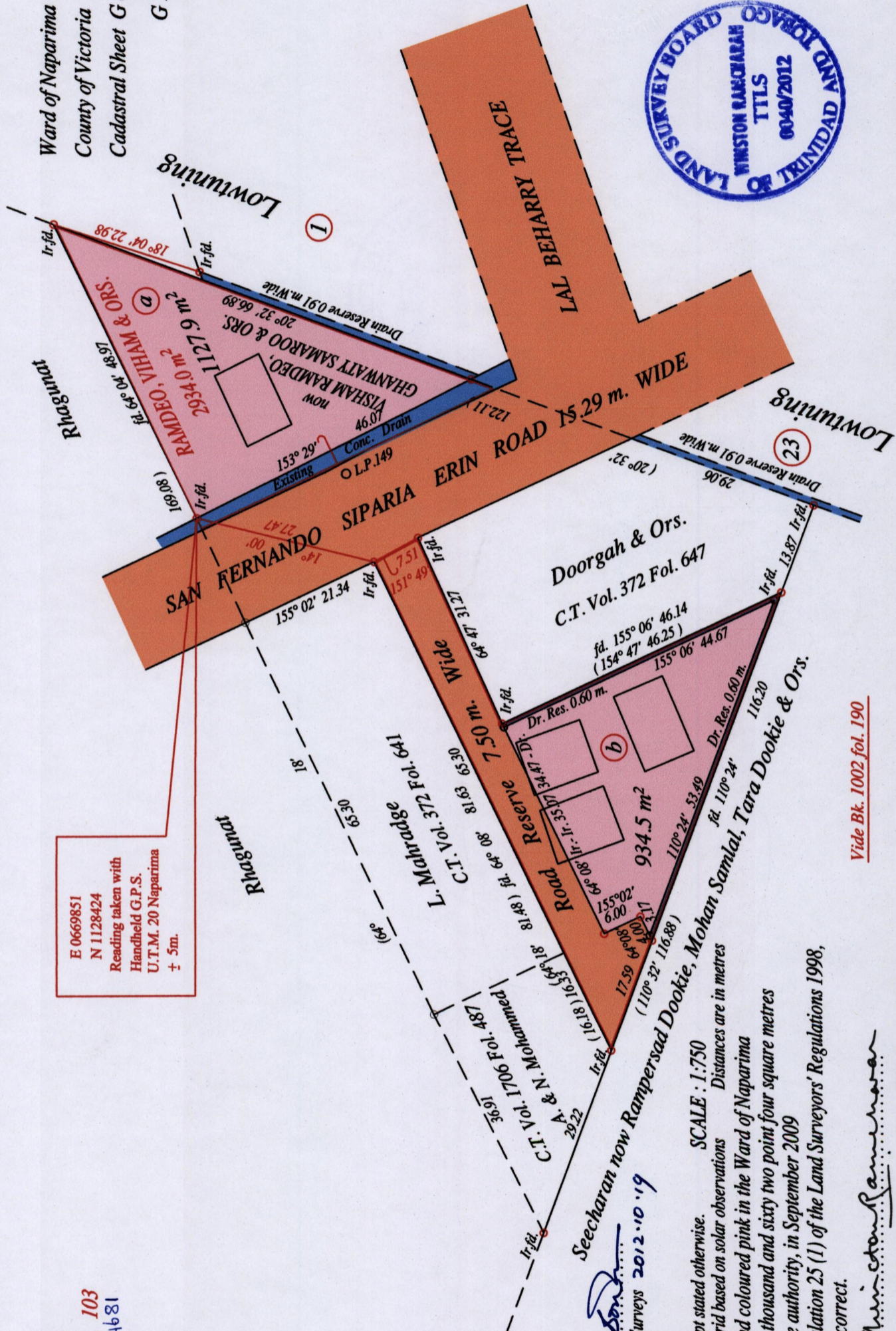

E 0669851
N 1128424
Reading taken with
Handheld G.P.S.
U.T.M. 20 Naparima
± 5m.

Approved *[Signature]*
Director of Surveys 2012.10.19

o Denotes no mark put.
o Denotes Iron put except stated otherwise.
Note: Bearings are cassini grid based on solar observations Distances are in metres
PLAN of 2 Parcels of land coloured pink in the Ward of Naparima
Containing together two thousand and sixty two point four square metres
Surveyed by me, with due authority, in September 2009
In accordance with Regulation 25 (1) of the Land Surveyors' Regulations 1998,
I certify that this plan is correct.

Checked by *[Signature]*

Entered on Trinidad & Tobago Land Surveyor 26th September 2012

Vide Bk. 1002 fol. 190

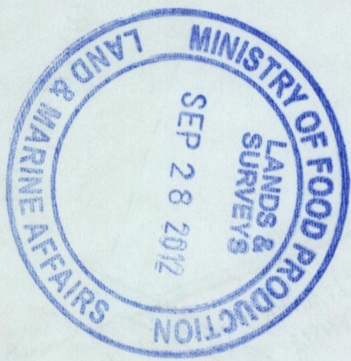

Handwritten notes in the top right corner, including 'C/131' and 'C/132'.



1432/137