

1427

U.P.R.N. No.....

R.P.O. No. 54 Fol. 1

C.T. Vol. 1384 Fol. 541

G. N.

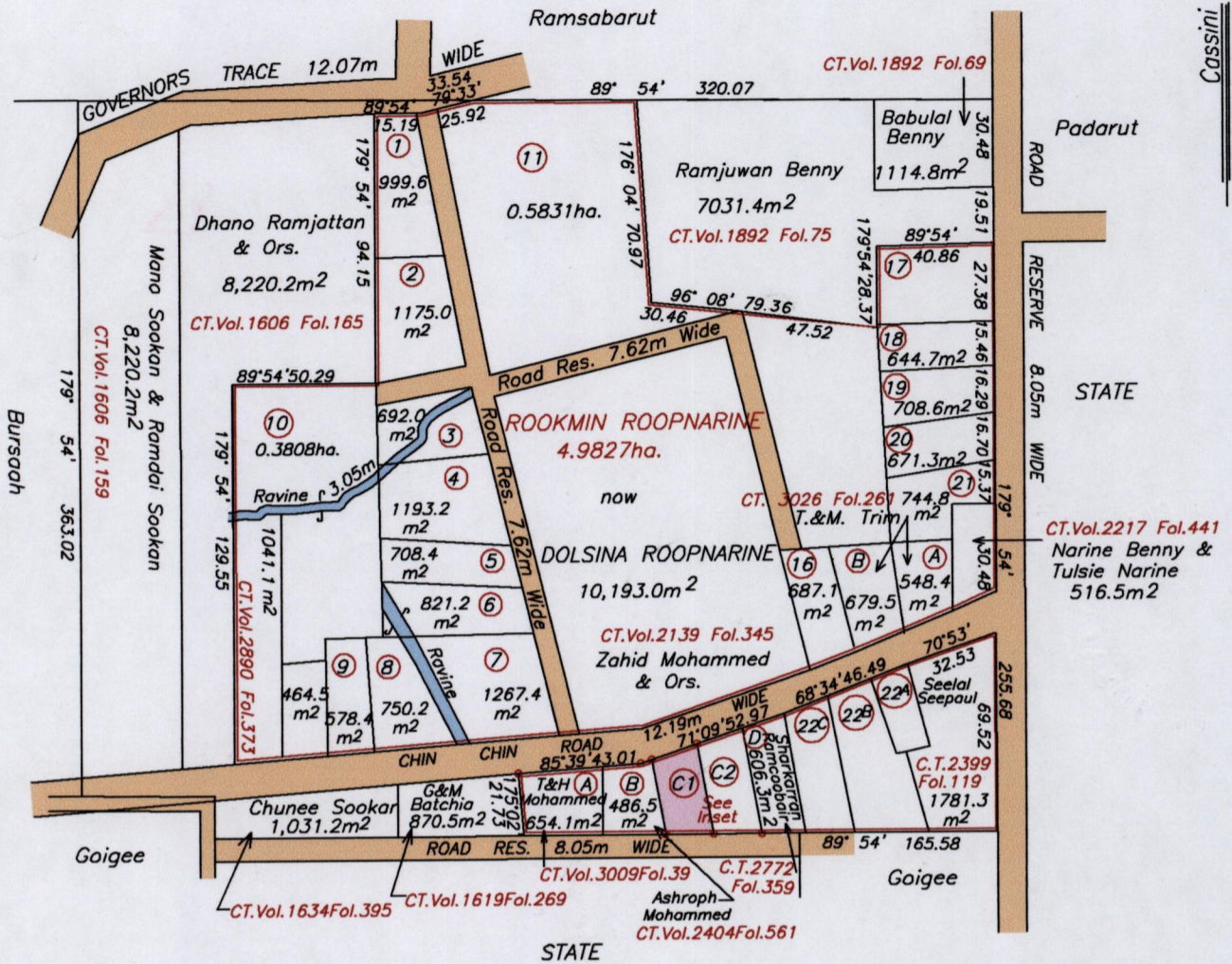

INSET

Lot	Area	C.T.Val.	Fol.	
21	744.8m ²	3337	367	Tahir Chadee
9	578.4m ²	3494	407	Margaret Badal
1	999.6m ²	3507	71	Jagroop Jattan
2	1175.0m ²	3507	71	Jagroop Jattan
8	750.2m ²	4729	325	Harrypersad Shamkarran & Stacy Shamkarran
22C	761.7m ²	4877	235	Hutchinson Oliver
17	1115.1m ²	4912	367	Vernon Jhangroo & Paramdai Jhangroo
C2	557.4m ²	3796	61	Charles Irving Maloney
3	692.0m ²	4478	17	Clement Guillaume, Sarah Guillaume & Henry Best

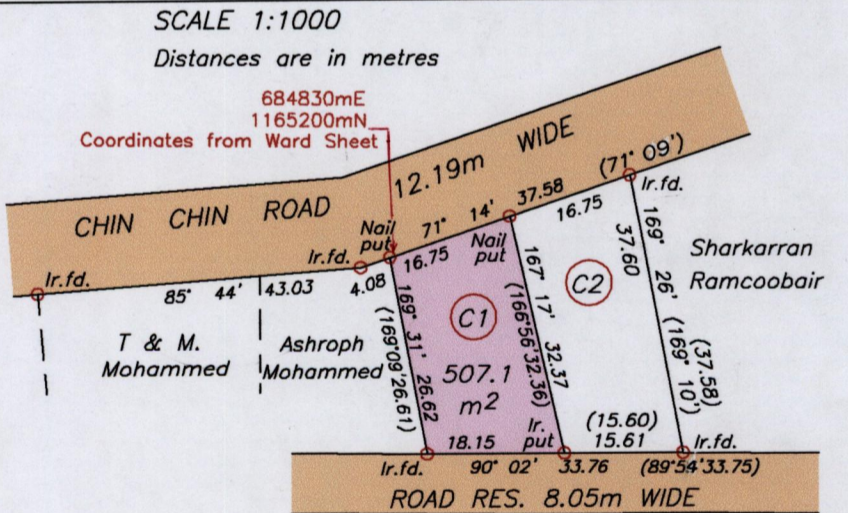

Approved.....
 Director of Surveys

Bearings are Cassini Grid based on Solar Observations.

Plan of a Parcel of land coloured pink in the Ward of Cunupia
 Containing five hundred and seven point one square metres

Surveyed by me, with due authority in September 2007

In accordance with regulation 25 (1) of the Land Surveyors' Regulations 1998,

I certify that this plan is correct.

Checked by.....

Entered on.....

Trinidad and Tobago Land Surveyor..... 11th August..... 2008

SCALE 1/ 2500

Distances are in metres

