

1427

633

R.P.O. Vol. 152 Fol. 241
C.T. Vol. 2174 Fol. 295
(Second Parcel - Plots 16A & 16 B)
U.P.I.N. No.:.....

Cadastral Sheet 73C (G.19.A.&E.)
2/b
County of St. Patrick
Ward of Siparia

Address: Rd. Res. Off Seebalack Trace, Penal.

LEGEND			
A	674,385mE	1,120,850mN	±5m

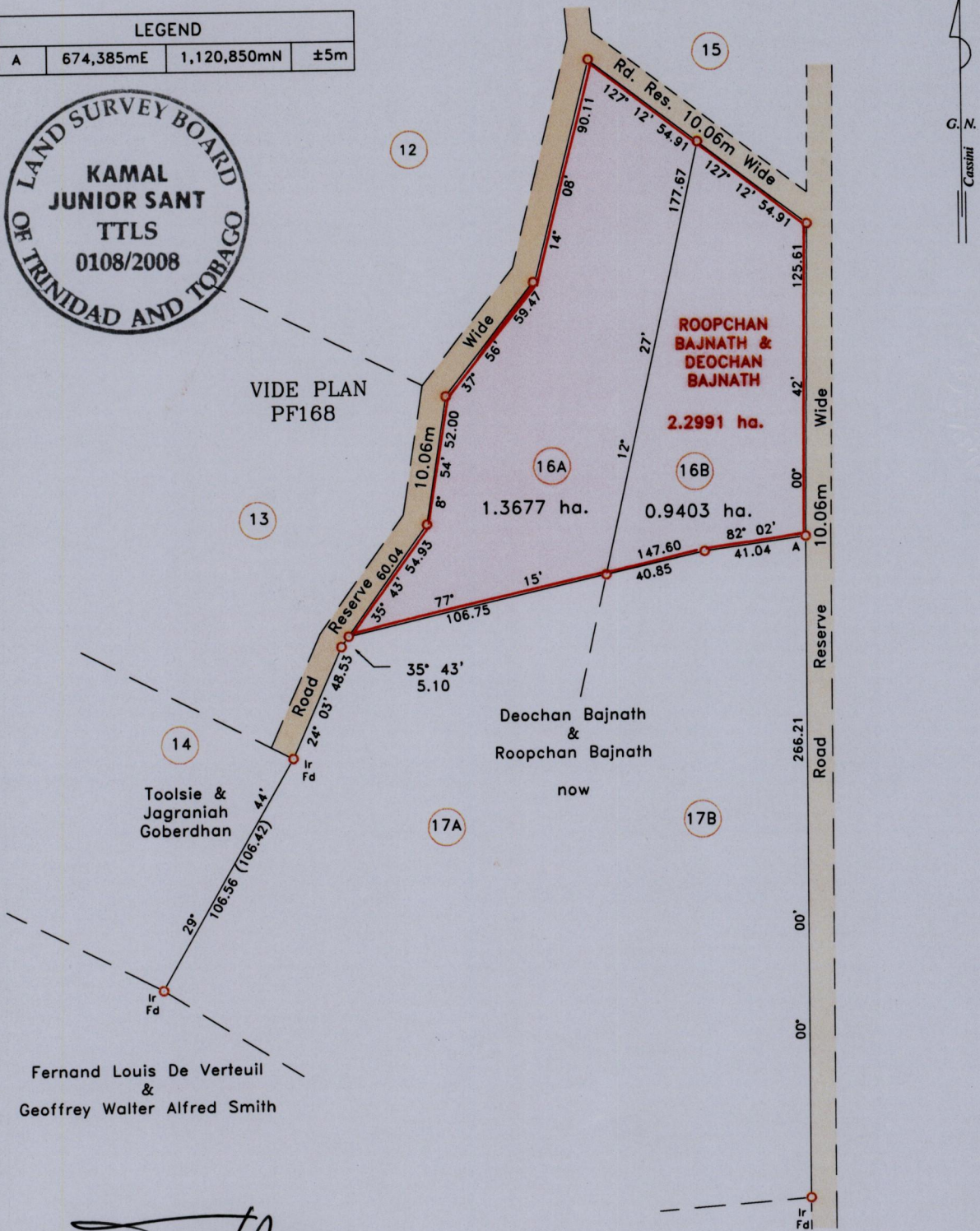
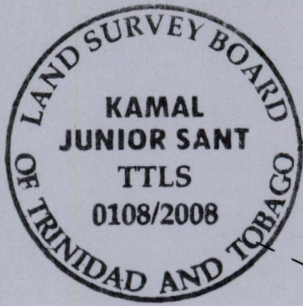

Fernand Louis De Verteuil & Geoffrey Walter Alfred Smith

Approved *[Signature]*
Director of Surveys
2008 10 02

NOTE:
Parcel 16A and 17A to be amalgamated
Parcel 16B and 17B to be amalgamated

Scale 1 : 2,500

Distances are in metres
 ○ Denotes iron put except where otherwise stated
 Bearings are Cassini Grid based on Solar Observations.
 Coordinates are Naparima Datum, UTM Zone 20 and based on direct handheld GPS observations.
 Plan of two parcels of land coloured pink in the Ward of Siparia
 Containing together Two point Three Zero Eight Zero hectares.
 Surveyed by me with due authority in June 2006.
 In accordance with Regulation 25(1) of the Land Surveyors' Regulation 1998,
 I certify that this plan is correct.

Checked by *[Signature]*
Entered by

Trinidad & Tobago Land Surveyor *[Signature]*, 2008.