

1427

56

R.P.O Vol 258 Fol 395
C. T. Vol 2843 Fol 41
C.T. Vol 5547 Fol 385.

Cadastral Sheet $\frac{1J}{1/b \& 1/d}$ & $\frac{1E}{6/b}$ (I 21. B & C)
Ward of Tobago
Parish of St. Patrick

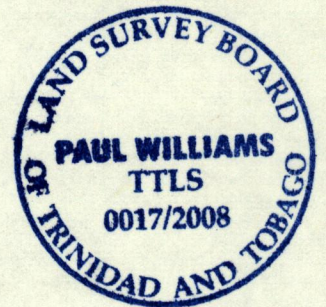
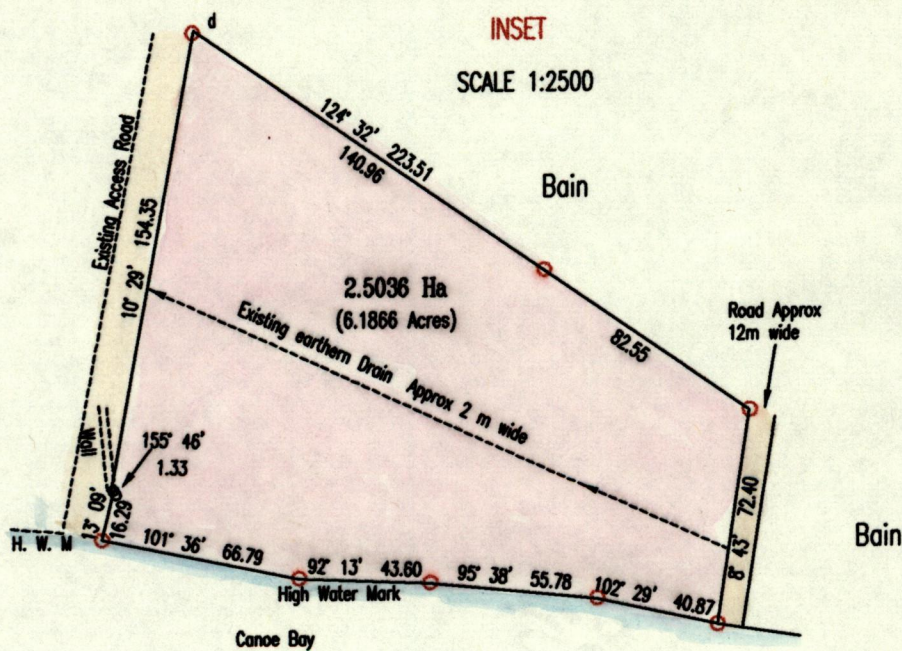
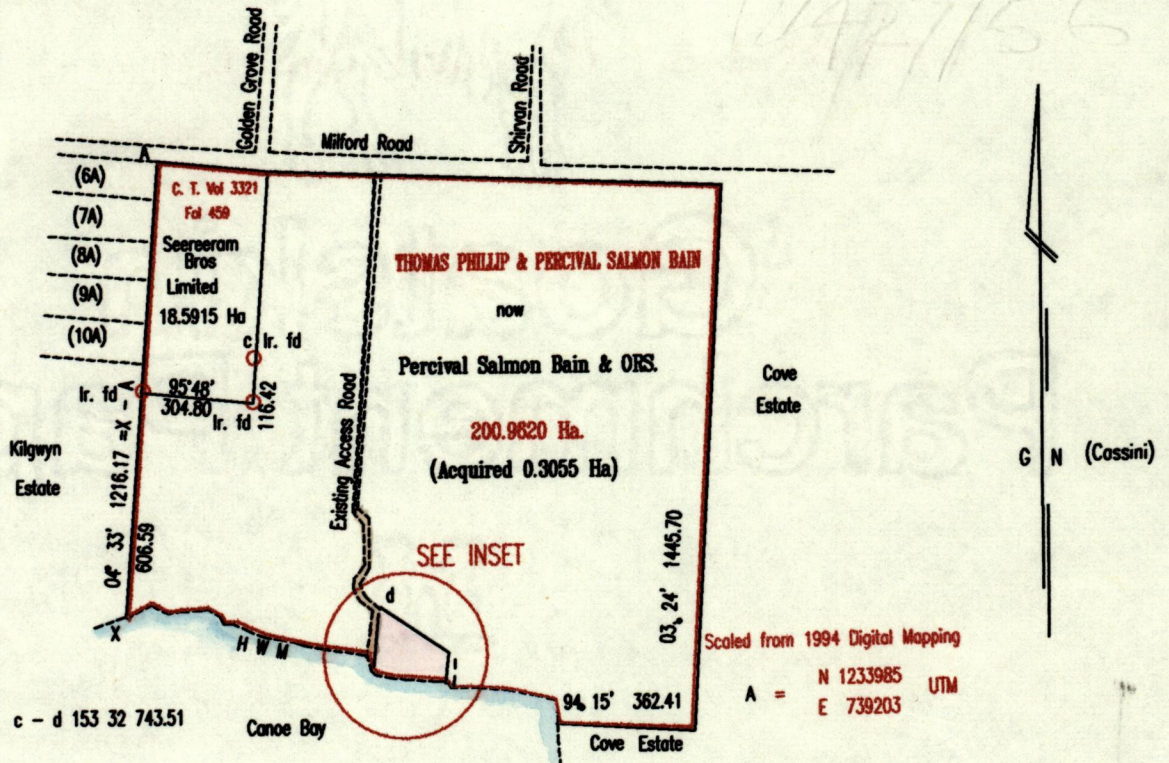

Approved *[Signature]*
Director of Surveys
2008.9.28

References
Plan PE 220
S.O. No. 51/62
Plan JA 117
Plan PG 57

○ Denotes No mk.put

○ Denotes Iron Put unless otherwise stated

Bearings are Cassini Grid based on Solar Obs.

SCALE 1:20,000
Distances are in Metres

Plan of a Parcel of land coloured pink in the Ward of Ward Tobago
Containing two point five zero three six hectares
Surveyed by me, with due authority, in July 1990

In accordance with Regulation 25(1) of the Land Surveyors' Regulations 1998, I certify that this plan is correct.

Checked by *[Signature]* 26/09/08

[Signature]

Entered on

Trinidad & Tobago Land Surveyor. *[Signature]* September 04 2008

Lot #	C.T. Vol & Folio	Names.
	5547 Pol 393	Michael Small.



1427/56