

R.P.O. Vol. 150 Fol. 117
 C.I. Vol. 424 Fol. 325
 Vide Bk. 1148 fol 47
 " 1163 fol. 37
 Original BK filed in Bk. 716 fol. 322

Cadastral Sheet G.12.H. 63E
 Ward of Siparia
 County of St. Patrick.
San Francisco Penel

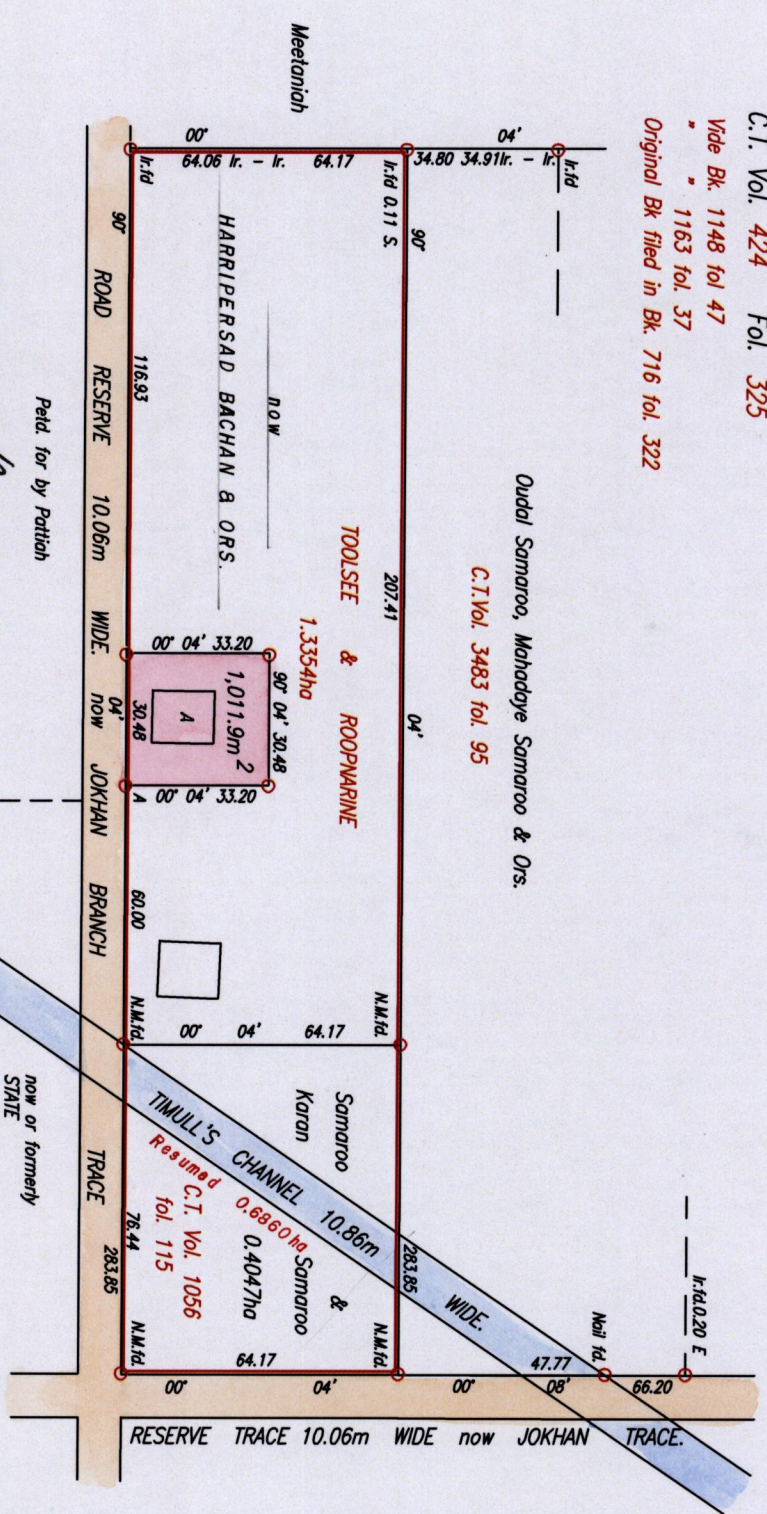

Approved
[Signature]
 Director of Surveys

PLAN of a Parcel of land coloured pink in the Ward of Siparia
 Containing one thousand and eleven point nine square metres.
 Surveyed by me, with due authority, in July, 2007
 In accordance with Regulation 25 (1) of the Land Surveyors' Regulations 1998,
 I certify that this plan is correct.

Checked by: *[Signature]*

[Signature]

Entered on: ... Trinidad & Tobago Land Surveyor. ... 23rd April ... 2008.

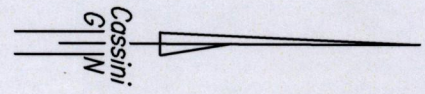

Ir. put A 666092mE, 1125598mN.
 (U.T.M. 20, Naporima (+/-6m))

SCALE 1:1750

Distances are in metres
 Denotes Iron put except where otherwise stated
 Bearings are based on Solar Observations

