

1427 12/7/2008

2033

R. P. O. Vol. 262 fol. 635
 C. T. Vol. 2951 fol. 5
 Bk. 425 fol. 81
 Bk. 754 fol. 54

Ward of Siparia
 County of St. Patrick
 Cadastral Sheet (G. 13. P.) 63 F
 4/d

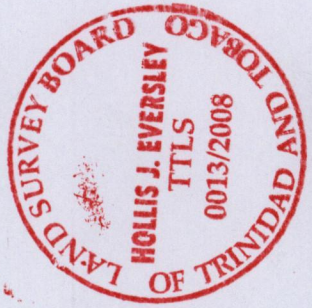
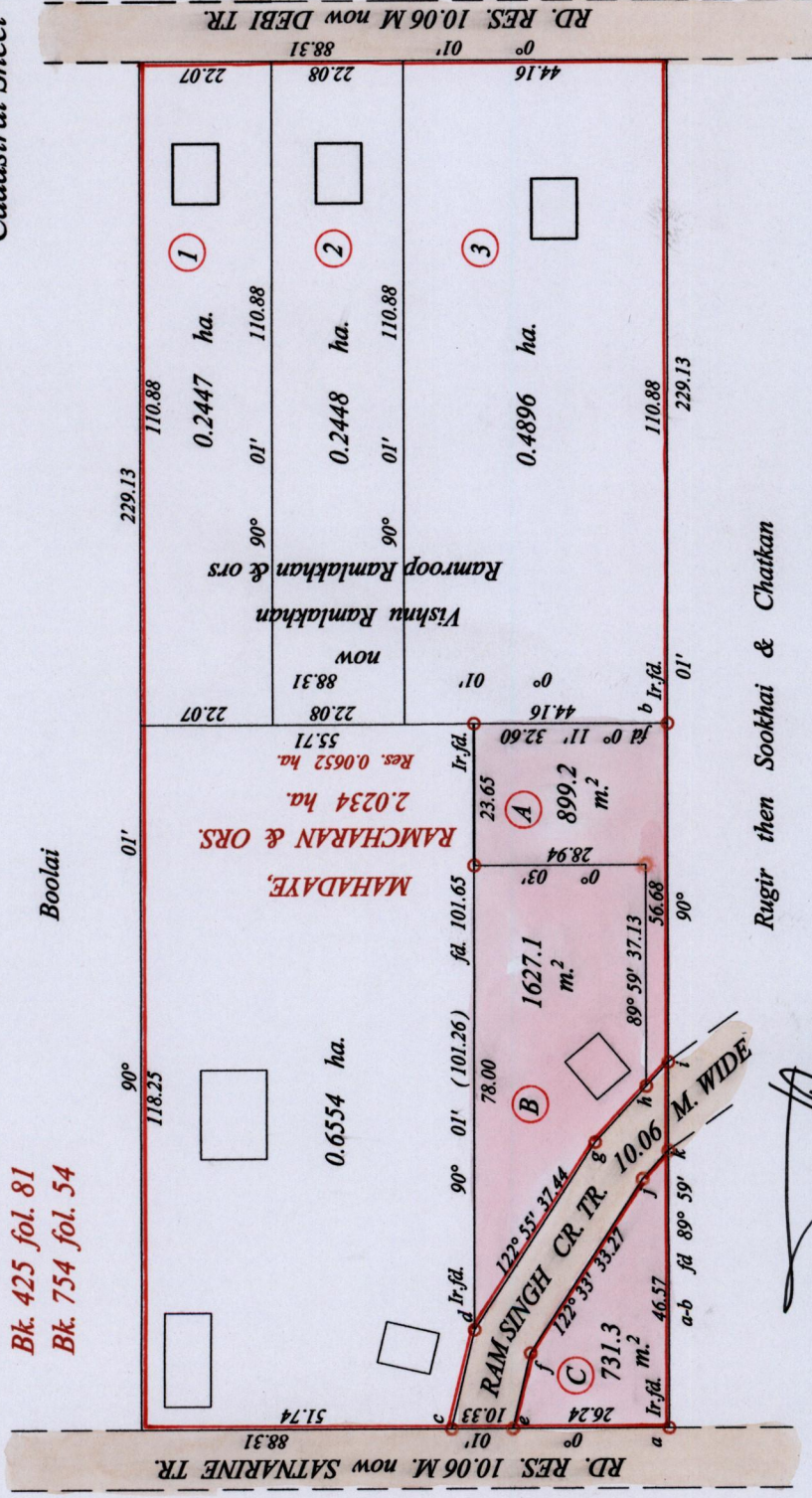

b = N. 1122342 E. 732773

STA.	BEARING	DIST.
c-d	103° 10'	17.75
e-f	103° 03'	12.95
g-h	132° 29'	12.77
h-i	132° 29'	5.45
j-k	132° 29'	8.00
k-i	89° 59'	14.59

a = N. 1122342 E. 732655
 U.T.M. Zone 20 Naparima
 Hand Held G.P.S.

SCALE 1 : 1250

Approved
 Director of Surveys.

2009.1.26

Bearings are Cassini Grid based on Solar Observations Distances are in Metres
 PLAN of 3 Parcels of land coloured pink in the Ward of Siparia
 Containing together three thousand two hundred and fifty seven point six sq metres.
 Surveyed by me, with due authority in, October 2007
 In accordance with Regulation 25 (1) of the Land Surveyor's Regulations 1998,
 I certify that this plan is correct.

[Signature]

Checked by R.S. 15/01/09

Entered on..... Trinidad & Tobago Land Surveyor .. Dr. S. Dewdas 2008

○ Denotes Iron Put Except Stated Otherwise