

1427 7/193

193

R. P. O. Vol. 149 fol. 319
C. T. Vol. 3900 fol. 221

Ward of Naparima
County of Victoria
Cadastral Sheet G. 13. G. $\frac{63 F.}{1/d}$

Bk. 1238 fol. 32

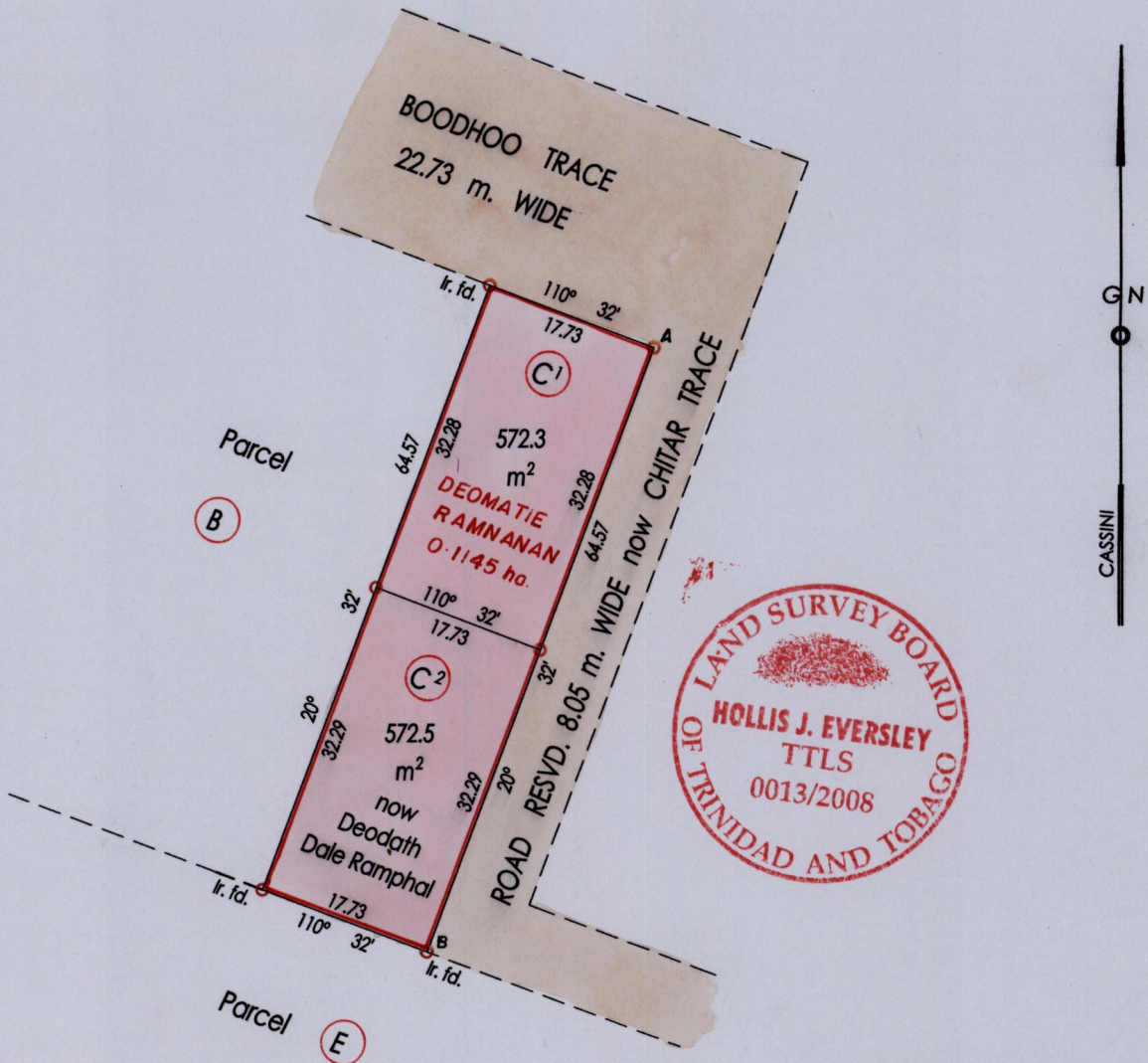

B = N. 1125926 E. 671319

A = N. 1125986 E. 671342
U.T.M. ZONE 20 Naparima
Hand Held G.P.S.

○ Denotes Iron Put Except Stated Otherwise

SCALE 1 : 750

Approved *[Signature]*
Director of Surveys
2009.1.14

Bearings are Cassini Grid based on Solar Observations Distances are in Metres
PLAN of 2 Parcels of land coloured pink in the Ward of Naparima
Containing together one thousand one hundred and forty four point eight sq. metres
Surveyed by me, with due authority in, Dec. 2007
In accordance with Regulation 25 (1) of the Land Surveyors' Regulations 1998,
I certify that this plan is correct.

Checked by *HR-13/01/09*

Entered on..... Trinidad & Tobago Land Surveyor *[Signature]* 22nd Dec 2008