

1427

190

R.P.O. Vol. 122 Fol. 329
C.T. Vol. 1558 Fol. 443

Ward of Naparima
County of Victoria
Cadastral Sheet (G.13.G) 63.F.
1/d

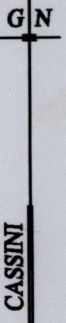

E 0671418
N 1125564
Reading taken with
Handheld G.P.S.
Garmin 76S
U.T.M. 20 Naparima

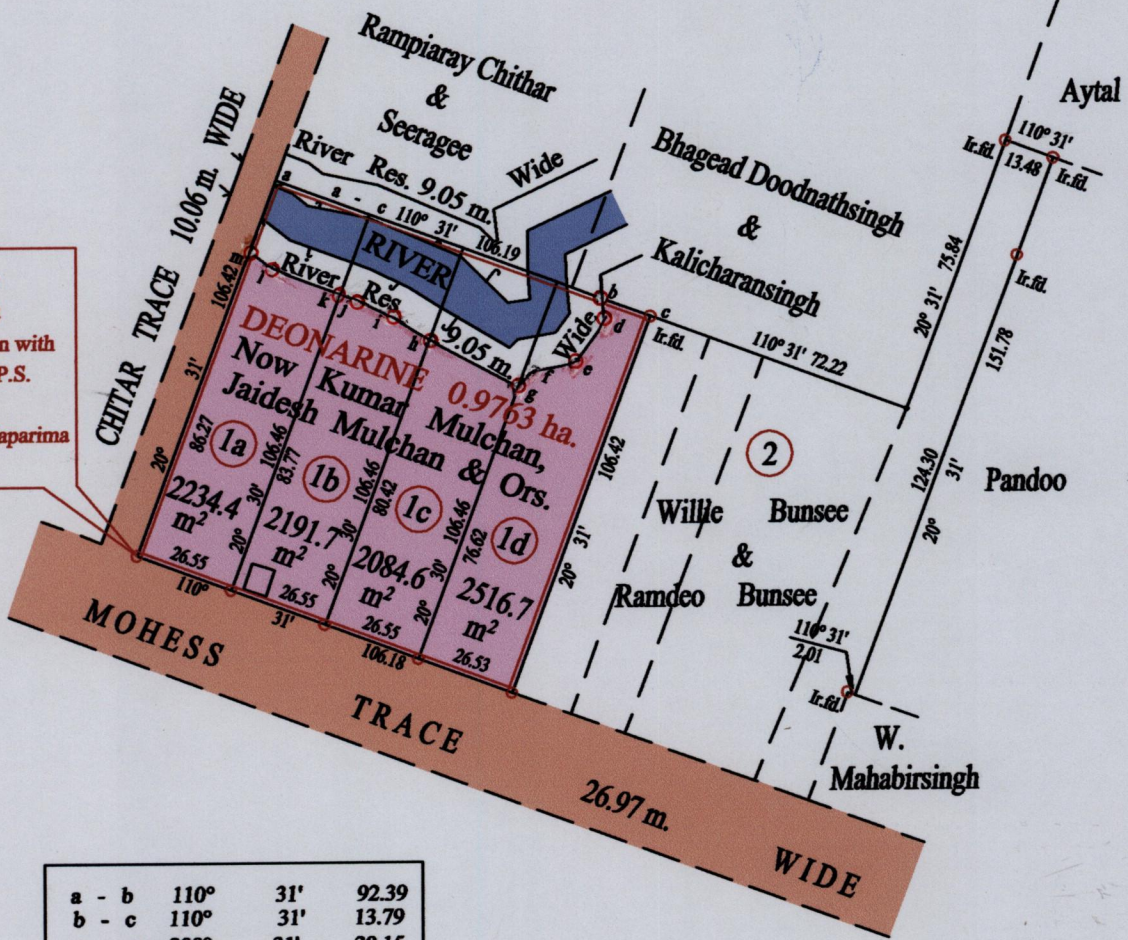

a - b	110°	31'	92.39
b - c	110°	31'	13.79
a - m	200°	31'	20.15
m - l	128°	55'	8.11
l - k	110°	20'	18.86
k - j	110°	20'	4.79
j - i	116°	20'	10.61
i - h	122°	08'	11.41
h - g	118°	39'	26.82
g - f	44°	59'	6.09
f - e	80°	25'	10.98
e - d	35°	55'	13.37
d - b	355°	03'	6.53

Approved *[Signature]*
Director of Surveys
2008.12.17

Vide Plan 948 fol. 146

o Denotes Iron put except stated otherwise.
Note: Bearings are cassini grid based on solar observations
Distances are in metres

PLAN of 4 Parcels of land coloured pink in the Ward of Naparima
Containing together nine thousand zero hundred and twenty seven point four square metres
Surveyed by me, with due authority, in May 2006
In accordance with Regulation 25 (1) of the Land Surveyors' Regulations 1998,
I certify that this plan is correct.

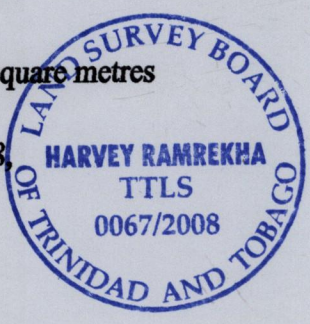

Checked by *[Signature]*

Entered on Trinidad & Tobago Land Surveyor 18.11.2008