

1427

170

R.P.O. 815 Vol. 191

C.T. Vol.

66E
Cadastral Sheet 4/b/2 (H.15.I.)

Ward of Guayaguayare
County of Mayaro

Parcel #27 "LA SAVANNE SETTLEMENT"

G N
Cassini

SEE FIELD NOTES AT BACK OF PLAN

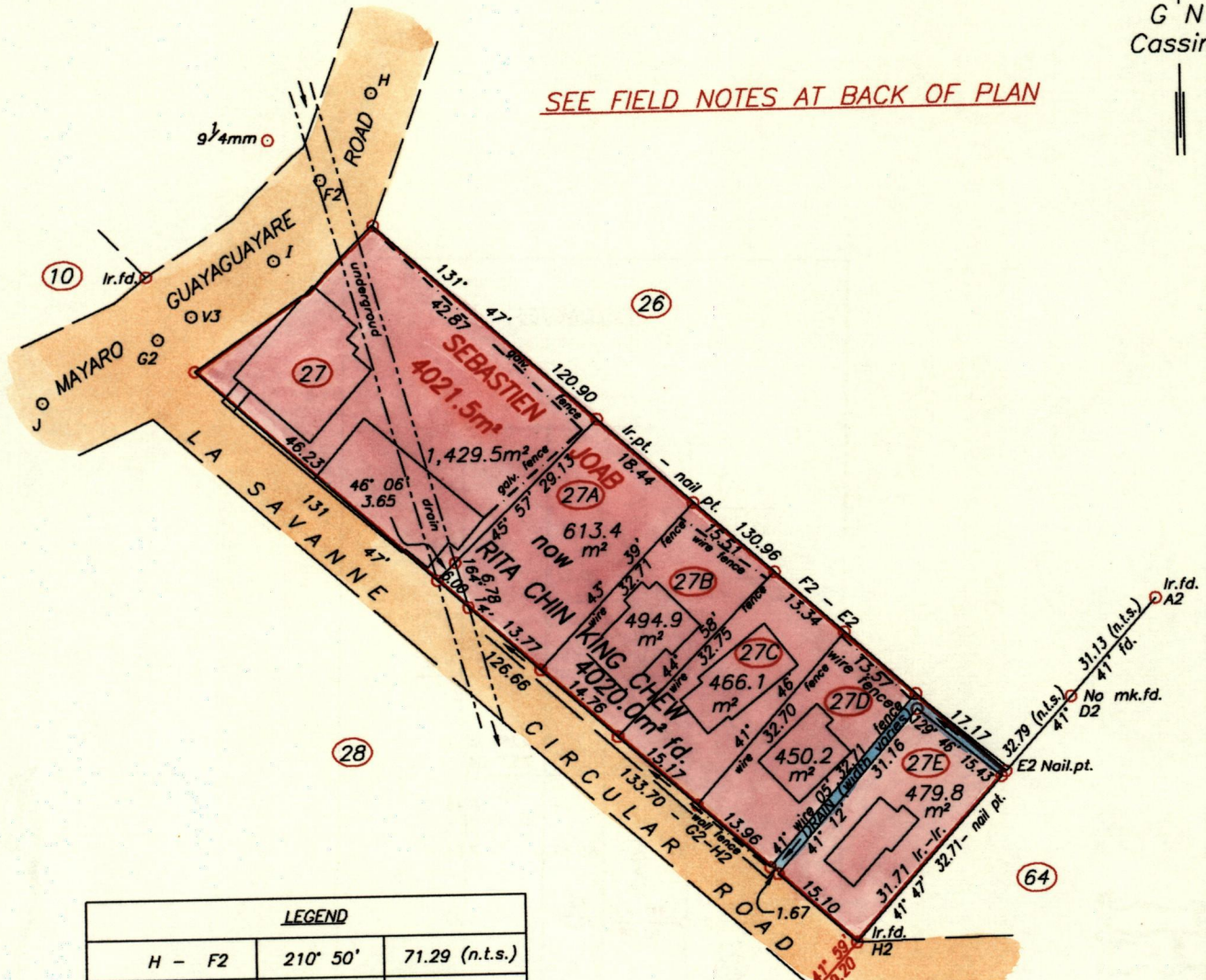

LEGEND		
H - F2	210° 50'	71.29 (n.t.s.)
F2 - Ir.pt.	131° 47'	10.06
F2 - I	210° 50'	13.44
I - G2	(237° 04' 236° 58' fd.	20.32 20.22 fd.
G2 - Ir.pt.	131° 47'	7.04
G2 - J	236° 58' fd.	158.38 (n.t.s.)
9 1/4mm - Ir.pt.	130° 10'	19.53

9 1/4mm = N 1124601 U.T.M. +/- 3.0m
E 718639
Coordinates are based on Hand held GPS W.G.A.84 Zone 20

Approved *[Signature]*
Director of Surveys
2008-12-08

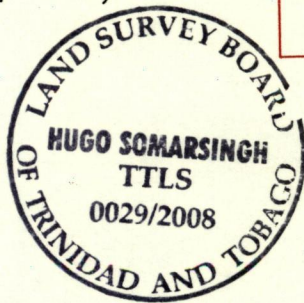

References
S.O. 57/34
PLAN K.D.17

SCALE 1:1000
Distances are in METRES

o Denotes Iron put unless otherwise stated
Bearings are Cassini Gridbased on Solar observations

PLAN of 6 Parcels of land coloured pink in the Ward of Guayaguayare
Containing together three thousand nine hundred and thirty three point nine square metres
Surveyed by me, with due authority, in September 1997
In accordance with Regulation 25 (1) of the Land Surveyors' Regulations 1998,
I certify that this Plan is correct.

Checked by *[Signature]*

Entered on

[Signature] T.T.L.S.
Trinidad & Tobago Land Surveyor 23rd October 2008

FIELDNOTES

