

R.P.O. Vol. 106 Fol. 113

C.T. Vol. 652 Fol. 119

Vide Bk.1053 Vol.2 Fol.624

Bk.459 Fol.139

Ward of La Brea

County of St. Patrick

Cadastral Sheet F.15. J.& K. 62E
3/6

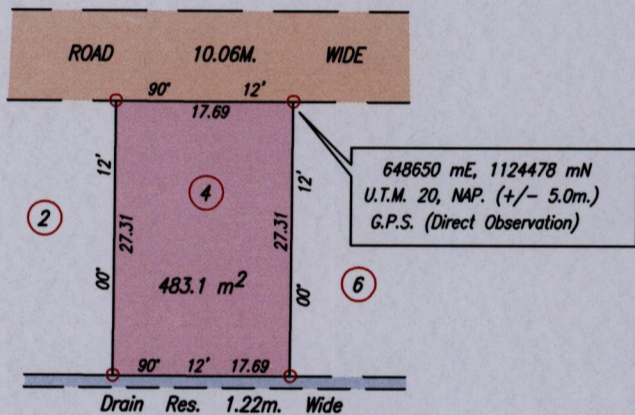

Alfred Blondell then
Shell Trinidad Limited



SCALE 1/750

Distances are in Metres.

Approved *[Signature]*
Director of Surveys
2008.11.7

o Denotes Iron found unless otherwise stated

Bearings are Cassini Grid based on solar Observations

PLAN of a Parcel of land coloured pink in the Ward of La Brea
Containing four hundred and eighty three point one square metres
Surveyed by me, with due authority, in May. 2008.

In accordance with Regulation 25 (1) of The Land Surveyors' Regulations 1998,
I certify that this plan is correct.

Checked by *[Signature]* *[Signature]*

Entered on Trinidad & Tobago Land Surveyor. 10/11/2008