

Parcel Address: #74 Cuchawan Trace West, Debe.

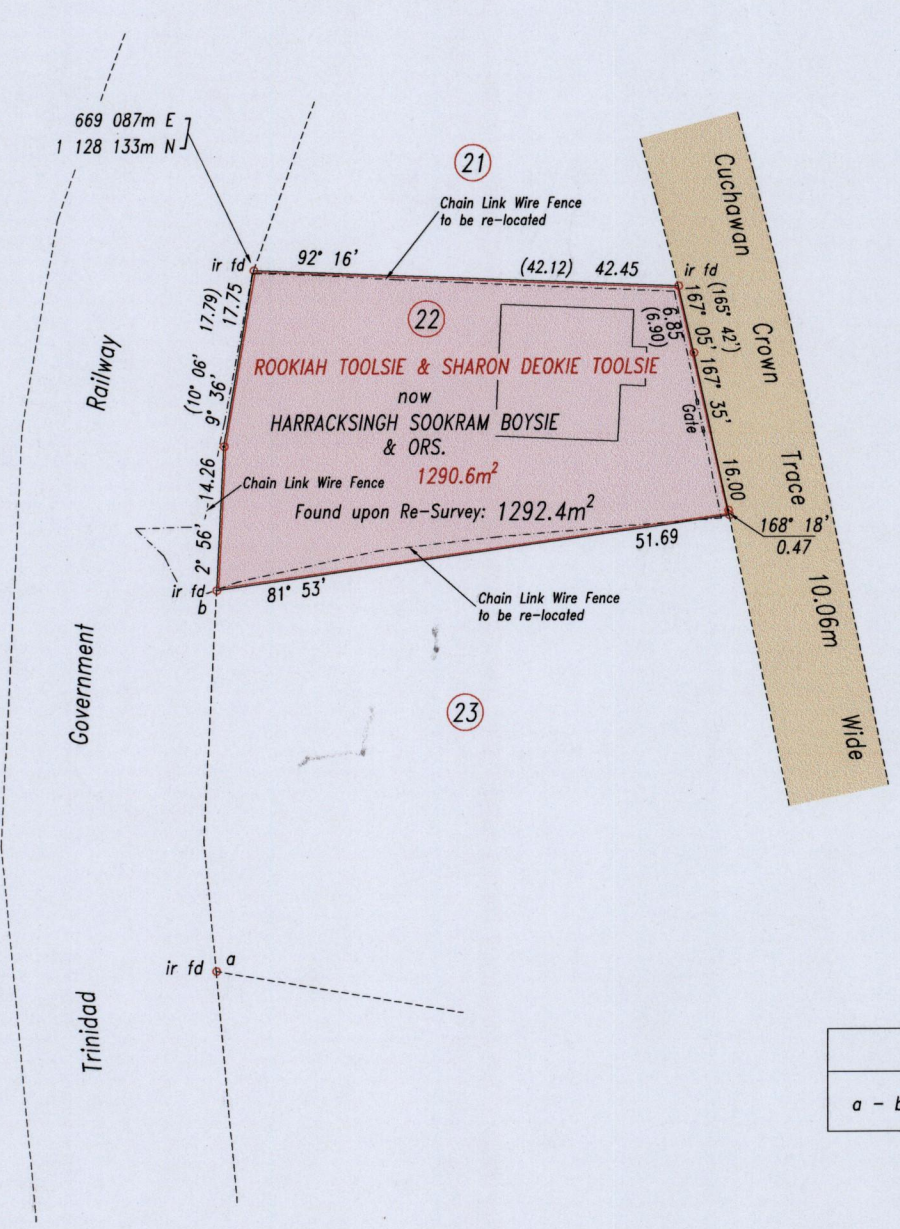

G.N. Cassini

Legend		
a - b	0° 04'	37.96

Reference: Bk.715 Fol.64

Source: GPS (Hand Held)  
 Error Statement: +/- 5m  
 Datum: Naparima, UTM (Zone 20).

Approved

*Lynn Roopchand*  
 Director of Surveys  
 2008.8.25

SCALE 1: 750

Distances are in metres

o Denotes iron put except otherwise stated

Bearings are Cassini Grid based on Solar Observations

PLAN of a parcel of land coloured pink in the Ward of Naparima  
 Containing one thousand two hundred and ninety two point four square metres  
 Surveyed by me, with due authority, in September 2007

In accordance with Regulation 25(1) of the Land Surveyors' Regulations 1998, I certify that this plan is correct.

Checked by

*phd* 13/5/08

Entered

*L.A. Ripstead*

Trinidad & Tobago Land Surveyor 5/8/2008

