

1414

1414/99

99

R.P.O. Vol. 123
C.T. Vol. 1479

Fol. 93
Fol. 289

Ward of Naparima
County of Victoria
Cadastral Sheet 63F (G.13.G)
1/d

Previous Survey
Bk. 392 Fol. 210

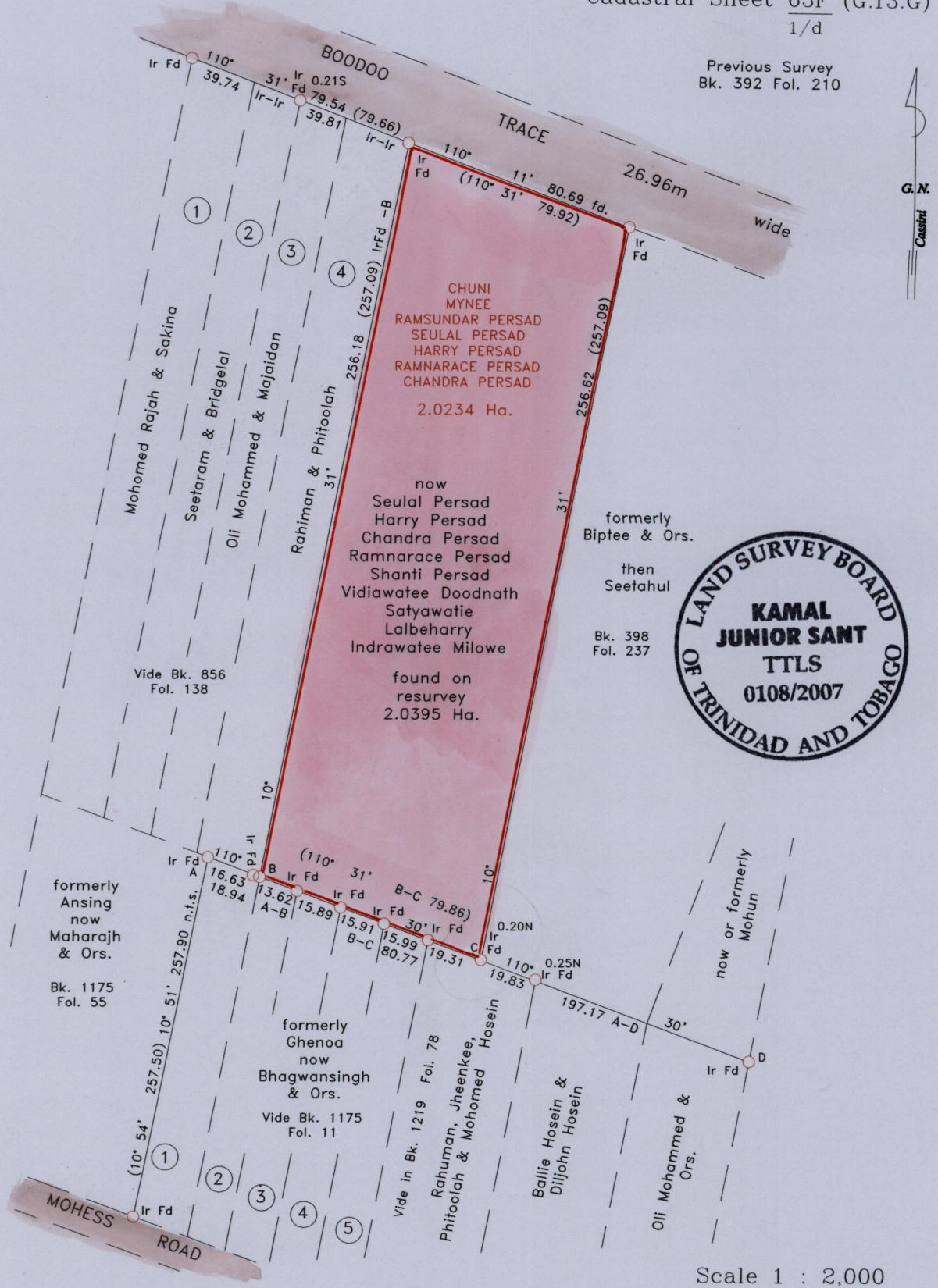

Approved by *[Signature]*
Director of Surveys
2008.1.23

○ Denotes iron put unless otherwise stated
Distances are in metres
Bearings are Cassini grid based on solar observations.
PLAN of a parcel of land coloured pink in the Ward of Naparima.
Containing Two point Zero Three Nine Five hectares.
Surveyed by me with due authority on 01st April, 2007.
In accordance with Regulation 25(1) of the Land Surveyors' Regulations 1998,
I certify that this plan is correct.

Checked by *[Signature]*
Kamal S. Sant

Entered by
Trinidad & Tobago Land Surveyor *[Signature]* 22nd October, 2007.