

1414

45

R.P.O. Vol. 49 Fol. 671
C.T. Vol. 1048 Fol. 541
Vide Plan D.C. 80
" " D.H. 6

Cadastral Sheet G.12.G. & H. 63E
Ward of Siparia
County of St.Patrick.

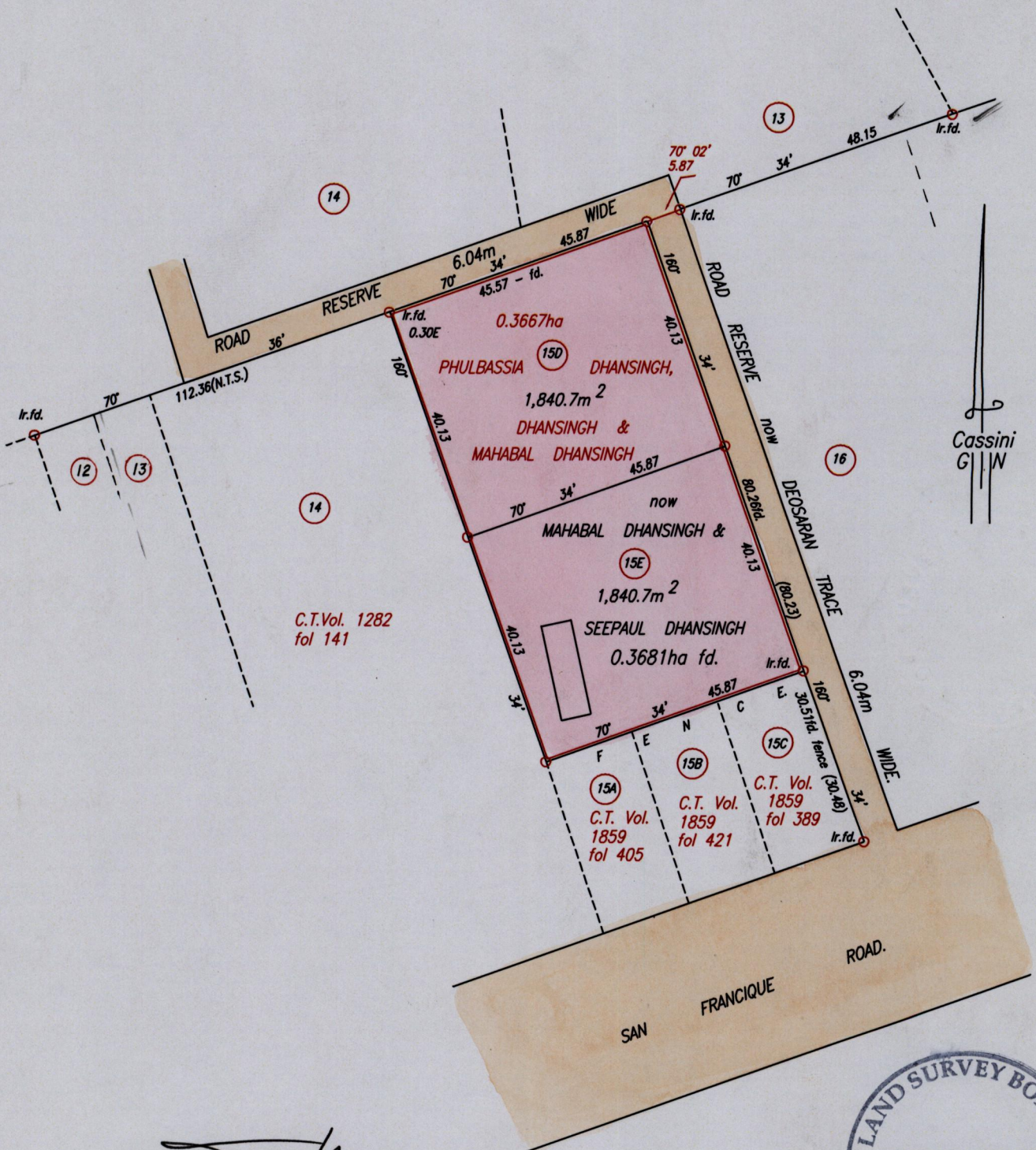

C.T.Vol. 1282
fol 141

C.T. Vol. 1859 fol 405
C.T. Vol. 1859 fol 421
C.T. Vol. 1859 fol 389

Cassini
G.I.W

Approved *[Signature]*
Director of Surveys
2007.10.31

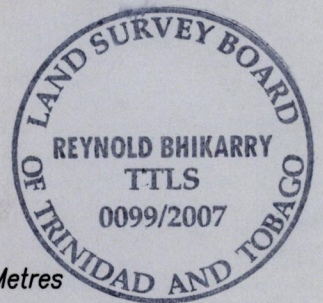

SCALE 1:1000
Distances are in Metres

○ Denotes Iron put except otherwise stated.
Bearings are Cassini Grid based on Solar Observations.

PLAN of 2 Parcels of land coloured pink in the Ward of Siparia
Containing together three thousand, six hundred and eighty one point four square metres.
Surveyed by me, with due authority, in August, 2006
In accordance with Regulation 25(1) of the Land Surveyors' Regulations 1998,
I certify that this plan is correct.

Checked by *[Signature]* *[Signature]*

Entered Trinidad & Tobago Land Surveyor *[Signature]* 2007