

1414 1414

223

R.P.O Vol. 110

Fol 463

C.T Vol. 1824

Fol. 211

Ward of Siparia
County of St. Patrick
Cadastral Sheet G 12 H $\frac{63 E}{2/c}$

Bk. 395 Fol 186

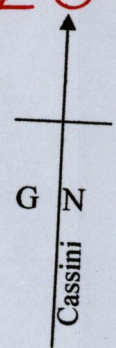

Now or formerly
Crown

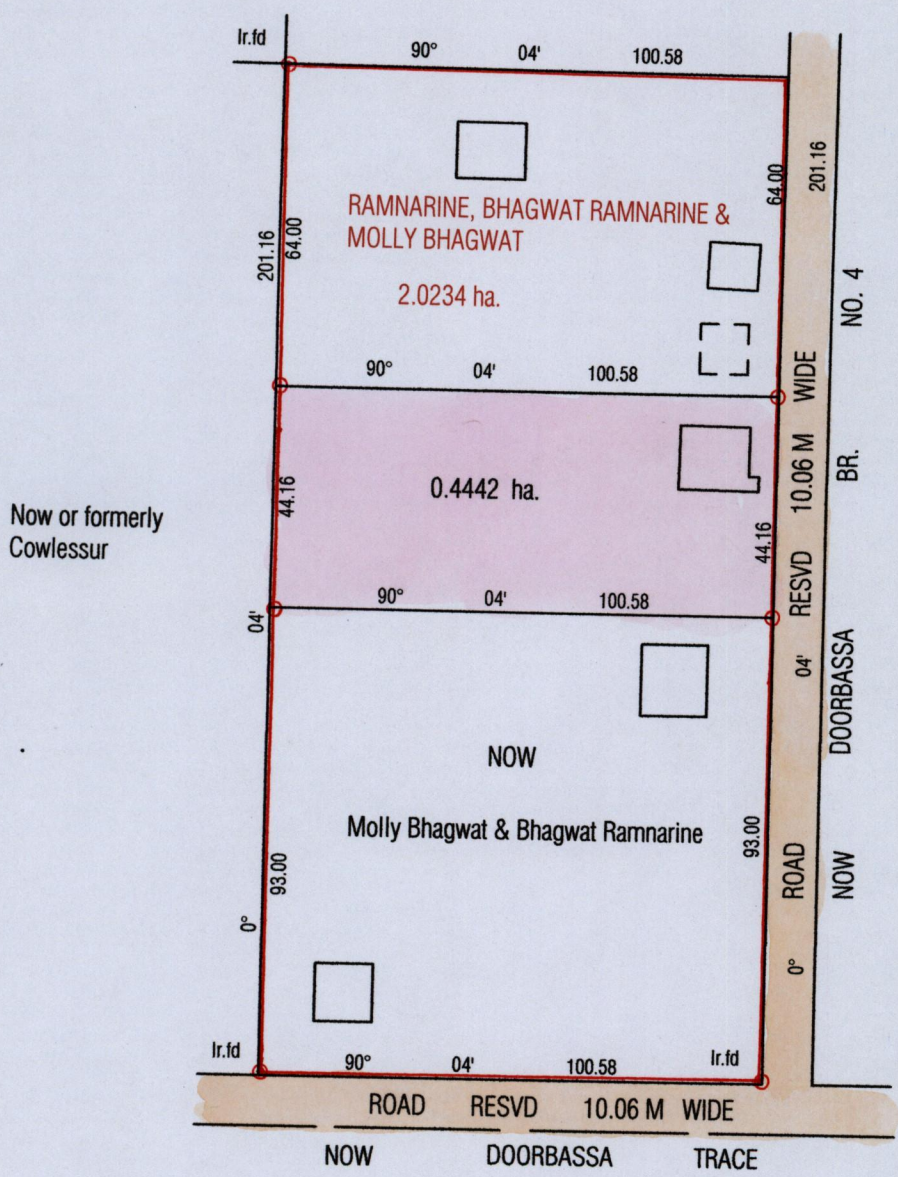

Bk. 856 Fol 52

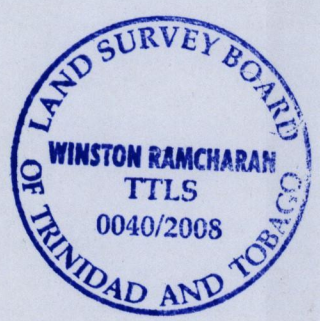

Approved *[Signature]*
Director of Surveys 2008.8.8

○ Denotes iron put except otherwise stated
Bearings are Cassini Grid based on Solar Obs
Note: To obtain compass bearings add/subtract minutes Distances are in metres

SCALE : 1 / 1500

PLAN of a Parcel of land coloured pink in the Ward of Siparia
Containing zero point four four four two hectares
Surveyed by me, with due authority, in August 2007
In accordance with Regulation 25 (1) of the Land Surveyors' Regulations 1998,
I certify that this plan is correct.

Checked by *[Signature]* Winston Ramcharan

Entered Trinidad and Tobago Land Surveyor 4th August 2008