

217

1414

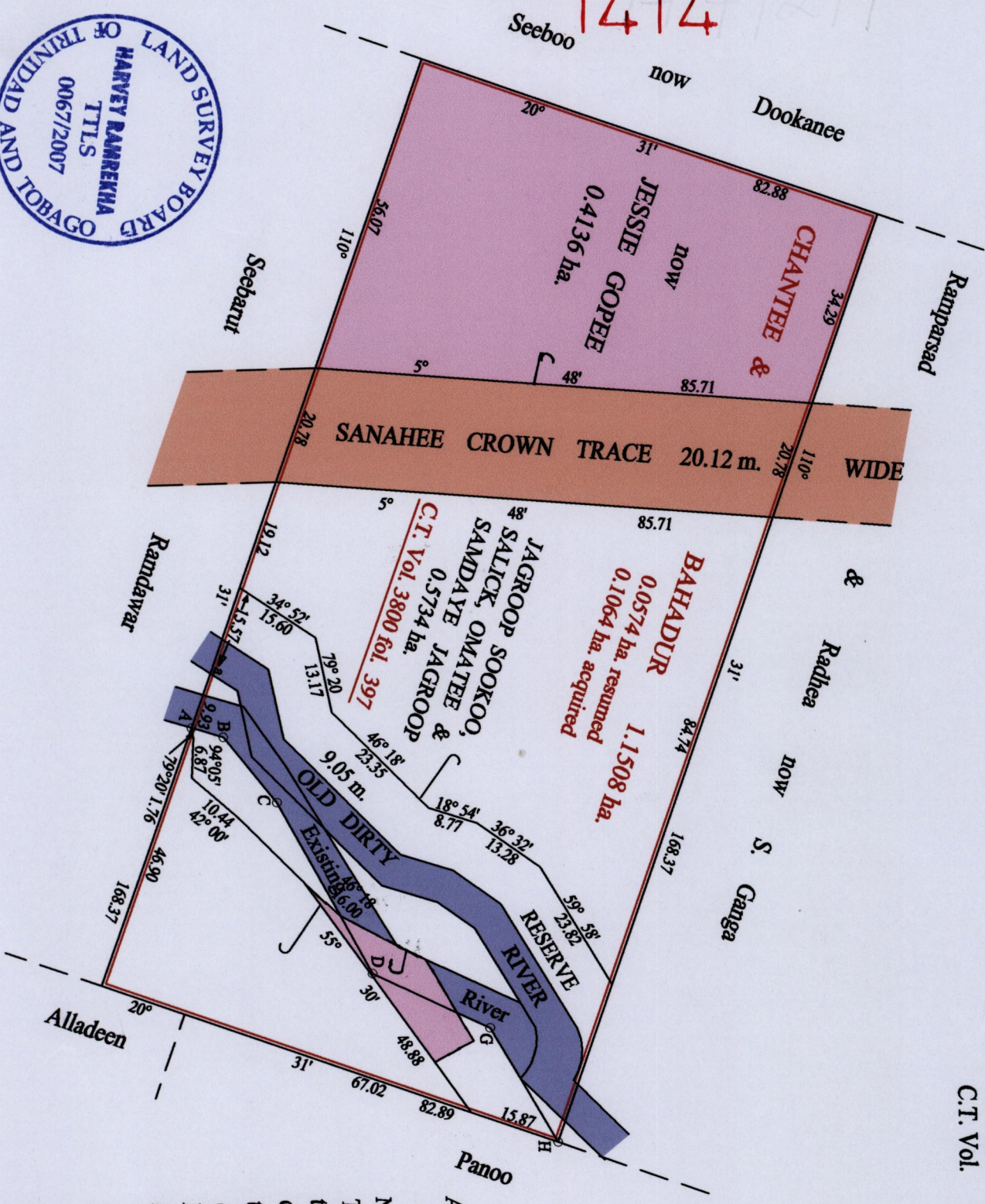

R.P.O. Vol. 208 Fol. 655
C.T. Vol. 608 Fol. 43

REMAINING PORTION

Ward of Naparima
County of Victoria
Cadastral Sheet (G 13 H) 63.F.
2/c

Eastern Bank of Existing River	
A - B	17° 43' 5.70
B - C	52° 11' 14.15
C - D	62° 22' 33.76
D - G	26° 19' 22.30
G - H	60° 42' 22.90

Vide Bk. 1145 fol. 651

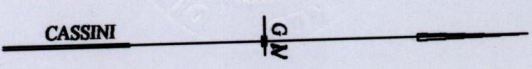

Approved
Director of Surveys 2008.8.8

SCALE: 1:1000

Note: Bearings are cassini grid based on solar observations Distances are in metres
This is a true copy of a diagram of one point one five zero eight hectares, originally transferred to Chantee & Bahadur, shewing a portion coloured pink and containing zero point four one three six hectares being the remainder after one (1) previous transfer, (1) resumed and (1) acquired of another portion of the land.
In accordance with Regulation 25 (1) of the Land Surveyors' Regulations 1998, I certify that this plan is correct.

Checked by: *Harvey Ranrekha*
Entered on: Trinidad & Tobago Land Surveyor /3 : 12 : 2007