

R.P.O. Vol. 190 Fol. 513
 C.T. Vol. 1833 Fol. 329
 U.P.R.N. No.:

Ward of Naparima
 County of Victoria
 Cadastral Sheet G.7.P. $\frac{63B}{3/c}$

Point G	666 207m E
Co-ordinates:	1 128 817m N
Source:	GPS (Hand Held)
Error Statement:	+/- 5m
Datum:	UTM (Zone 20), Naparima

Reference: Bk.407 Fol.277

Note: Parcel (1D) & Parcel (2A) to be amalgamated

Approved *[Signature]*
 Director of Surveys
 2008-3-17

SCALE 1:2000

Distances are in metres

o Denotes iron put except otherwise stated

Bearings are Cassini Grid based on Solar Observations

PLAN of 3 parcels of land coloured pink in the Ward of Naparima
 Containing together two point zero two zero two hectares
 Surveyed by me, with due authority, in April 2006

In accordance with Regulation 25(1) of the Land Surveyors' Regulations 1998, I certify that this plan is correct.

Checked by *[Signature]*
 Entered *[Signature]*
 Trinidad & Tobago Land Surveyor 15/11/2007

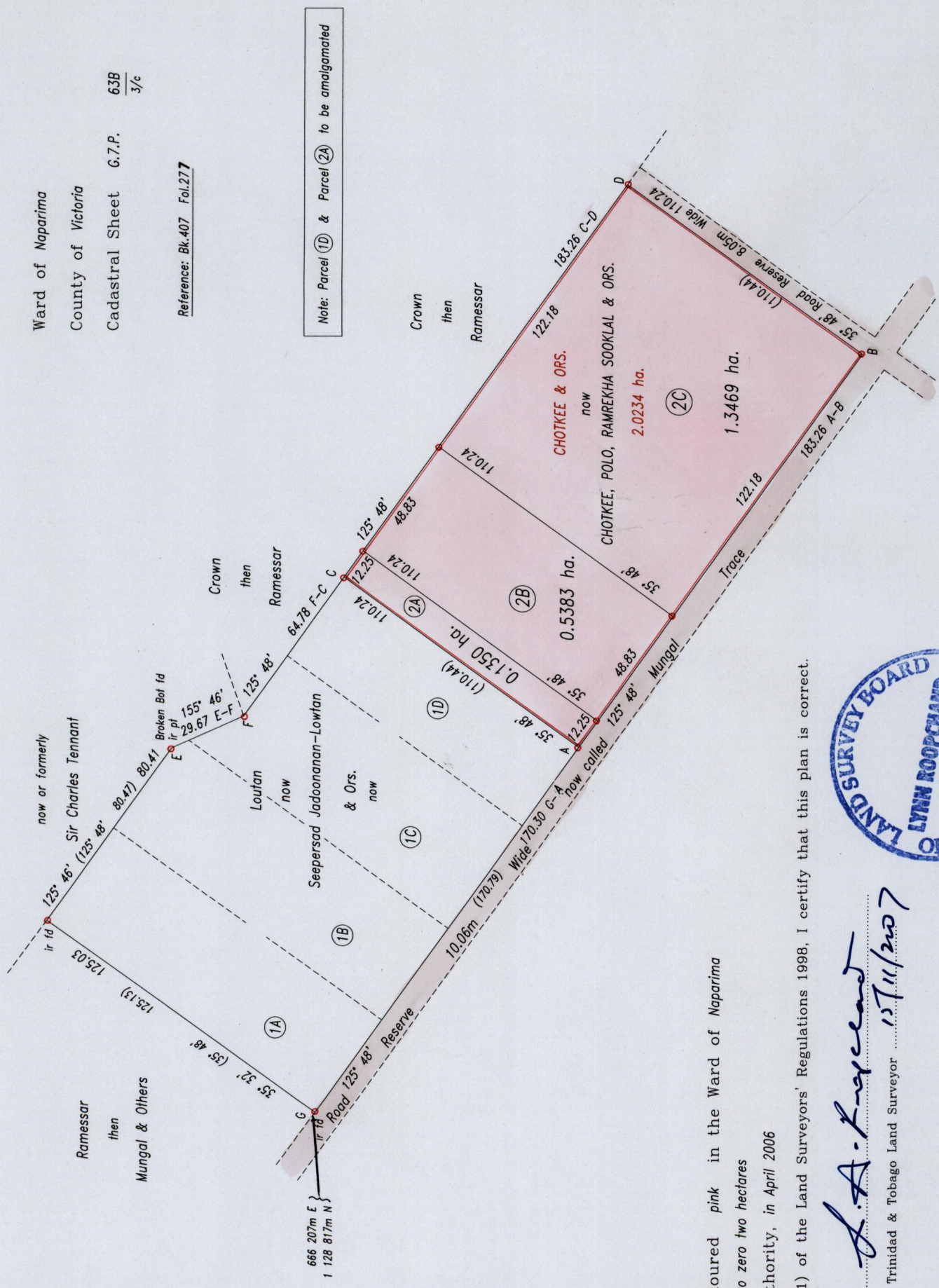
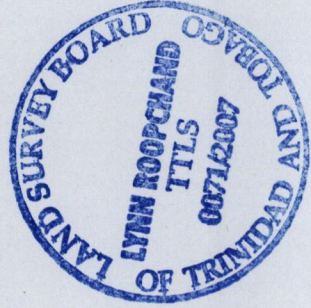

1414

134

G.N. Cassini