

1414

110

C.T. Vol. 4353 Fol. 117

U.P.I.N. No.

CONSOLIDATED PLAN FILED IN

Vol. 4353 Fol. 115

Cadastral Sheet $\frac{14C}{2/a}$, B.10.M.

Ward of Blanchisseuse

County of St. George

VOL. 4995 FOL. 333

BRASSO SECO VILLAGE

Vide
PLAN B.E.8.
PLAN E.B.132

Grid North
Cassini

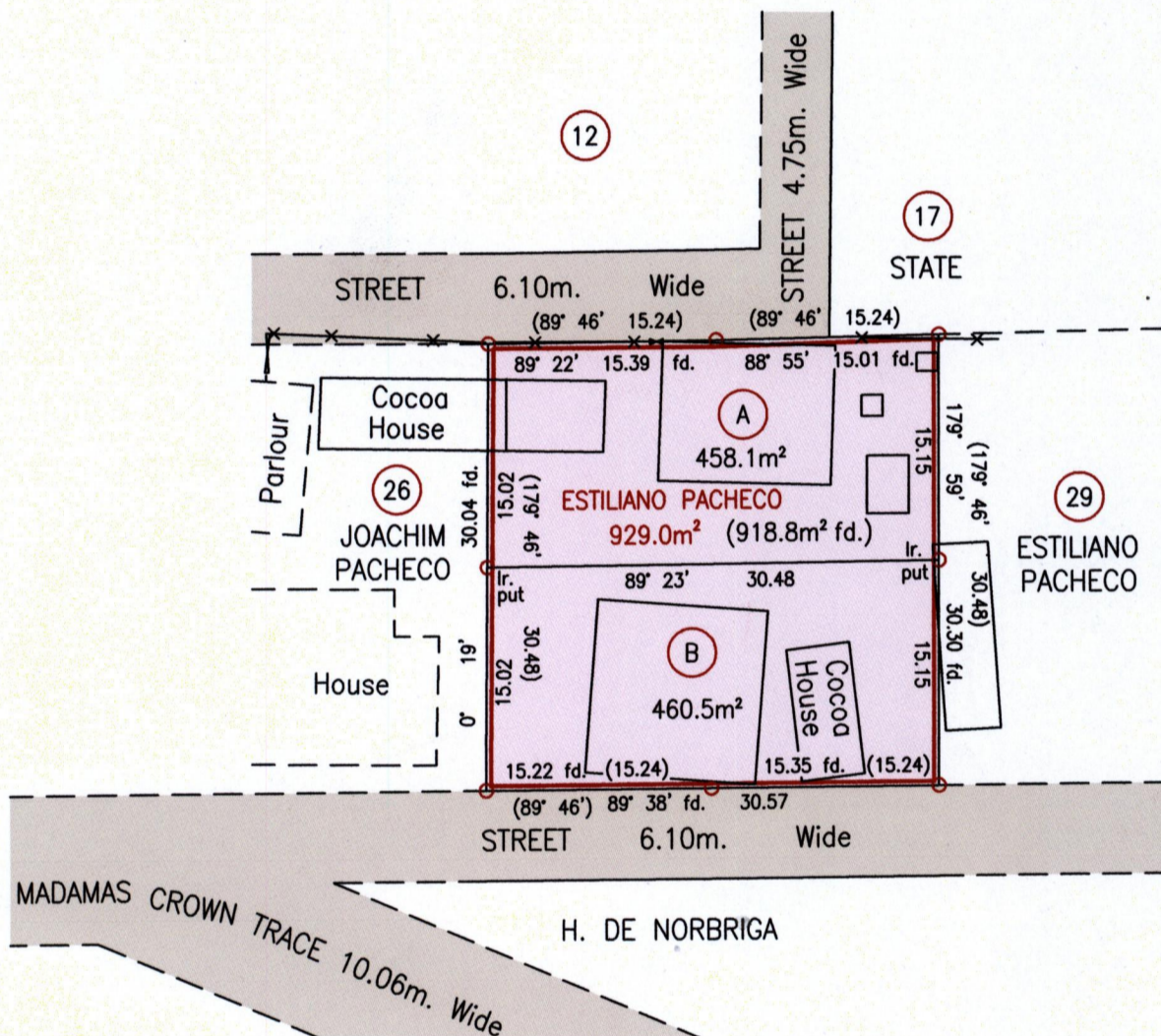

Approved

 Director of Surveys
 2008-2-13

SCALE 1:500

Distances are in Metres

— x — x — x — Denotes chain link wire fence

Bearings are Cassini Grid based on Solar Obs.

⊙ Denotes Iron Found unless otherwise stated

Plan of 2 Parcels of land coloured pink in the Ward of Blanchisseuse Containing together nine hundred and eighteen point six square metres Surveyed by me, with due authority, in July 2001

In accordance with Regulation 25(1) of the Land Surveyors' Regulations 1998, I certify that this plan is correct.

Checked by 8/2/08

Entered on Trinidad & Tobago Land Surveyor 12th November 2007

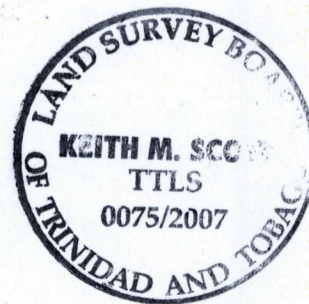

ADJ 2008-2-13

A. VOL. 5008 FOL. 39 MARTIN PACHECO

B. VOL. 5008 FOL. 71 MALTICA PACHECO

