

1414

103

R.P.O. 227 Fol 537.
C.T. 1144 Fol. 489

Ward of Siparia.
County of St. Patrick.
Cadastral Sheet G.14.E. 64D
1/c

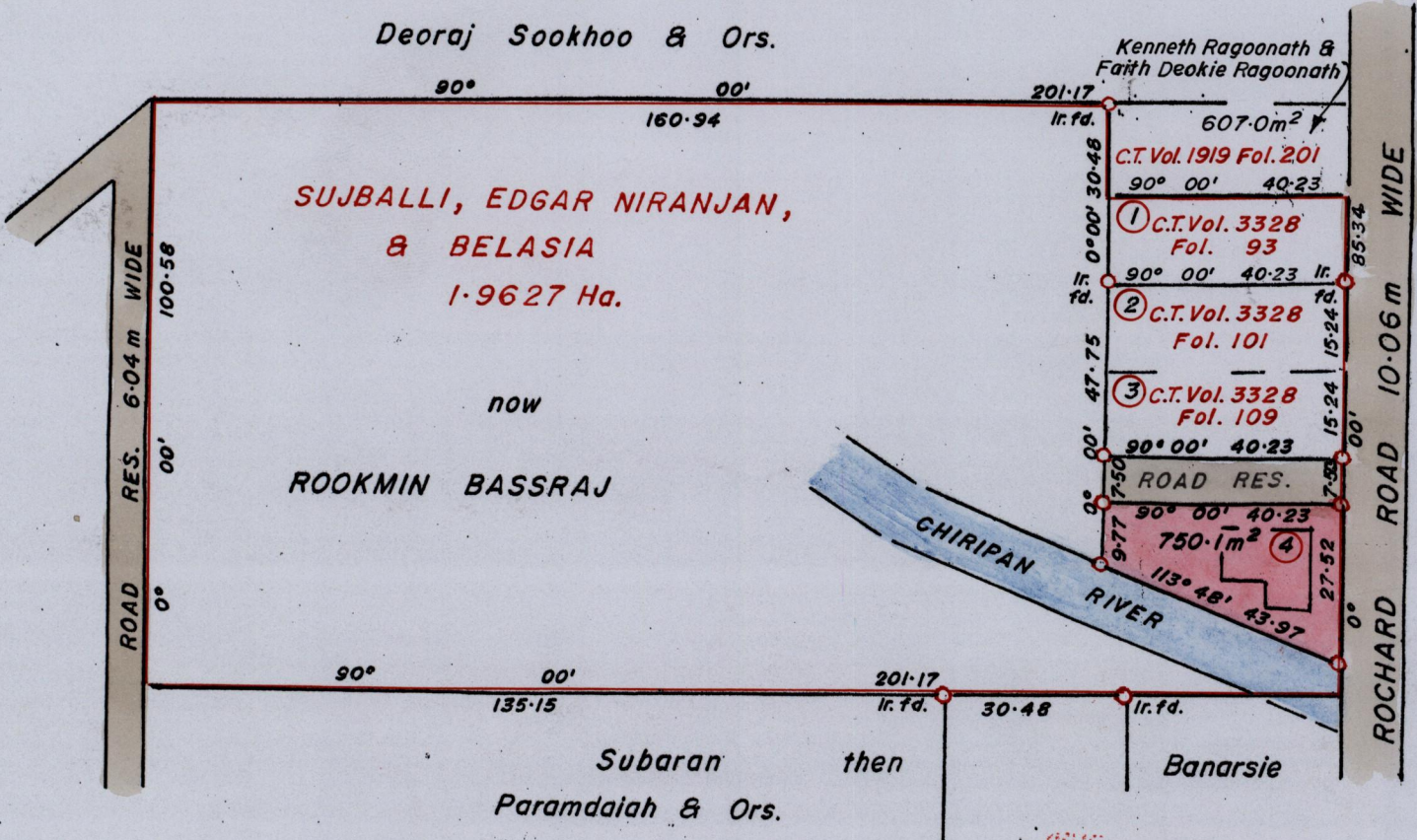

- Lot 1 - 613.1m² - Errol Ragoonath & Jannet Ragoonath
- Lot 2 - 613.1m² - Rawle Ragoonath & Monica Ragoonath
- Lot 3 - 613.1m² - Aldwin Ragoonath & Rubena Ragoonath

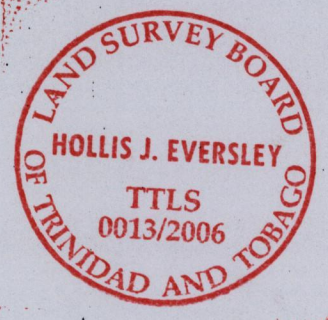

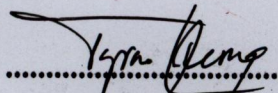
Approved 
 Director of Surveys
 2708/123

Bk. 1179 / 214.
1103 / 203

○ Denotes Iron put unless otherwise stated
 Bearings are Cassini Grid based on Solar Obs.
 SCALE 1250.

Note: To Obtain compass bearings add/subtract minutes Distances are in METRES
PLAN of a Parcel of land coloured PINK in the Ward of Siparia.
Containing seven hundred and fifty point one square metres.
Surveyed by me, with due authority, in September 2006.
In accordance with Regulation 25 (1) of the Land Surveyors' Regulations 1998,
I certify that this plan is correct.

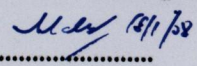
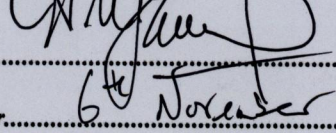
Checked by 
 Entered Trinidad and Tobago Land Surveyor  2006.