

1395 395 49

49

R.P.O. Vol. fol.
C.T. Vol. 2969 fol. 55
Bk. 1148 fol. 88

Ward of Savana Grande
County of Victoria
Cadastral Sheet (G. 14. H & D) $\frac{64 D}{2/d}$

A = N. 1169780 E. 679974
U.T.M. Zone 20 Naparima +/- 5.00 m.
Hand Held G.P.S.

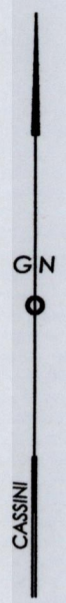
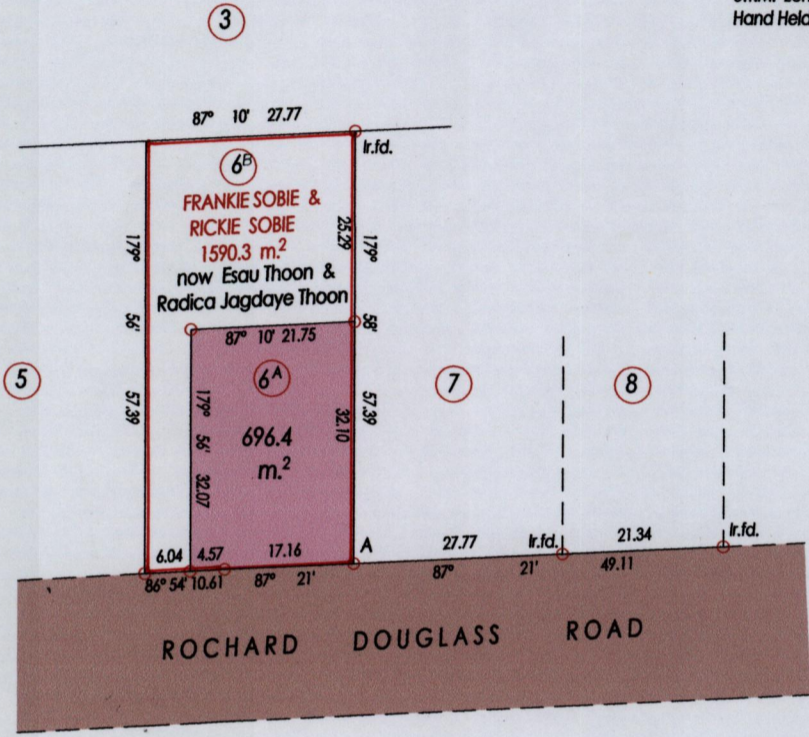

Approved *[Signature]*
Director of Surveys 2011.11.11

○ Denotes Iron Put Except Stated Otherwise
SCALE 1 : 1000

Bearings are Cassini Grid based on Solar Observations Distances are in Metres
PLAN of a Parcel of land coloured pink in the Ward of Savana Grande
Containing six hundred and ninety six point four sq. metres
Surveyed by me, with due authority in, May 2010
In accordance with Regulation 25 (1) of the Land Surveyors' Regulations 1998,
I certify that this plan is correct.

[Signature]
18th February 2011

Entered on 11.11.08 Trinidad & Tobago Land Surveyor 2011