

Cadastral Sheet G.15.D&H 64F
1/b

Process ID# 40924

R.P.O. 262 Fol. 491

C.T.Vol. Fol.

See Plan B.A.22
Bk.374 Fol.481

Ward of Ortoire
County of Victoria
St. MARY'S VILLAGE, MORUGA

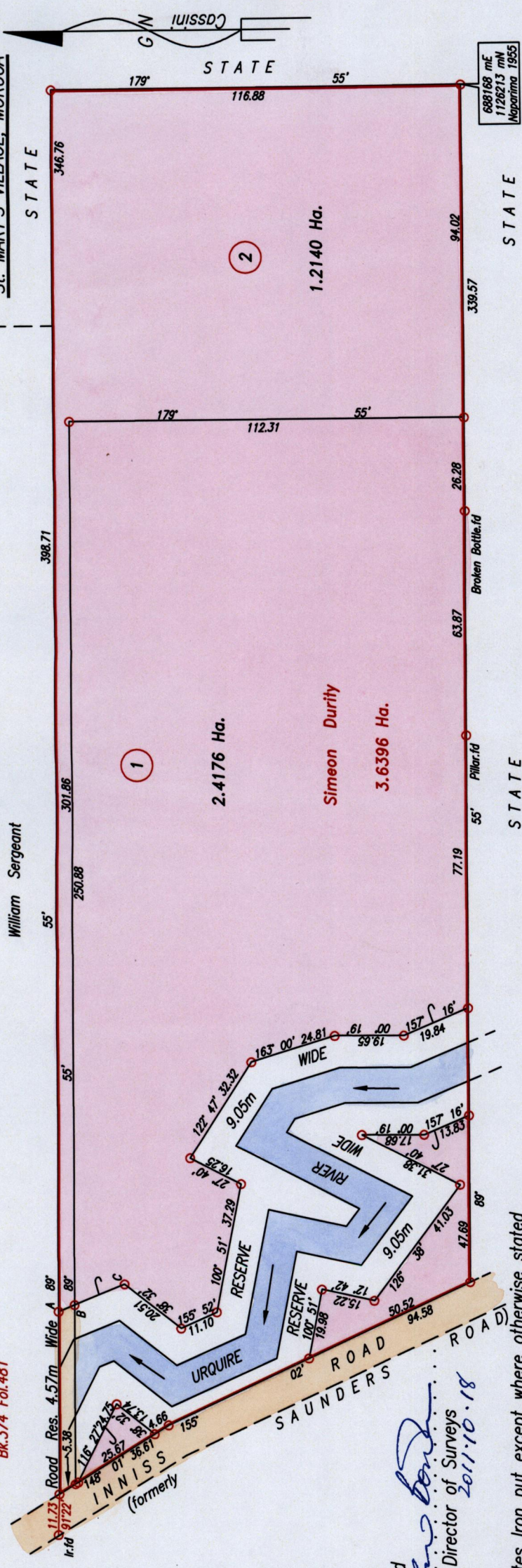

688168 mE
1126213 mN
Naportima 1955

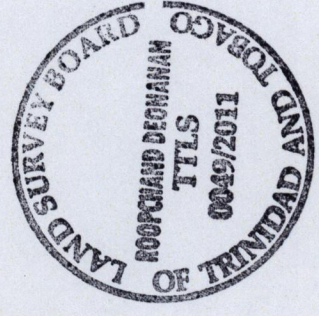

SCALE 1:1500
Distances are in metres

A - B 157° 51' 4.93
B - C 157° 51' 15.35

Coordinates obtained from Topo Data

Approved
[Signature]
Director of Surveys
2011.10.18

○ Denotes Iron put except where otherwise stated
Bearings are Cassini Grid based on Solar Observations
PLAN of 2 Parcels of land coloured pink in the Ward of Ortoire
Containing together three point six three one six hectares
Surveyed by me, with due authority, in December 2009
In accordance with Regulation 25 (1) of the Land Surveyors' Regulations 1998,
I certify that this plan is correct.

Checked by: *[Signature]* 2011.12.10/2011

Entered on: *[Signature]* Trinidad & Tobago Land Surveyor. 27th June 2011.
PATH = AD4004 C:\DSD\DUITY DWG