

1895/20
1395

22

R.P.O. Vol. 47 Fol. 623
C.T. Vol. 1733 Fol. 159
Process ID# 43757

Ward of Ortoire
County of Victoria
Cadastral Sheet D.24.P., 54C
3/6

VIDE Bk.323 fol.123
Bk.712 fol.93

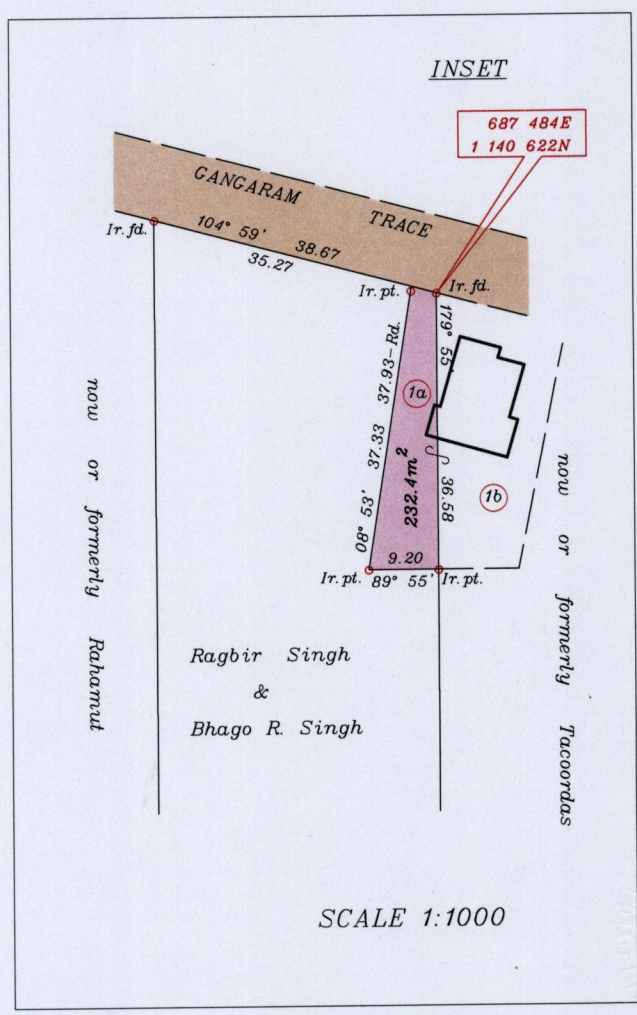
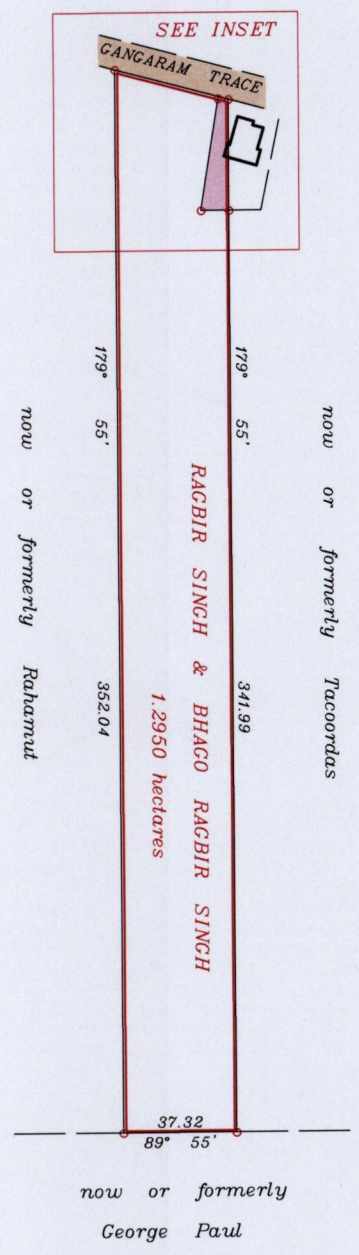

Note: Parcel #1a to be amalgamated to parcel #1b

Approved *[Signature]*
Director of Surveys 2011.10.18



Co-ordinates are U.T.M. Zone 20 Naparima Datum +/-5m
obtained from handheld G.P.S.

SCALE 1:2500

Bearings are Cassini Grid based on Solar Observations Distances are in metres

PLAN of a Parcel of land coloured pink in the Ward of Ortoire
Containing two hundred and thirty two point four square metres
Surveyed by me, with due authority, in November 2007

In accordance with Regulation 25(1) of the Land Surveyors Regulations 1998,
I certify that this plan is correct.

Checked by *[Signature]* 12/11/11
Entered *[Signature]*

[Signature]
Trinidad & Tobago Land Surveyor September 20 2011