

1395

1395/205

205

R.P.O. Vol.

Fol.

C.T. Vol. 3642

Fol. 399

Cadastral Sheet G. 5. J., 54E  
2/c

Ward of Ortoire

County of Victoria

A - 683975mE, 1136227mN  
UTM ZONE 20, Naparima (+/- 8.00M)  
Direct Observation-GPS Hand held

G.N.

Cassini

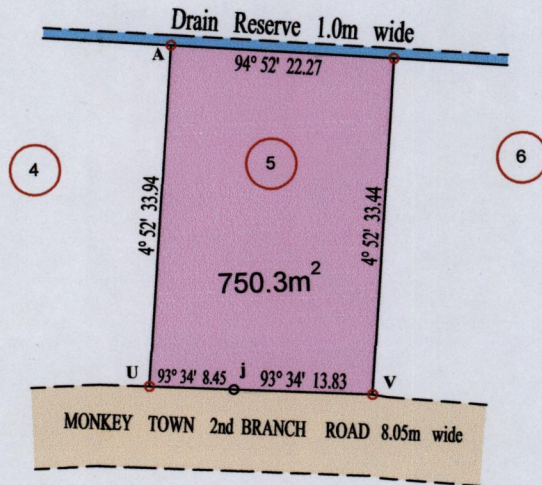

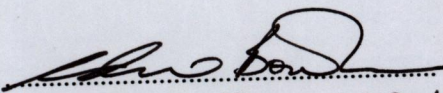
Approved   
Director of Surveys 2012.4.11

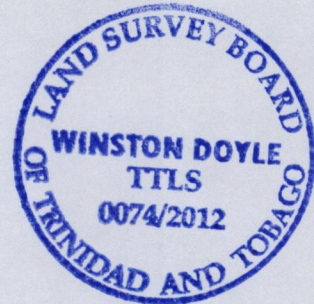

- Denotes Traverse Station
- ⊙ Denotes Iron Put unless otherwise stated

SCALE 1 : 750  
Distances are in Metres

Bearings are Cassini Grid based on Solar Observations

PLAN of a Parcel of land coloured pink in the **Ward of Ortoire**  
Containing **seven hundred and fifty point three square metres**  
Surveyed by me, with due authority, in **December 2005**

In accordance with Regulation 25(1) of the Land Surveyors' Regulations 1998, I certify that this plan is correct

Entered on .....

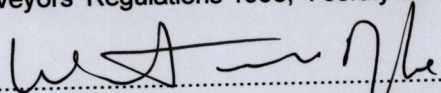
 .....

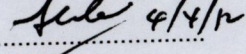
Checked by  4/4/12

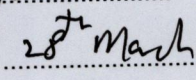
Trinidad and Tobago Land Surveyor  28<sup>th</sup> March 2012