

Process ID# 44633

References

Bk. 1220:60

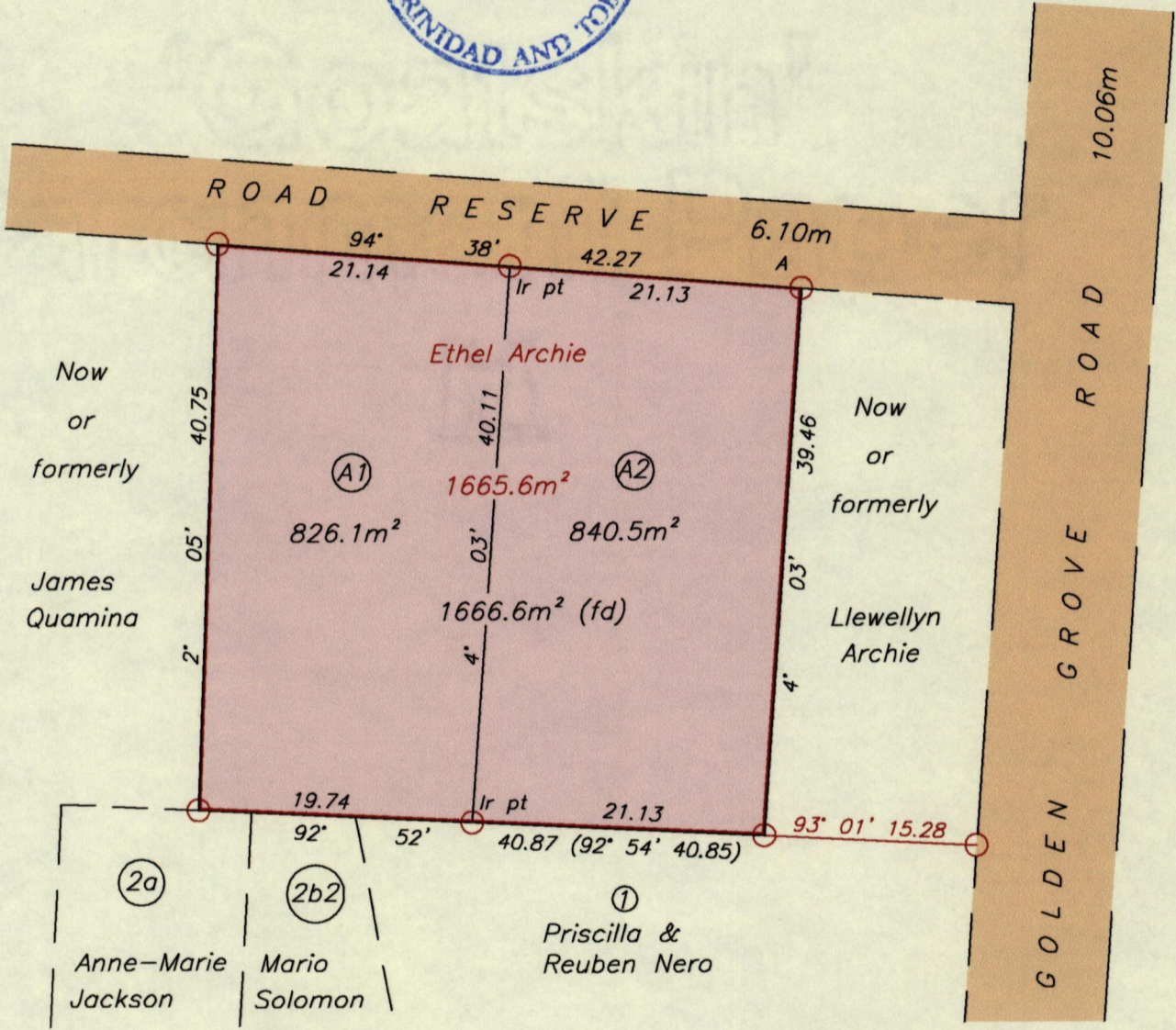
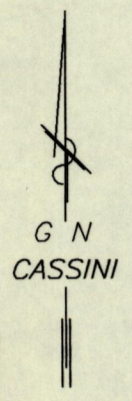
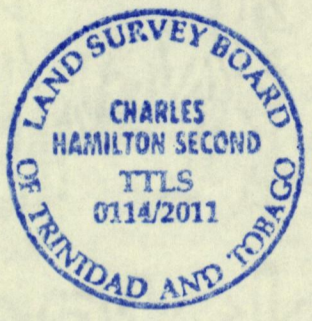

A = E:739331 ±5m by hand held GPS
N:1234127

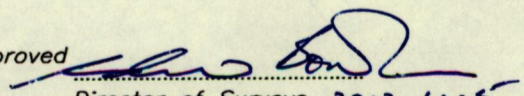
Approved 
Director of Surveys 2012.4.5

SCALE 1:500
Distances are in METRES

○ Denotes Iron found unless otherwise stated
Bearings are Cassini Grid based on solar observations.

PLAN of two Parcels of land coloured pink in the Ward of Tobago
Containing together one thousand six hundred & sixty six point six square metres
Surveyed by me, with due authority, in September 2010,
In accordance with Regulation 25 (1) of the Land Surveyors' Regulations 1998,
I certify that this Plan is correct.

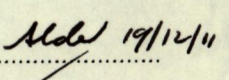
Checked by  Charles H. Second T.T.L.S.

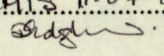
Entered on CH.13 11-07-2012 Trinidad & Tobago 25th January 2011
 Land Surveyor