

1395

1395/160

160

REMAINING PORTION

R.P.O. Vol. 149 Fol. 327

C.T. Vol. 2226 Fol. 287

Ward of Siparia

County of St. Patrick

Cadastral Sheet G 13 E  $\frac{63 E}{2/d}$

G N

Cassini

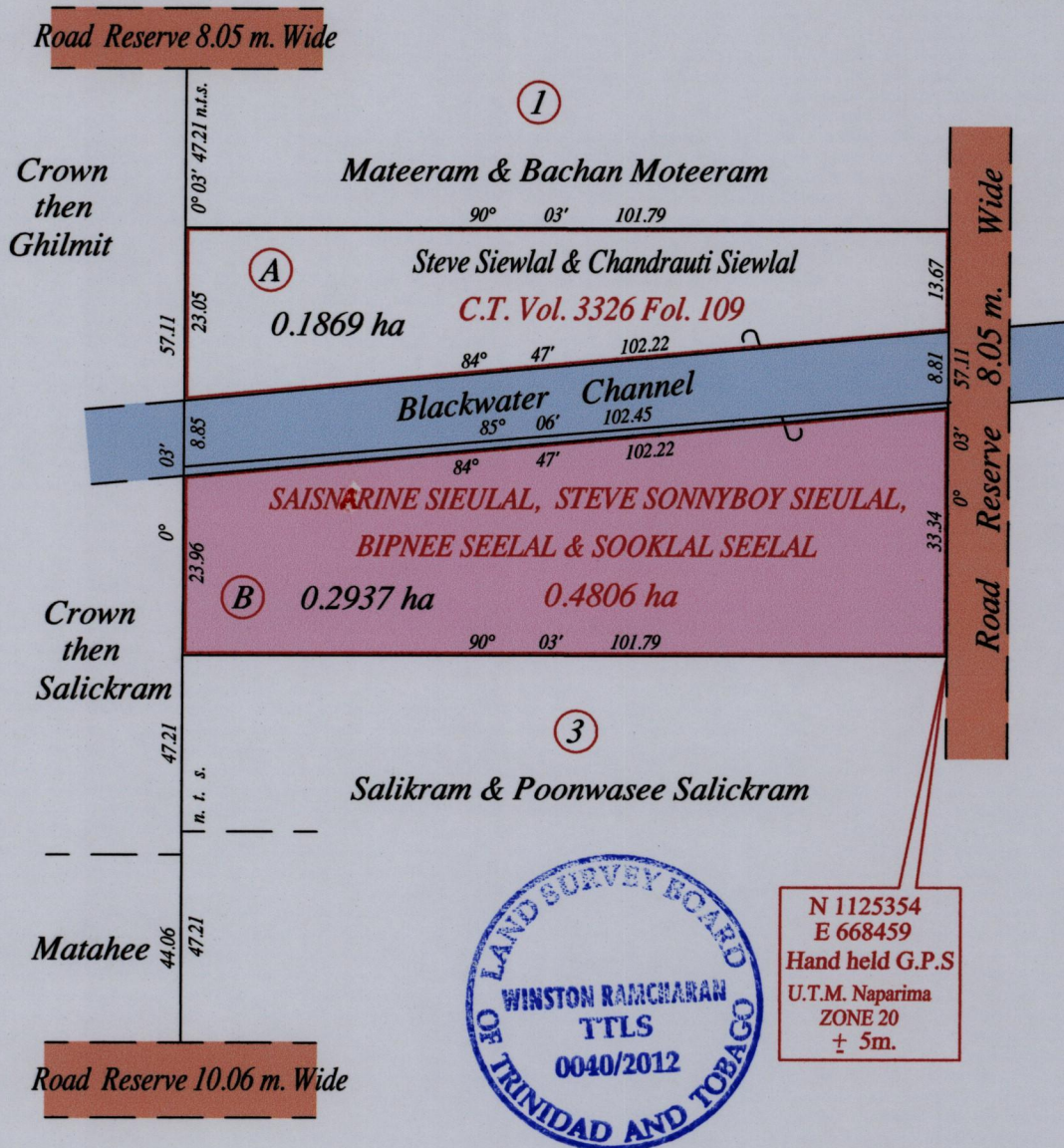

N 1125354  
E 668459  
Hand held G.P.S  
U.T.M. Naparima  
ZONE 20  
± 5m.

Vide Bk. 999 fol 154

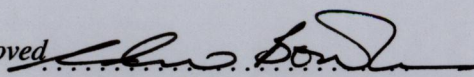
Approved   
Director of Surveys 2012.3.6

SCALE : 1:1000

Note: Bearings are Cassini grid based on solar observations Distances are in metres  
This is a true copy of a diagram of zero point four eight zero six hectares, originally transferred to Saisnarine Sieulal, Steve Sonnyboy Sieulal & Ors shewing a portion coloured pink and containing zero point two nine three seven hectares being the remainder after one (1) previous transfer of another portion of the land.  
In accordance with Regulation 25 (1) of the Land Surveyors' Regulations 1998, I certify that this plan is correct.

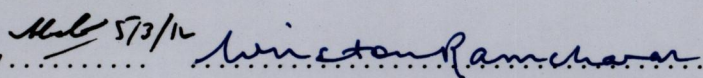
Checked by  Winston Ramcharan

Entered on ..... Trinidad & Tobago Land Surveyor 26<sup>th</sup> January 2012