

1395

150

R.P.O. Vol. 142 Fol. 367
C.T. Vol. 1096 Fol. 385

Cadastral Sheet E.2.D. $\frac{36D}{3/a}$

Ward of Turure

County of St. Andrew

Process ID# 48284

Plum Mitan

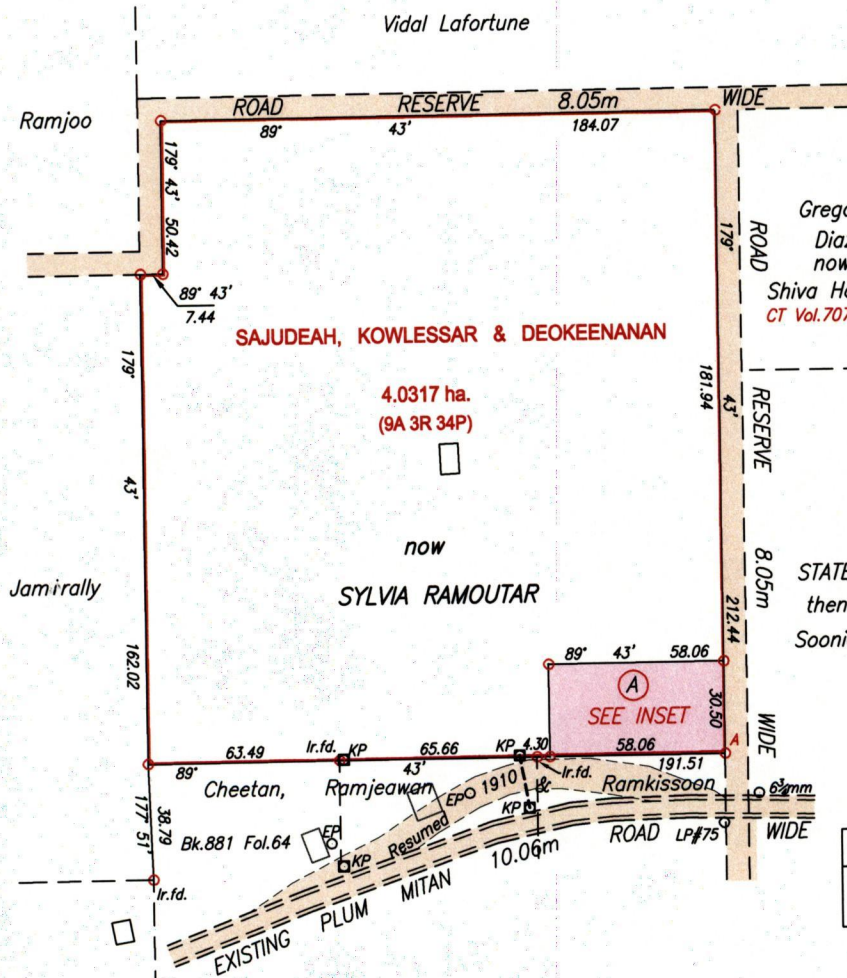
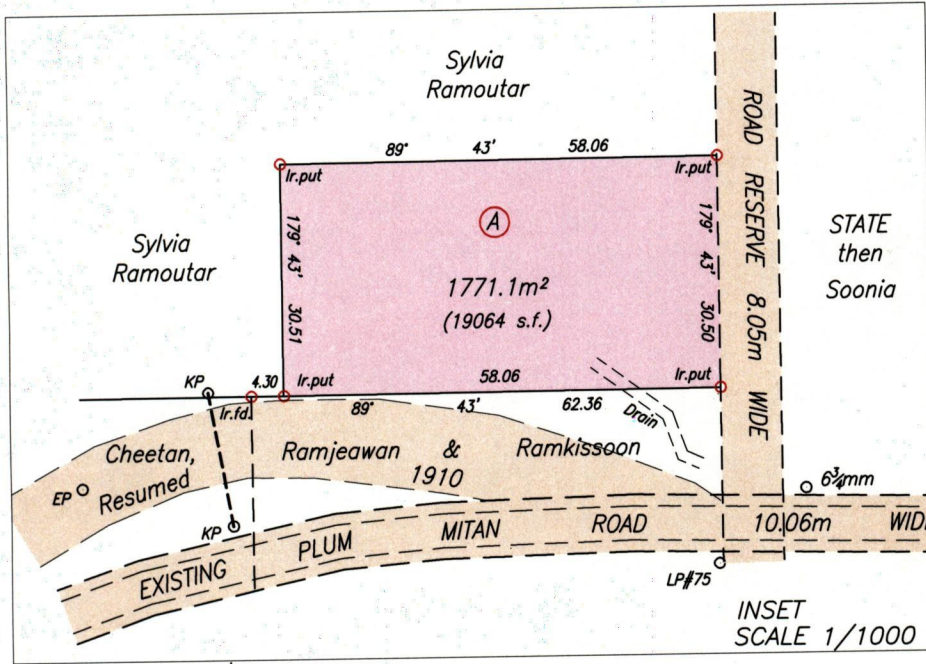

Station	Bearing	Distance
A - 6 1/2mm	140° 08'	17.47

----- Wall
Bk.183 Fol.64
A Ir.put E 708937 Hand held GPS
N 1157288 WGS84 Zone20

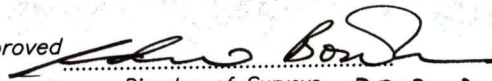
Approved 
Director of Surveys 2012-2-27

- o Denotes Iron put unless otherwise stated
- Bearings are Cassini Grid based on Solar Observations

PLAN of a Parcel of land coloured pink in the Ward of Turure
Containing one thousand seven hundred and seventy one point one square metres
Surveyed by me, with due authority, in December 2010
In accordance with Regulation 25 (1) of the Land Surveyors' Regulations 1998,
I certify that this plan is correct.

Checked by  14/2/2012

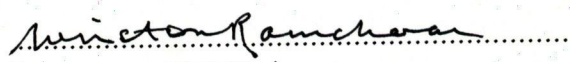

Entered on CMIS 12-07-2012

Trinidad & Tobago Land Surveyor 31st January 2012

SCALE 1/2500
Distances are in metres

Lot #	C.T. Vol. & Folio	Names
A	5486 fol 133	Cindell & Carmen Hanuman.
B		
C		
D		
E		



1395/150