

1395

14()

Process JDA 47953

R.P.O. Vol. 54 Fol. 313

C.T. Vol. 2080 Fol. 15

REMAINING PORTION

Ward of Naparima

County of Victoria

Cadastral Sheet G.13.B. 63 F 1/a

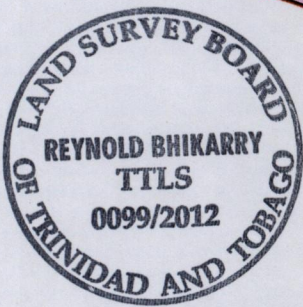
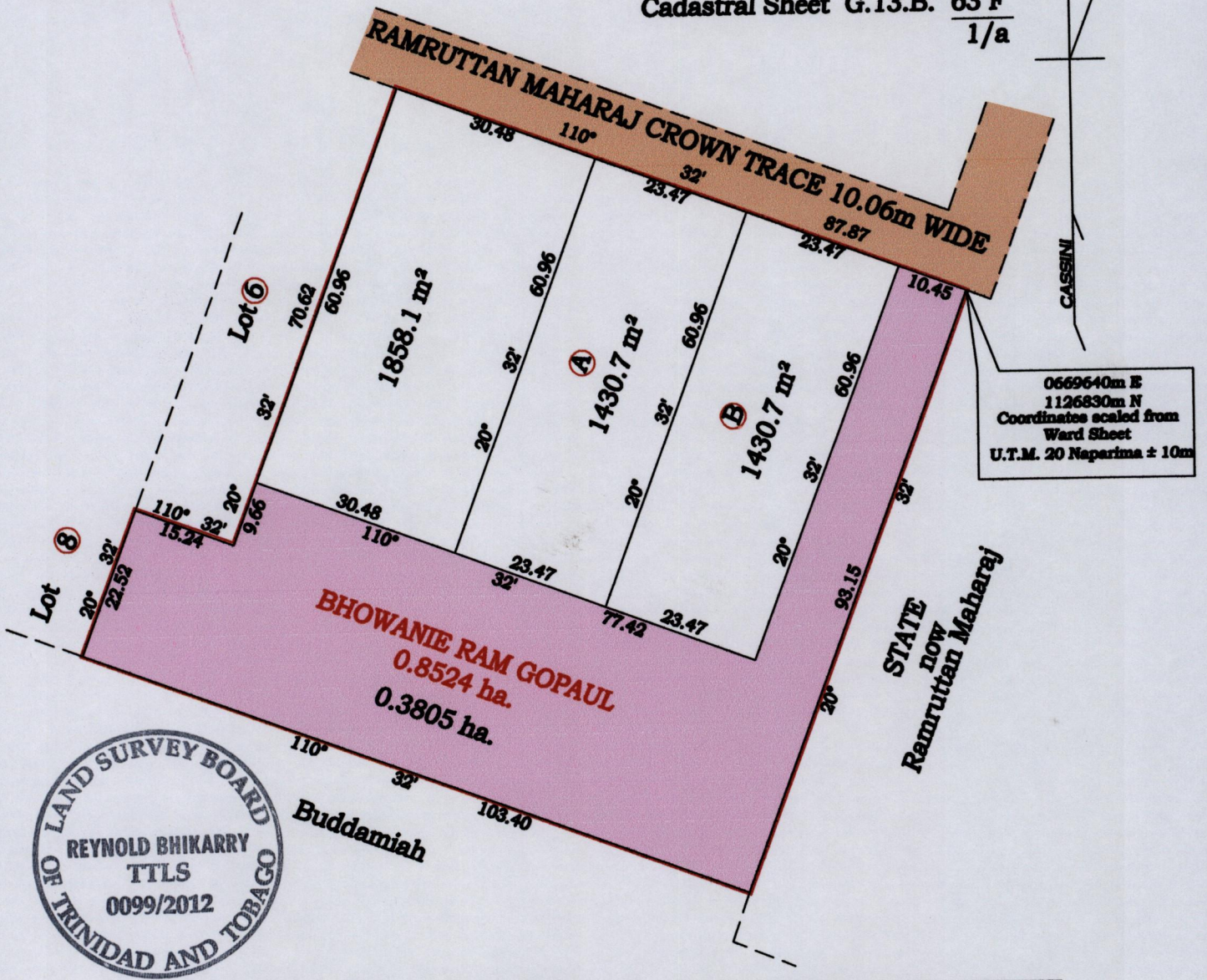

Parcel	C.T. Vol	Fol.	Size	Owners
A	2140	94	1430.7 m ²	Narine Dookie
B	2140	93	1430.7 m ²	Sitaram and Parbatee Boochoonsingh
	2094	359	1858.1 m ²	Narine Dookie

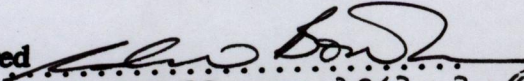
Approved 
 Director of Surveys 2012.2.10

VIDE BK. 997 FOL. 52

SCALE : 1:1000

Distances are in metres

Note: Bearings are cassini grid based on solar observations
 This is a true copy of a diagram of zero point eight five two four hectares originally transferred to Bhowanie Ram Gopaul, shewing a portion coloured pink and containing zero point three eight zero five hectares being the remainder after three (3) previous transfers of another portion of the land. In accordance with Regulation 25 (1) of the Land Surveyors' Regulations 1998, I certify that this plan is correct.

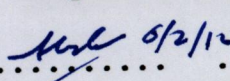
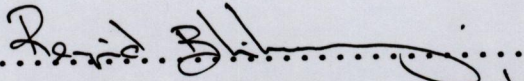
Checked by  01/2/12 

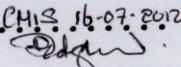
Entered on  16-07-2012 Trinidad & Tobago Land Surveyor 10th January 2012