

R.P.O. Vol. 204 Fol. 153
C.T. Vol. 748 Fol. 157
C.T. Vol. 5529 Fol. 83

Ward of Naparima
County of Victoria
Cadastral Sheet G 14 B 64.D.
1/d

Approved *[Signature]*
Director of Surveys 2012.2.29

Denotes Iron pin except stated otherwise.

Note: Bearings are cassini grid based on solar observations

Distances are in metres

PLAN of a Parcel of land coloured pink in the Ward of Naparima

Containing eight hundred and fourteen point two square metres

Surveyed by me, with due authority, in September 2009

In accordance with Regulation 25 (1) of the Land Surveyors' Regulations 1998,

I certify that this plan is correct.

Checked by *[Signature]* 2/12/11
Entered on Trinidad & Tobago Land Surveyor /3 2012

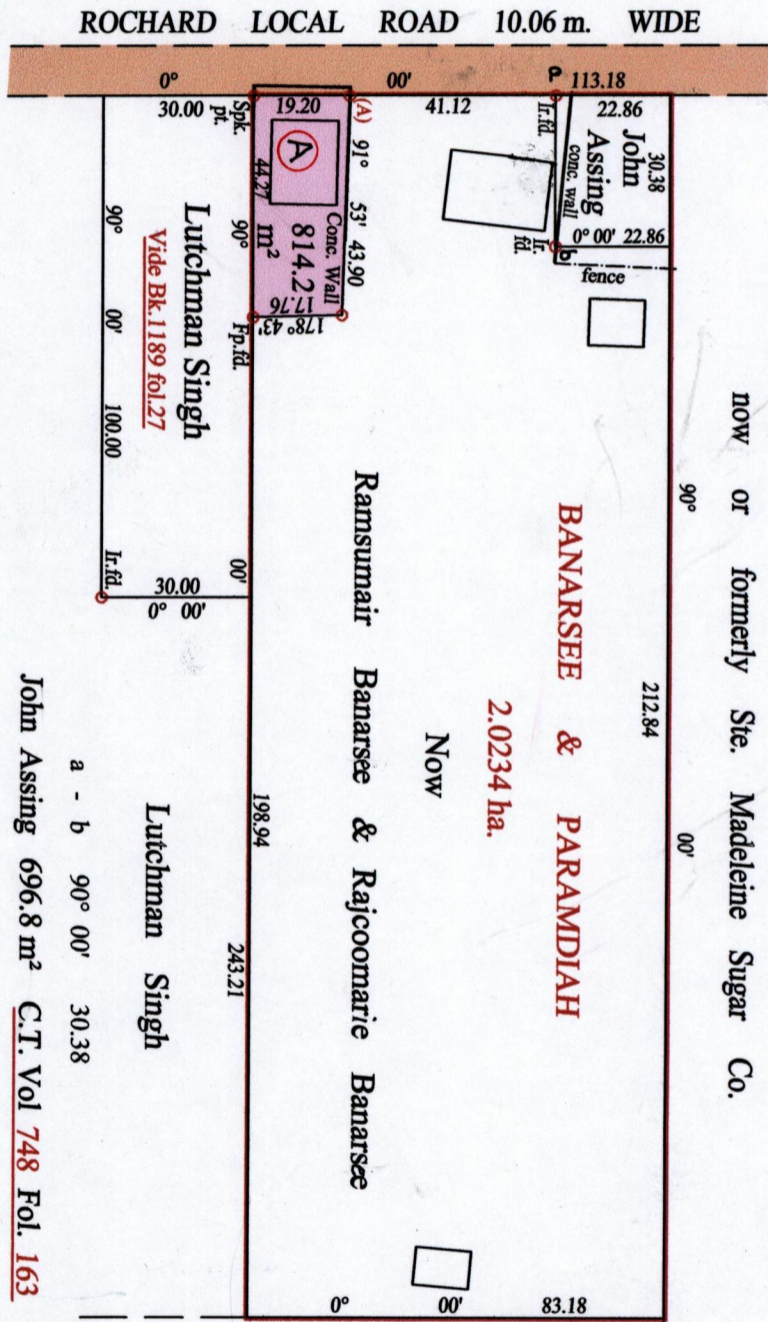

CROWN then Jootan

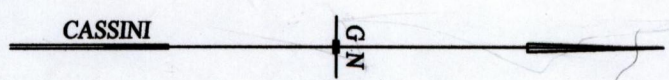

At Station (A)
E 0675765
N 1126355
Reading taken with
Handheld G.P.S.
U.T.M. Zone 20
Naparima
+ 5 m.



137

1395

C.T. Vol. 5529 fol. 83 - RAMROOP, CYNTHIA & MAHADEO BANARSEE

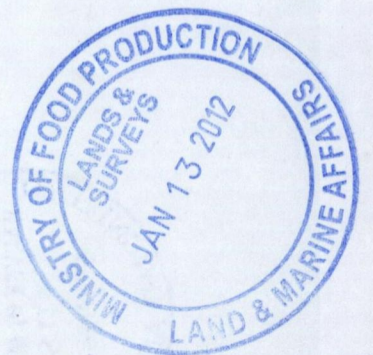
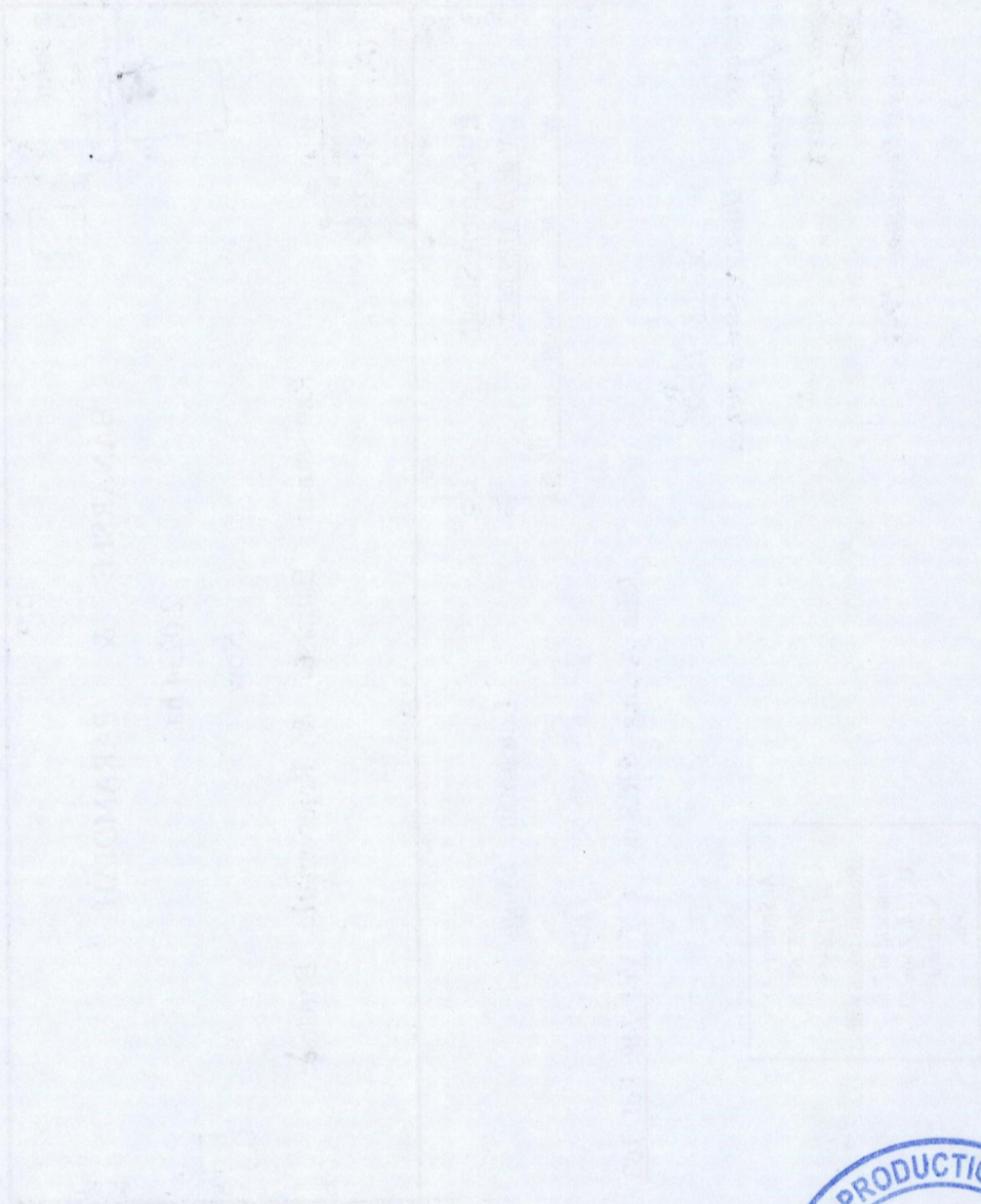

1395/137