

R.P.O. Vol. 2956 Fol. 499
C.T. Vol. 5026 Fol. 59

Cadastral Sheet I.21.A. 1E
6/a/3
Ward of Tobago
Parish of St. Patrick
BON ACCORD

Process ID# 43753

Vide Bk. 1132 Fol. 98

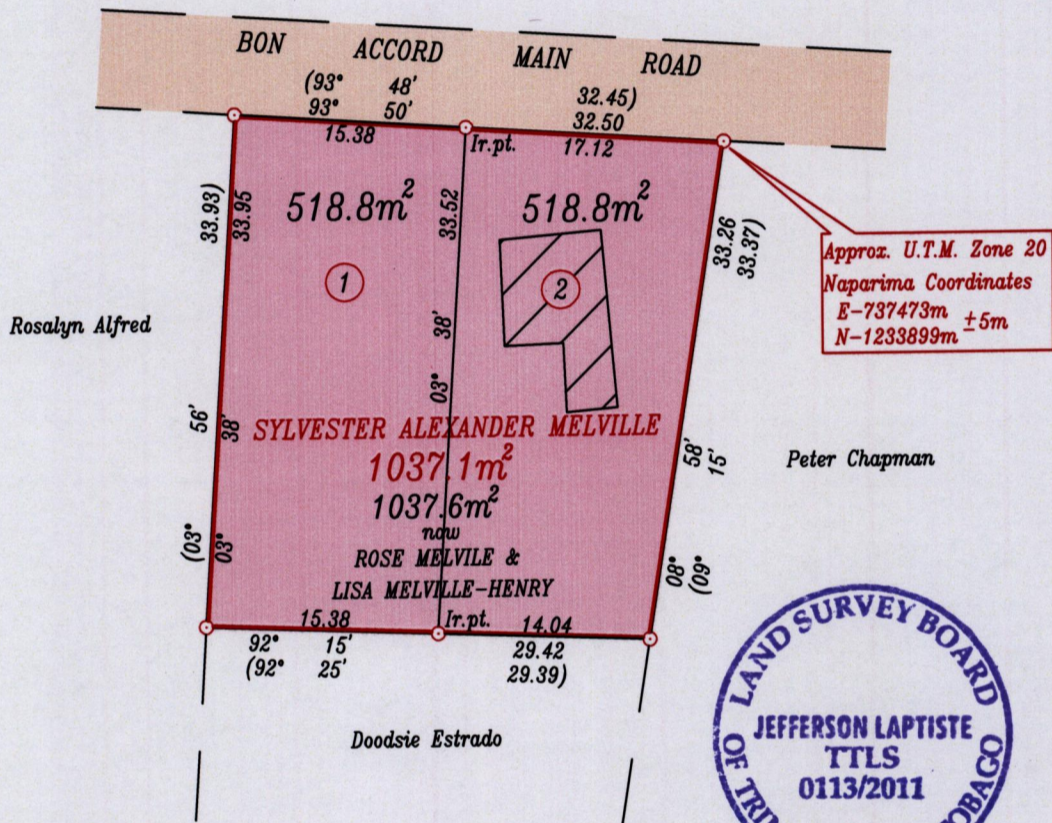
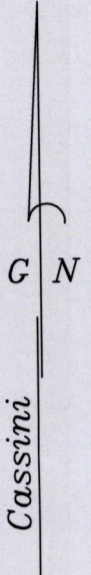

737643.486
1234084.671
1993 84

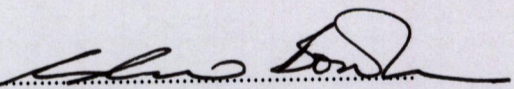
Approved 
Director of Surveys 2012.1.24

Coordinates obtained from hand held G.P.S. receiver
Bearings are grid based on solar observations
○ denotes iron found except otherwise stated

SCALE 1:500
Distances are in metres

Plan of two Parcels of land coloured pink in the Ward of Tobago.
Containing together one thousand and thirty seven point six square metres.
Surveyed by me with due authority, in October, 2009.

I hereby certify in accordance with Reg. 25(I) of the Land Surveyors' Regulations 1998 that
this plan is correct.

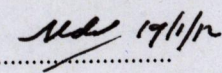
Checked by  17/1/12

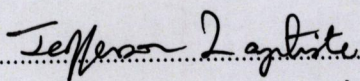

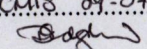
Entered on C.M.S. 09-07-2012

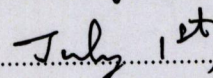
Trinidad and Tobago Land Surveyor  July 1st 2011