

RPO Vol. 12 Fol. 581
 CT. Vol. 3109 Fol. 227

Ward of Siparia
 County of St. Patrick
 Cadastral Sheet G.7.M, 63A
 4/c

13336

67

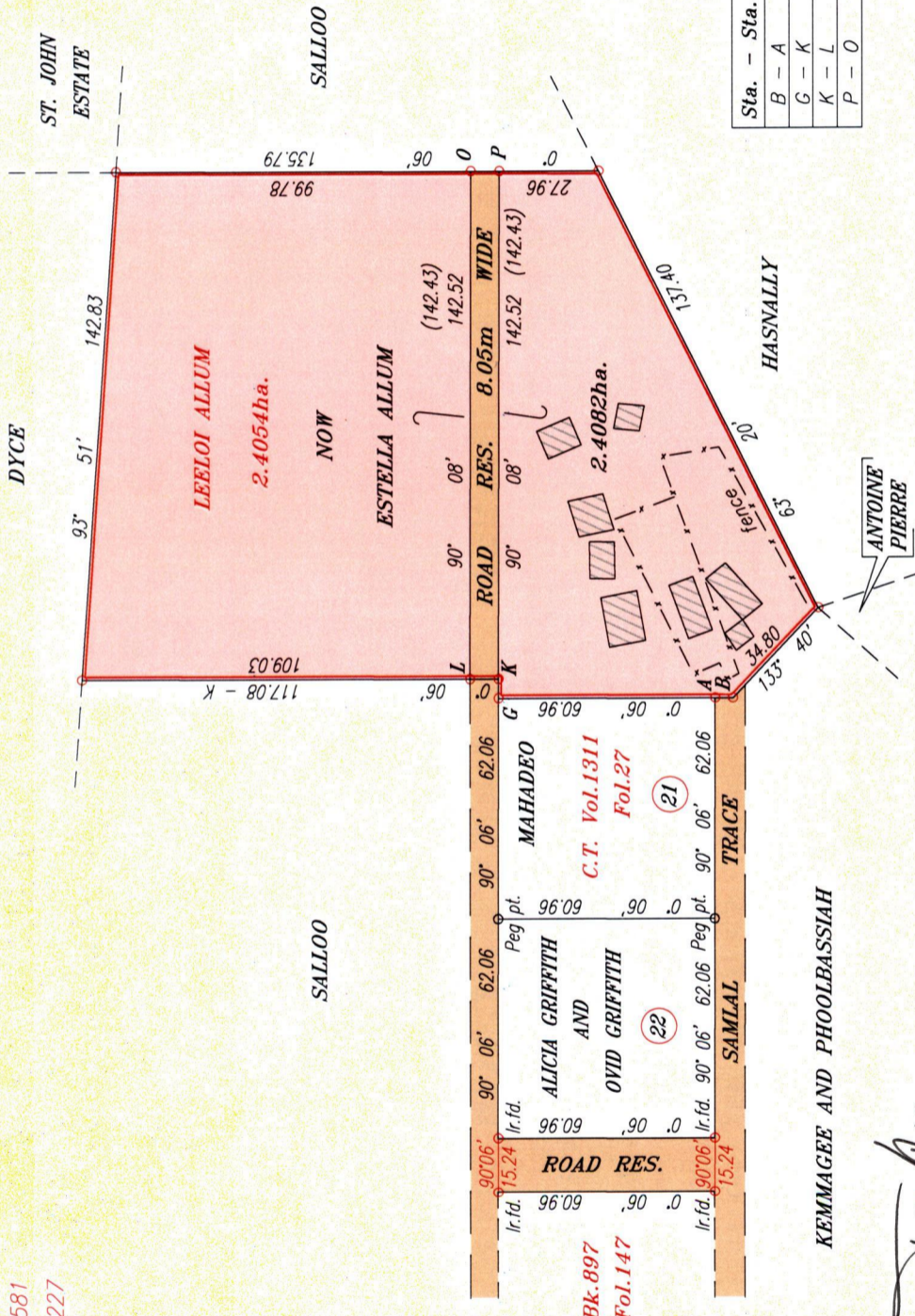
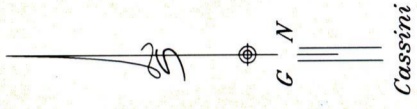

Sta. - Sta.	Bearing	Distance
B - A	0° 06'	5.02
G - K	90° 06'	5.43
K - L	0° 06'	8.05
P - O	0° 06'	8.05

References:
 Bk. 456 Fol. 179
 Bk. 897 Fol. 147

SCALE 1:2000

To obtain compass bearing subtract 6 minutes. Distances are in metres.
 Plan of a Parcel of land coloured pink in the Ward of Siparia Containing two point zero eight two hectares
 Surveyed by me with due authority, in May 2006.

In accordance with Regulation 25(1) of the Land Surveyors' Regulations 1998, I certify that this plan is correct.

Approved: *[Signature]*
 Director of Surveys

2007-04-17
 O Denotes Iron put except otherwise stated.

Checked by: *[Signature]*
 Entered:

[Signature]
 Trinidad & Tobago Land Surveyor 9th March 2007

Original Book 456 fol. 179

