

R.P.O Vol. 125 Fol. 675
C.T. Vol. 662 Fol. 171

Ward of Siparia
County of St. Patrick
Cadastral Sheet (G.12.G). 63E
1/c

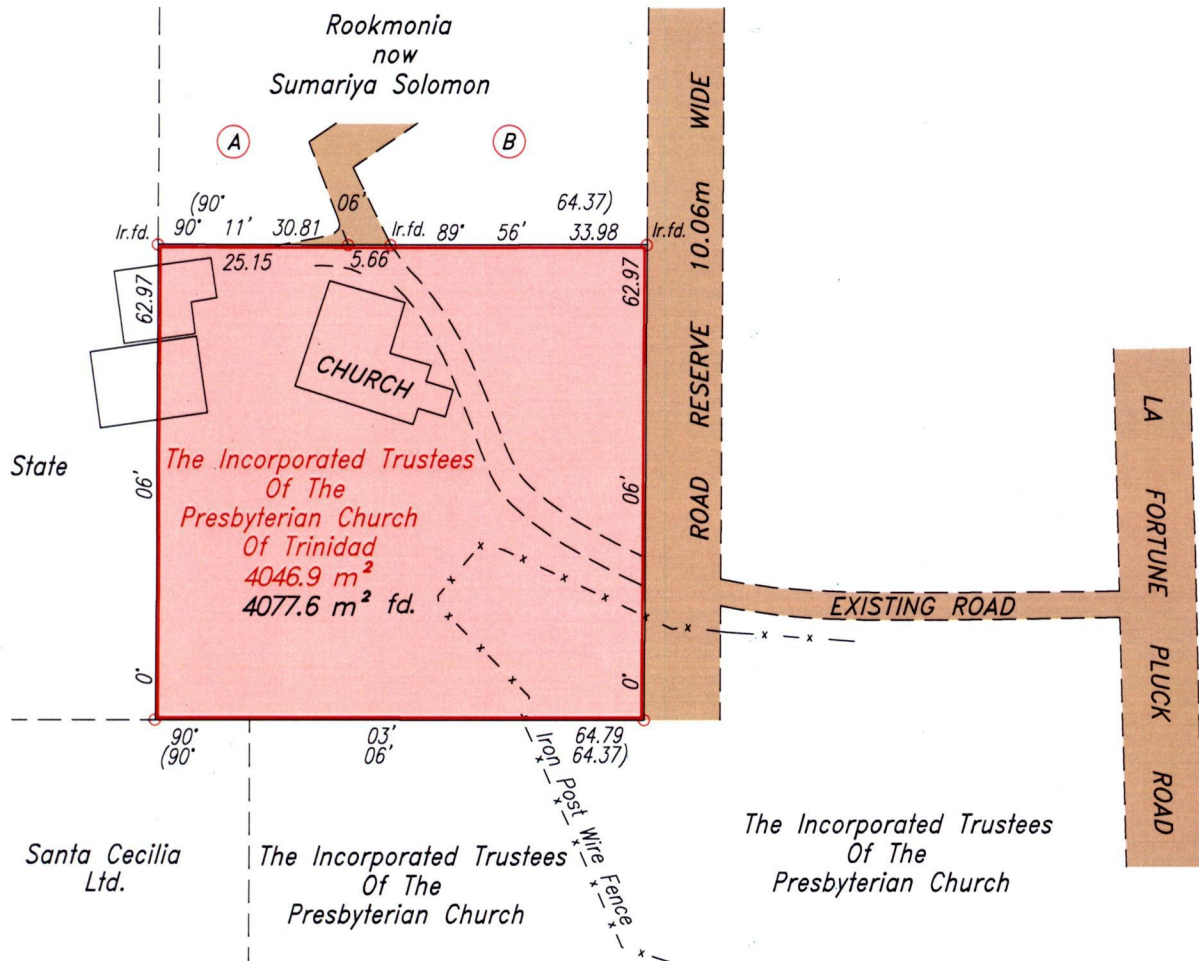
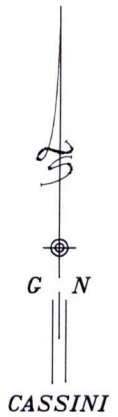

Approved..... *Tyrone Pears*
Director of Surveys
2007-02-13

Ref: Bk. 723 fol. 122
Bk. 1256 fol. 163
SCALE 1:1000

o Denotes Iron put except otherwise stated.

Note: Bearings are Cassini grid based on solar observations. Distances are in metres.

To obtain compass bearing subtract 06 minutes.

Plan of a Parcel of land coloured pink in the Ward of Siparia

Containing four thousand and seventy seven point six square metres

Surveyed by me, with due authority, in October 2006.

In accordance with Regulation 25(1) of the Land Surveyors' Regulations 1998,

I certify that this plan is correct.

Checked by..... *Handwritten signature* 8/1/07

Entered

Lenny W. Hanomansingh
Trinidad & Tobago Land Surveyor 2007-02-13

