

R.P.O. Vol. 188 Fol. 515

Remaining Portion

Cadastral Sheet G.17.C. 73B

C.T. Vol. 3494 Fol. 527

Ward of Siparia

1/b,1/d

Vide Bk. 428 fol.158

Plan filed in Vol. 3494 fol. 533

County of St.Patrick.

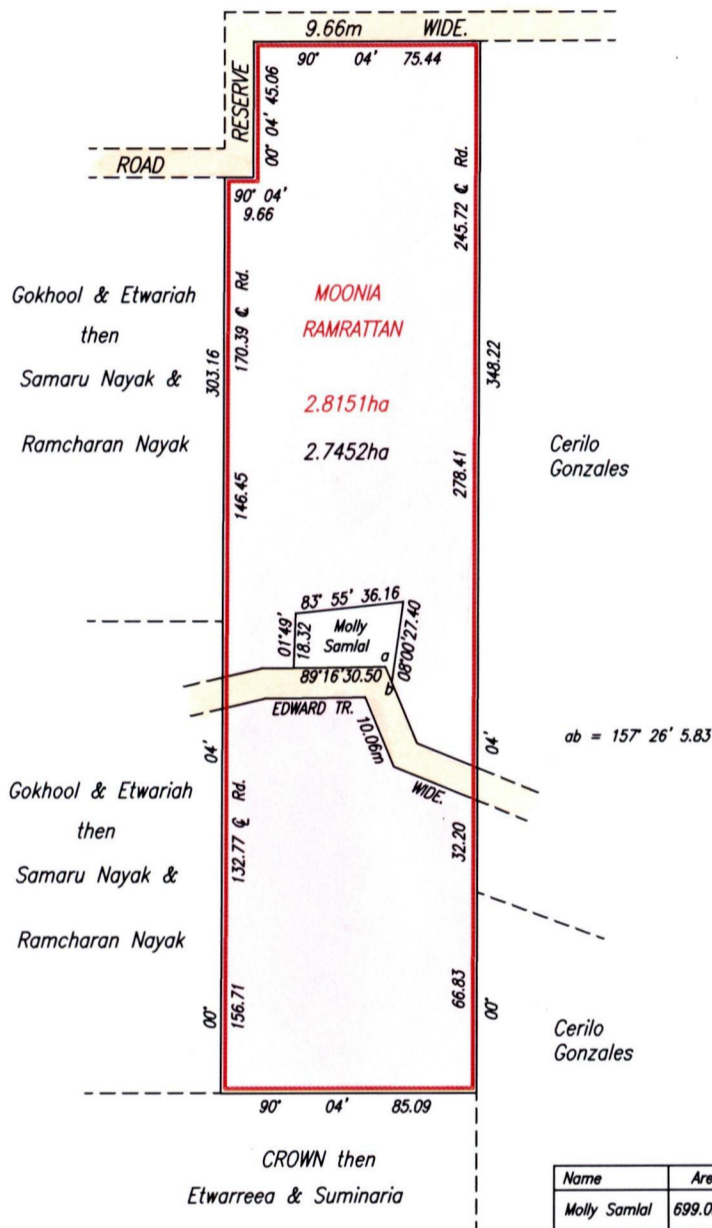

Approved

*[Signature]*  
Director of Surveys

SCALE 1:2500

Distances are in metres

This is a true copy of a diagram of a Parcel of land in the Ward of Siparia Containing two point eight one five one hectares originally transferred to MOONIA RAMRATTAN Showing a portion coloured pink and containing two point seven four five two hectares being the Remainder after one previous transfer of another portion of the land. In accordance with Regulation 25 (1) of the Land Surveyors' Regulations 1998, I certify that this plan is correct.

Checked by

*[Signature]* 13/7/07

*[Signature]*

Entered on

Trinidad & Tobago Land Surveyor. 8<sup>th</sup> June 2007.

PATH = EV700 D:\Drawings07\Moonia Ramrattan.dwg.

