

R.P.O. Vol. 192  
C.T. Vol.

Fol. 583  
Fol.

'St. Mary's Village'

now or formerly James Pierre

Ward of Ortoire  
County of Victoria  
Cadastral Sheet G.15.B., 64E  
2/b

Ref. Bk. 1267 / 88  
Bk. 358 / 105  
Bk. 328 / 187

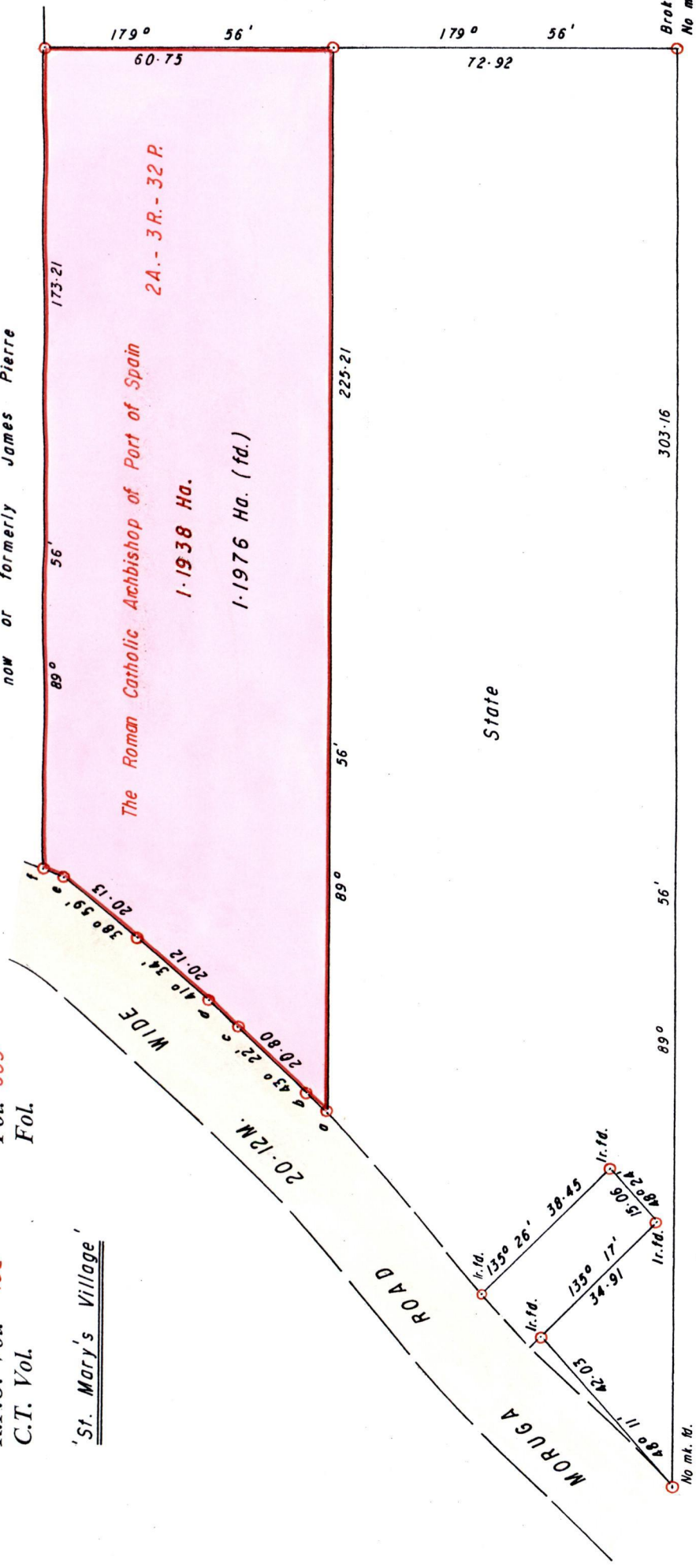

Approved  
*[Signature]*  
Director of Surveys  
2007.7.24

Bearings are Cassini Grid based on Solar Obs

PLAN of a Parcel of land coloured PINK in the Ward of Ortoire  
Containing one point one nine seven six hectares  
Surveyed by me, with due authority, in May 2005 for the Roman Catholic Archbishop of Port of Spain  
In accordance with Regulation 25 (1) of the Land Surveyors' Regulations 1998, I certify that this plan is correct.

Checked by *[Signature]*  
Entered .....

SCALE 1/1250  
Distances are in METRES

○ Denotes Iron put unless otherwise stated

a-b	44° 26'	5.40
c-d	44° 31'	8.56
e-f	20° 11'	5.36

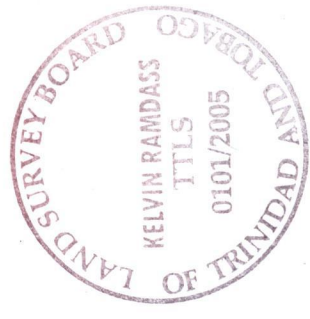

176

Trinidad and Tobago Land Surveyor ..... 29.1.08 ..... 2005.