

Moonan Trace

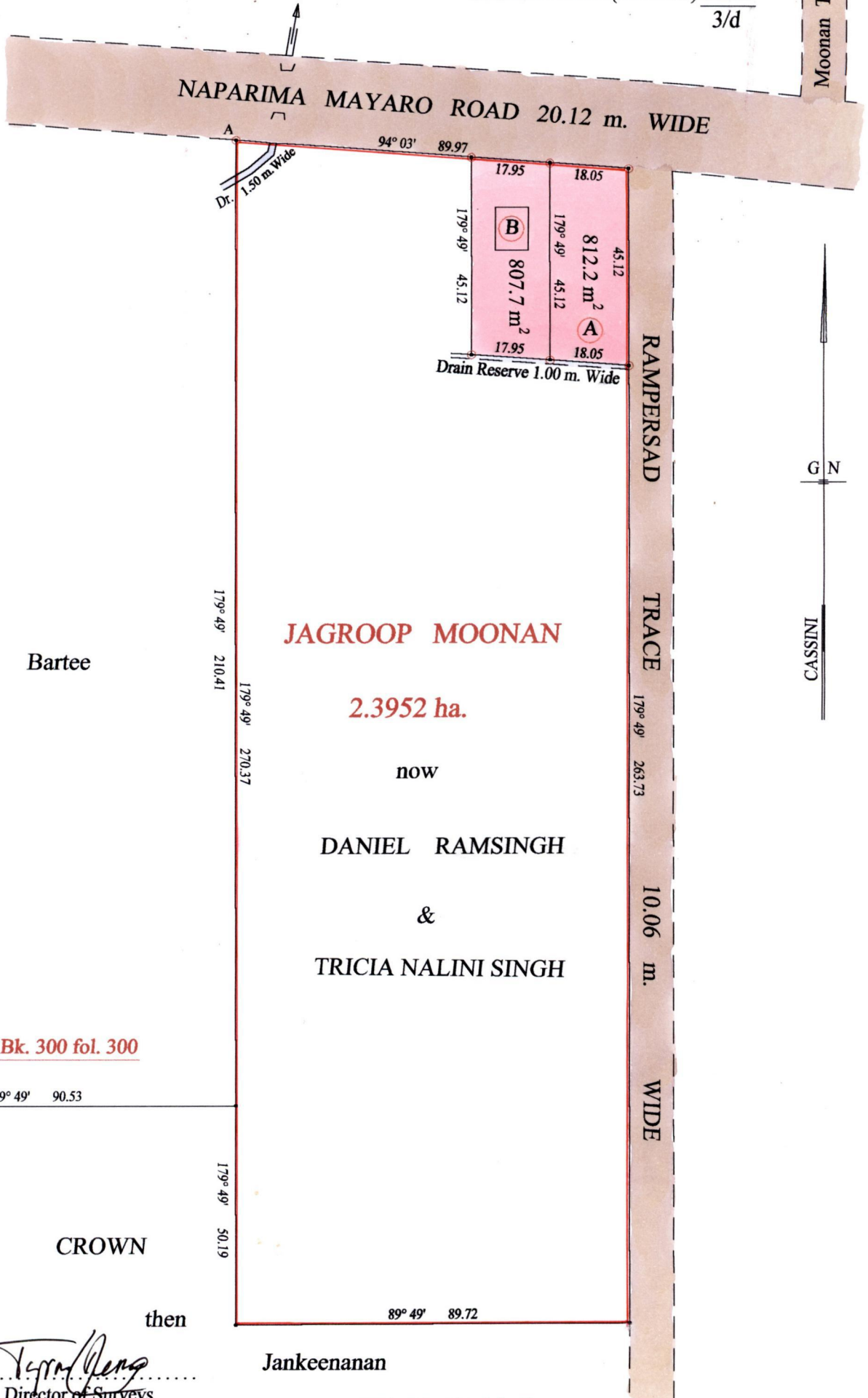

Approved *[Signature]*
 Director of Surveys
 2007.7.24

Vide Bk. 301 fol. 68 SCALE : 1:1250

○ Denotes Iron put except stated otherwise.
 Note: Bearings are cassini grid based on solar observations Distances are in metres
 PLAN of 2 Parcels of land coloured pink in the Ward of Cocal
 Containing together one thousand six hundred and nineteen point nine square metres
 Surveyed by me, with due authority, in October 2003
 In accordance with Regulation 25 (1) of the Land Surveyors' Regulations 1998,
 I certify that this plan is correct.

Checked by *[Signature]* 18/7/07 *[Signature]*

Entered on Trinidad & Tobago Land Surveyor 12.06.2007

