

U.P.R.N.....

R.P.O Vol. Fol.
C.T Vol. 4001 Fol. 313

Cadastral Sheet I.14.0
Ward of Tobago
Parish of St. Mary
GLAMORGAN

Vide Bk.1198 Fol.141

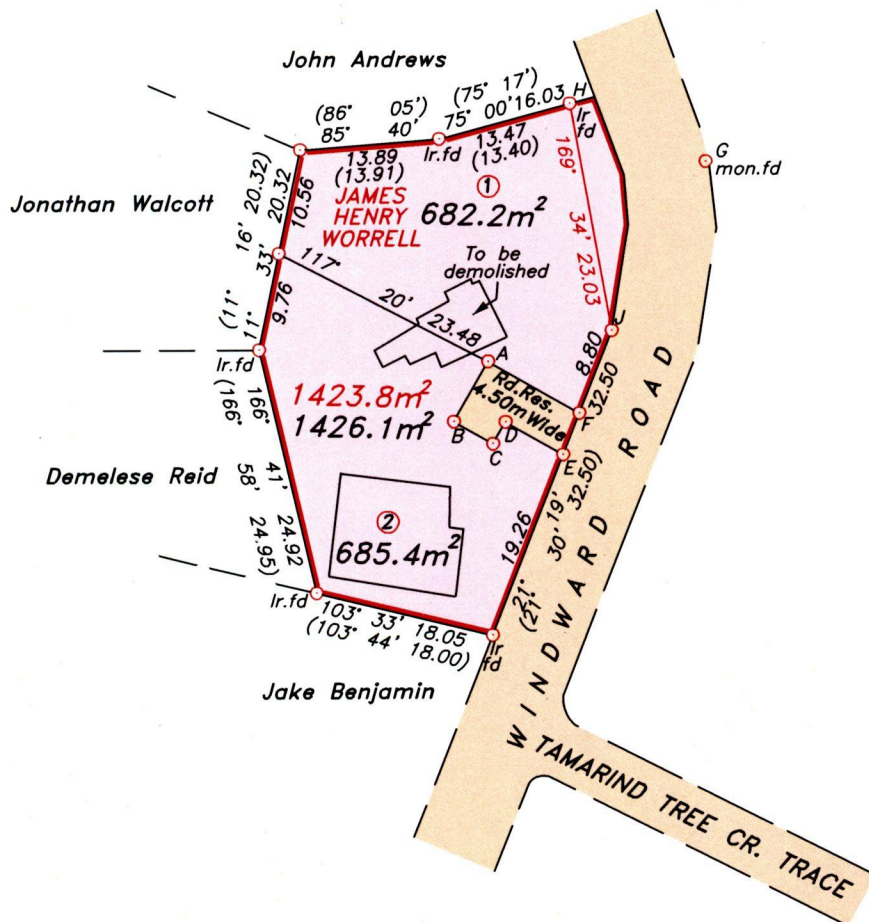

LEGEND

LINE	DIRECTION	DISTANCE
B-A	29° 44'	6.89
B-C	119° 44'	4.50
C-D	29° 44'	2.50
D-E	119° 44'	6.60
E-F	21° 17'	4.43
A-F	119° 44'	10.45
F-G	26° 39'	27.96



Approved

[Signature]
 Director of Surveys
 2507-6-26

○ Denotes iron put, except otherwise stated.

SCALE 1:750

Bearings are grid based on solar observations

Distances are in metres

PLAN of 2 parcels of land coloured pink in the Ward of Tobago
 Containing together one thousand three hundred and sixty seven point six square metres.
 Surveyed by me, with due authority on 3rd June 2005.

In accordance with Regulation 25 (1) of the Land Surveyors' Regulations 1998, I certify that this plan is correct.

Checked by *[Signature]* 16.2.07
Entered.....

[Signature]
 16th February
 Lyndon Antoine

Trinidad & Tobago Land Surveyor..... 2007.

Original Book 1198 fol. 141

