

Process ID # 19832

To be brought under the Provisions of the
Real Property Ordinance

Vide Bk. 1056 fol 182
Vide Plan EB 174

Cadastral Sheet G.7.I. 63A
1/d
Ward of Siparia
County of St.Patrick.
St.Mary's Village

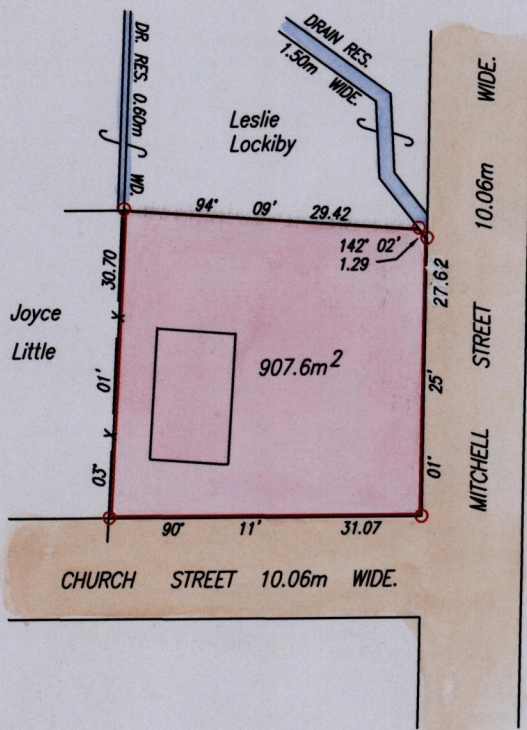
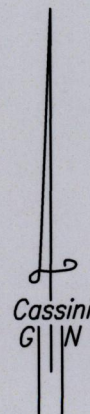

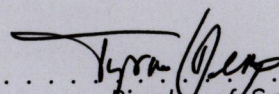
Approved 
Director of Surveys
2007-6-22

SCALE 1:750
Distances are in metres

-X-X-X- Denotes FENCE
○ Denotes Iron put except where otherwise stated
Bearings are Cassini Grid based on Solar Observations
PLAN of a Parcel of land coloured pink in the Ward of Siparia
Containing nine hundred and seven point six square metres.
Surveyed by me, with due authority, on 13th. November, 2006 for Joseph Lockiby.
In accordance with Regulation 25 (1) of the Land Surveyors' Regulations 1998,
I certify that this plan is correct.

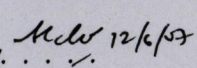
Checked by 

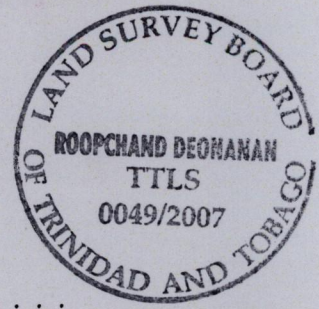

Entered on Trinidad & Tobago Land Surveyor. 3rd April 2007.
PATH = EV700 D:\Drawings07\Lockiby.dwg.