

Process ID # 80203

To be brought under the provisions of the Real Property Ordinance

Ward of Naparima
County of Victoria
Cadastral Sheet G.4.F., 54D
1/6

VIDE Plan D.L.35

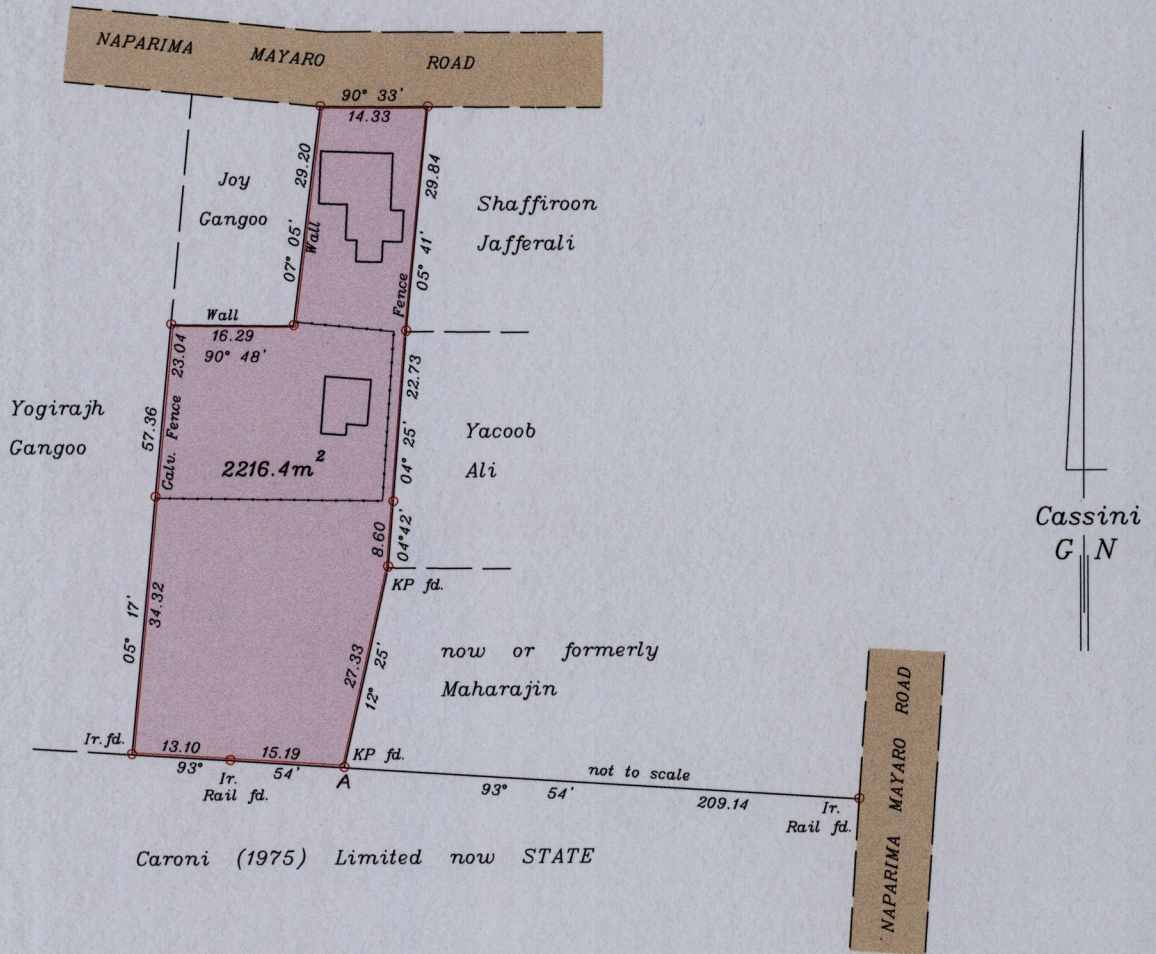

A = 676 265mE, 1 137 545mN
Co-ordinates are U.T.M. Zone 20 Naparima Datum +/-5m
scaled from L&S 1/10,000 sheets

Approved *[Signature]*
Director of Surveys
2008.10.07

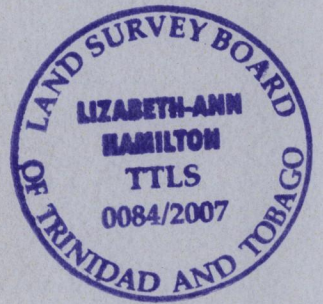

SCALE 1:1000

o denotes Ir. put unless otherwise stated

Bearings are Cassini Grid based on Solar Observations Distances are in metres

PLAN of a Parcel of land coloured pink in the Ward of Savana Grande
Containing two thousand two hundred and sixteen point four square metres
Surveyed by me, with due authority, on September 05, 2007 for Nazir Mohammed
In accordance with Regulation 25(1) of the Land Surveyors' Regulations 1998,
I certify that this plan is correct.

Checked by *[Signature]* 29.9.08

[Signature]

Entered

Trinidad & Tobago Land Surveyor October 22 2007