

To be brought under the provisions of the Real Property Ordinance

Ward of Naparima  
County of Victoria  
Cadastral Sheet 54D, G.4.E.  
1/0

process ID# 80080

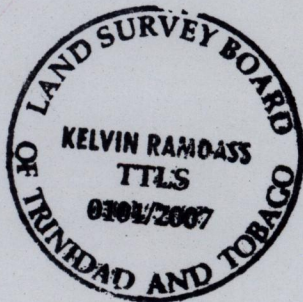
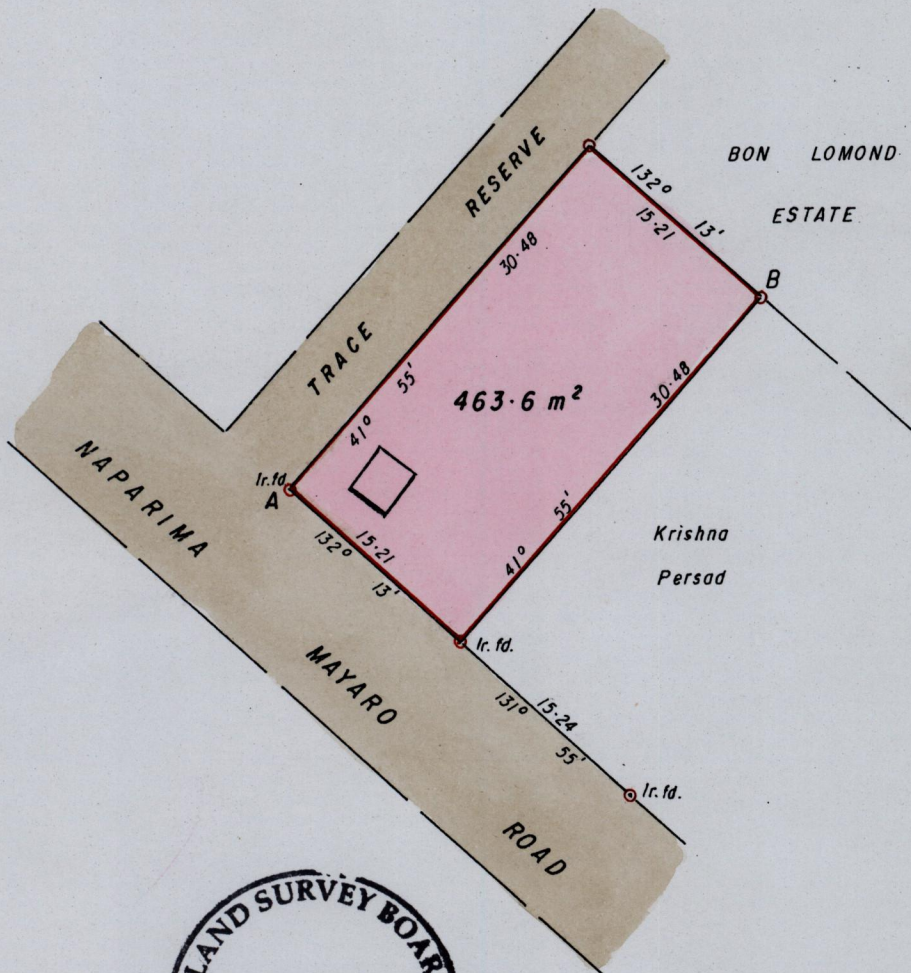
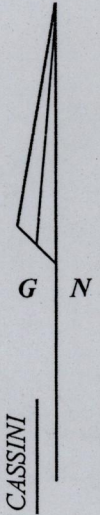

Coords A WGS84 U.T.M. Zone20

N 1137989  
E 675863 +/- 5m

B N 1138001 E 675874

o Denotes Iron put unless otherwise stated

Bearings are Cassini Grid based on Solar Obs.

SCALE 1/500

Distances are in METRES

Approved

Director of Surveys 2008721

Note: To Obtain compass bearings add/subtract minutes

PLAN of a Parcel of land coloured PINK in the Ward of Naparima  
Containing four hundred and sixty three point six square metres  
Surveyed by me, with due authority, on the 10th. April 2007 for Ropesh Kamal Ramlochan  
In accordance with Regulation 25 (1) of the Land Surveyors' Regulations 1998,  
I certify that this plan is correct.

Checked by K. 2.4.08

Entered

Trinidad and Tobago Land Surveyor 06/05/2007