

Process JD# 16702

Ward of Guayaguayare
County of Mayaro
Cadastral Sheet (H.4.D. & H.) 56.E.
2/a

located
(37)

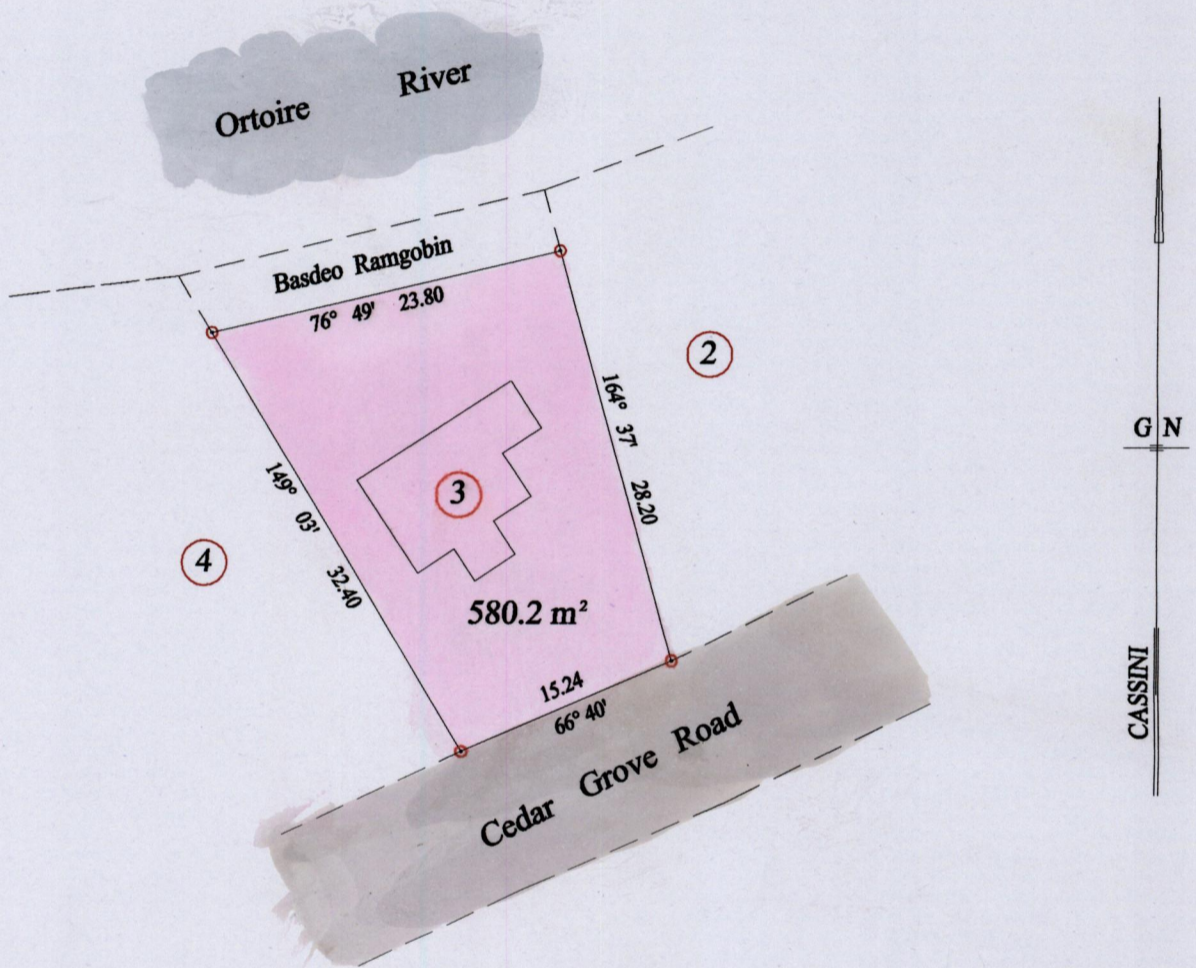

o Denotes Iron put except stated otherwise.

SCALE : 1:500

Note: Bearings are cassini grid based on solar observations Distances are in metres

PLAN of a Parcel of land coloured pink in the Ward of Guayaguayare
Containing five hundred and eighty point two square metres
Surveyed by me, with due authority, in January 2005 for Basdeo Ramgobin
In accordance with Regulation 25 (1) of the Land Surveyors' Regulations 1998,
I certify that this plan is correct.

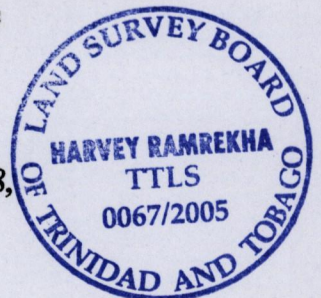

Entered

Trinidad & Tobago Land Surveyor 5 - 08 - 2005