

1334

67

Process ID# 76759

Cadastral Sheet H.10.A, 56E
Ward of Guayaguayare 4/d
County of Mayaro

ECCLES VILLAGE

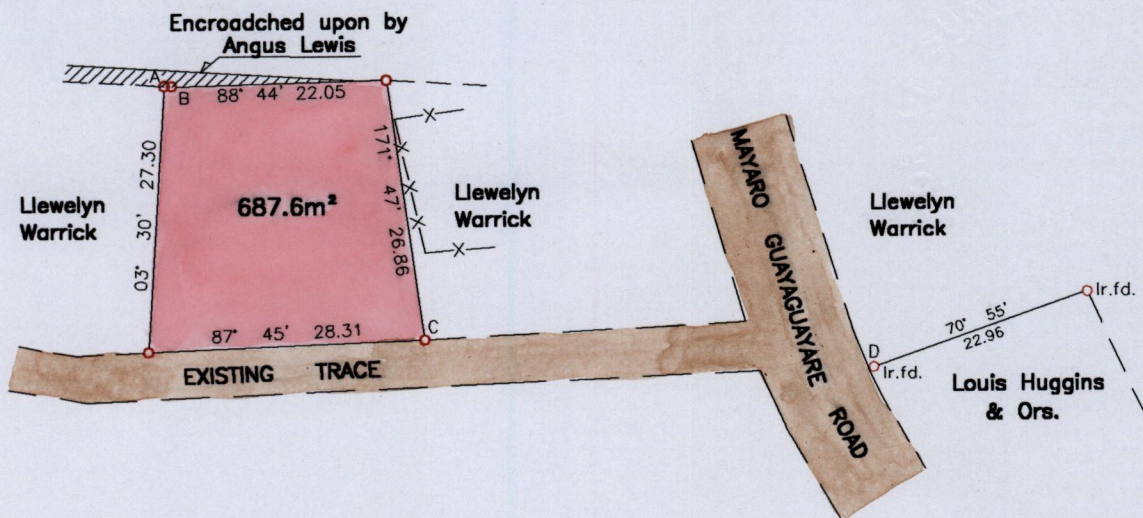

A-B 93° 30' 0.74
C-D 93° 52' 49.98
Wire Fence -x-x-x



Located
(10)

SCALE 1/750

Distances are in Metres

○ Denotes Iron put except otherwise stated

Bearings are Cassini Grid based on Solar Observations

Plan of a Parcel of land coloured pink in the Ward of Guayaguayare
Containing six eight seven point six square metres

Surveyed by me with due authority, in March 2006 for Llewelyn Warrick
In accordance with Regulation 25 (1) of the Land Surveyors' Regulations 1998,
I certify that this plan is correct.

Entered

.....*Rawle Derrick*.....
Trinidad & Tobago Land Surveyor*April 05*.....2006