

Cadastral Sheet H.20.A.56E/4/d

Ward of Guayaguayare
County of Mayaro.
Grand Lagoon

cannot locate

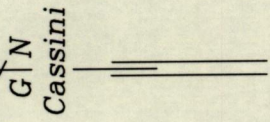

ROAD	LEGEND
A-B	90° 00' 15.72
B-C	146° 46' 15.24
C-D	157° 39' 12.80
D-E	119° 22' 16.02
E-F	111° 24' 14.37
F-G	141° 09' 12.98
G-H	182° 42' 24.57

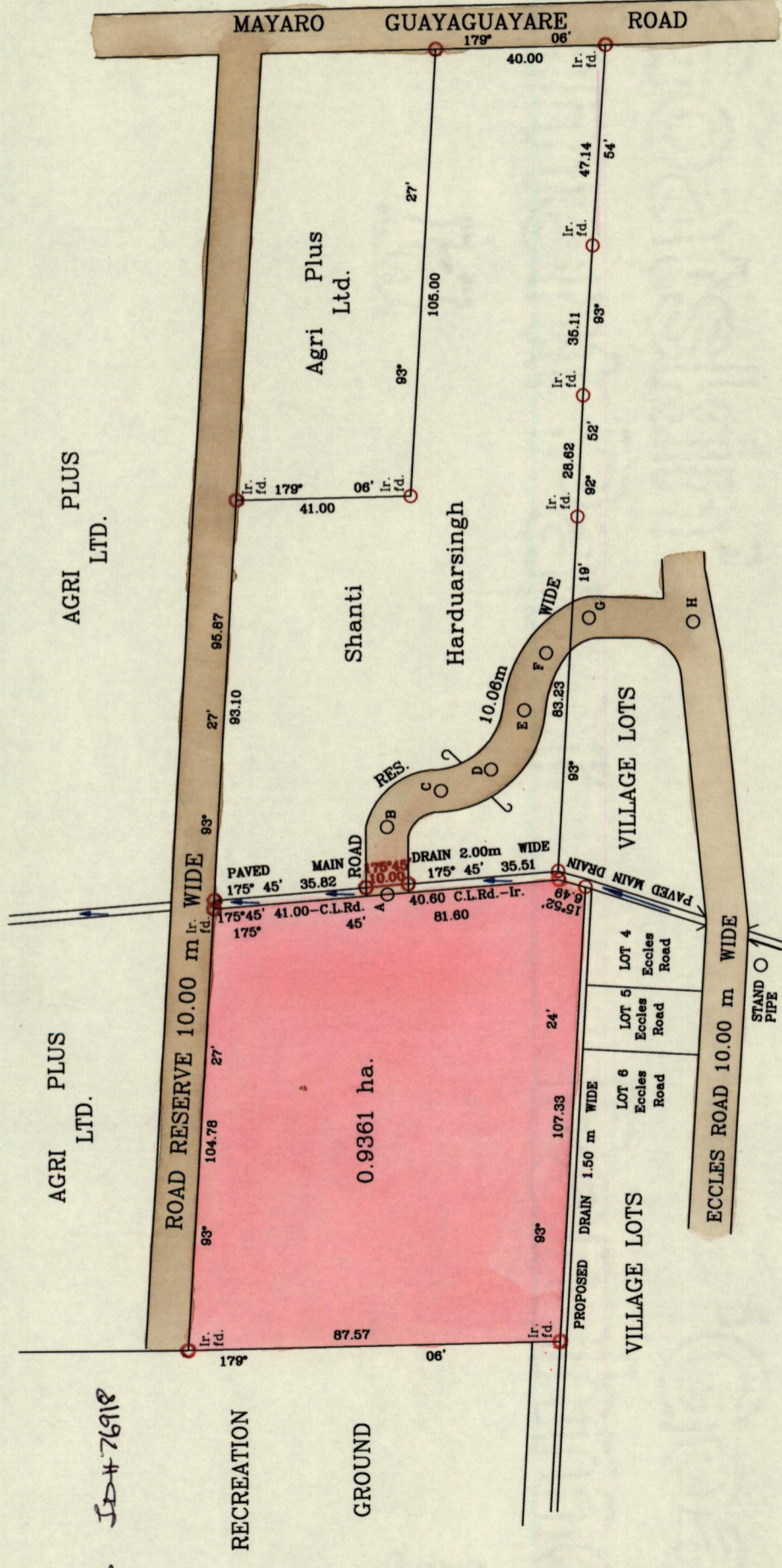
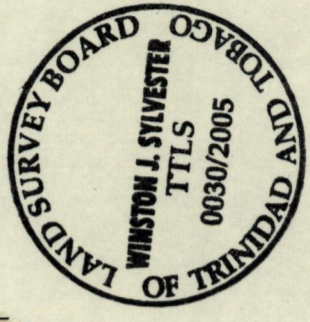

SCALE: 1/1500

o Denotes iron put unless otherwise stated
Bearings based on solar observations.

Note : To obtain compass bearing add minutes Distances are in metres.

PLAN of a parcels of land coloured pink in the Ward of Guayaguayare. Containing zero point nine three six one hectares.

Surveyed by me, with due authority, in July, 2005 for Shanti Harduarsingh In accordance with regulation 25 (1) of the Land Surveyors' Regulations 1998,

I certify that this plan is correct.

[Handwritten signature]

Entered

Trinidad & Tobago Land Surveyor..... 17-10-05

Process ID# 76918