

U.P.R.N.....

Ward of Guayaguayare
County of Mayaro
Cadastral Sheet (H.5.A) 56B
4/d

located

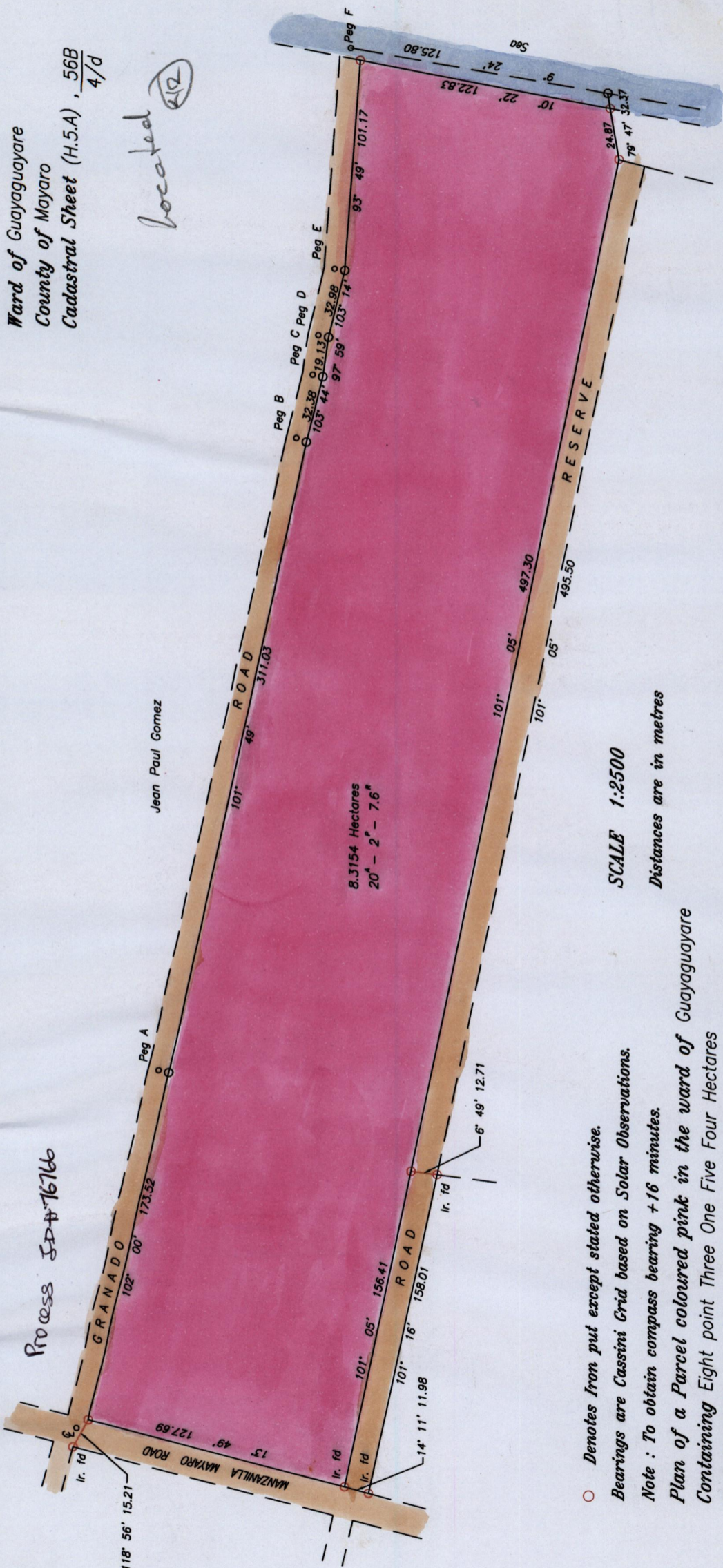

○ Denotes Iron put except stated otherwise.
Bearings are Cassini Grid based on Solar Observations.
Note : To obtain compass bearing +16 minutes.
Plan of a Parcel coloured pink in the ward of Guayaguayare
Containing Eight point Three One Five Four Hectares
Redefined by me based on Surveys done by Lawrence Clarke at the request of Walter Gomez
in September, 2003
In accordance with Regulation 25 (1) of the Land Surveyors' Regulations 1998,
I certify that this plan is correct.

SCALE 1:2500

Distances are in metres

CL of Mayaro Rd.	Peg. A	101° 56'	178.70
	Peg. B	101° 49'	311.11
	Peg. C	103° 44'	32.21
	Peg. D	97° 59'	19.11
	Peg. E	103° 14'	32.80
	Peg. F	93° 49'	106.25

Mutanomansijl

Entered

Trinidad & Tobago Land Surveyor.....22/09/.....2003