

1334

222

Process ID# 77531

109

A N^o 5812

L. and S.—53

Cadastral Sheet $\frac{76 B}{1/a \& 1/b}$ (H.19.C)

Ward of Guayaguayare

County of Mayaro

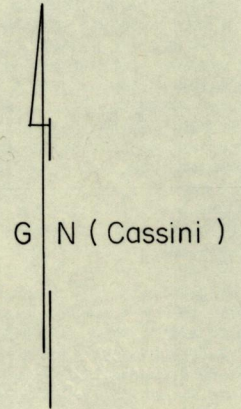
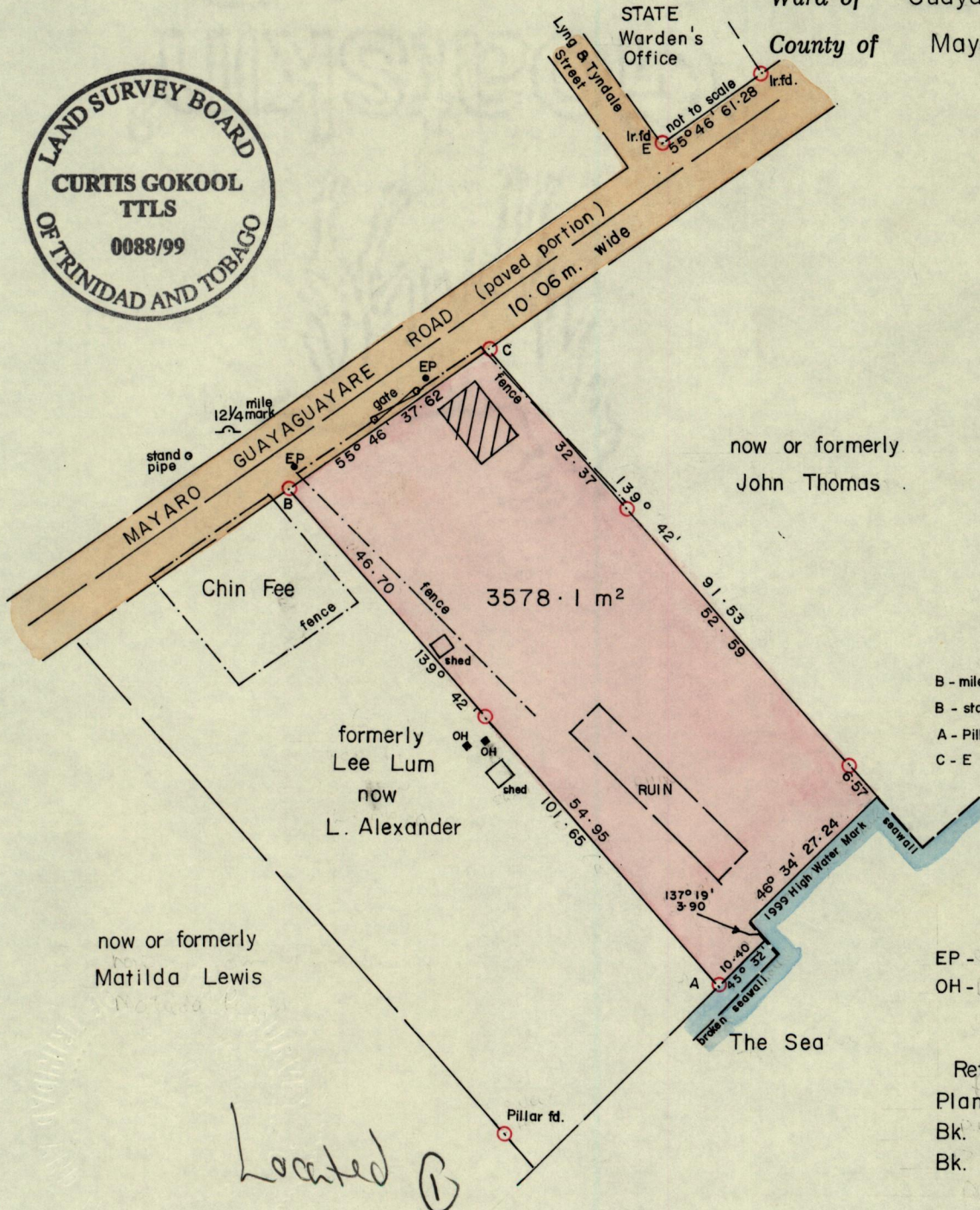
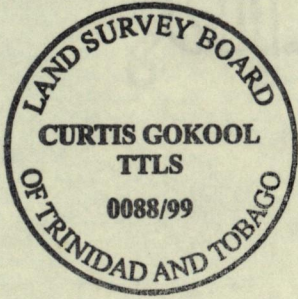

now or formerly John Thomas

now or formerly Matilda Lewis

formerly Lee Lum
now L. Alexander

B - mile mark	316° 25'	13.10
B - standpipe	289° 30'	16.01
A - Pillar fd	236° 17'	143.91
C - E	54° 26'	590.19

} not to scale

EP - electricity pole
OH - out house

References
Plan AK 97
Bk. 1162 Fol. 198
Bk. 885 Fol. 117

○ Denotes Iron put unless otherwise stated.
Bearings are based on solar observations

SCALE 1 : 1000

Note: To obtain compass bearing subtract 12 minutes Distances are in METRES
PLAN of a Parcel of land coloured pink in the Ward of Guayaguayare
Containing three thousand five hundred and seventy-eight point one square metres
Surveyed by me, with due authority, in August 1999 for Jim Beazer

Entered *Curtis Gokool*
Land Surveyor, Trinidad August 12 1999 ..
and Tobago Certified Correct