

Process ID# 76780

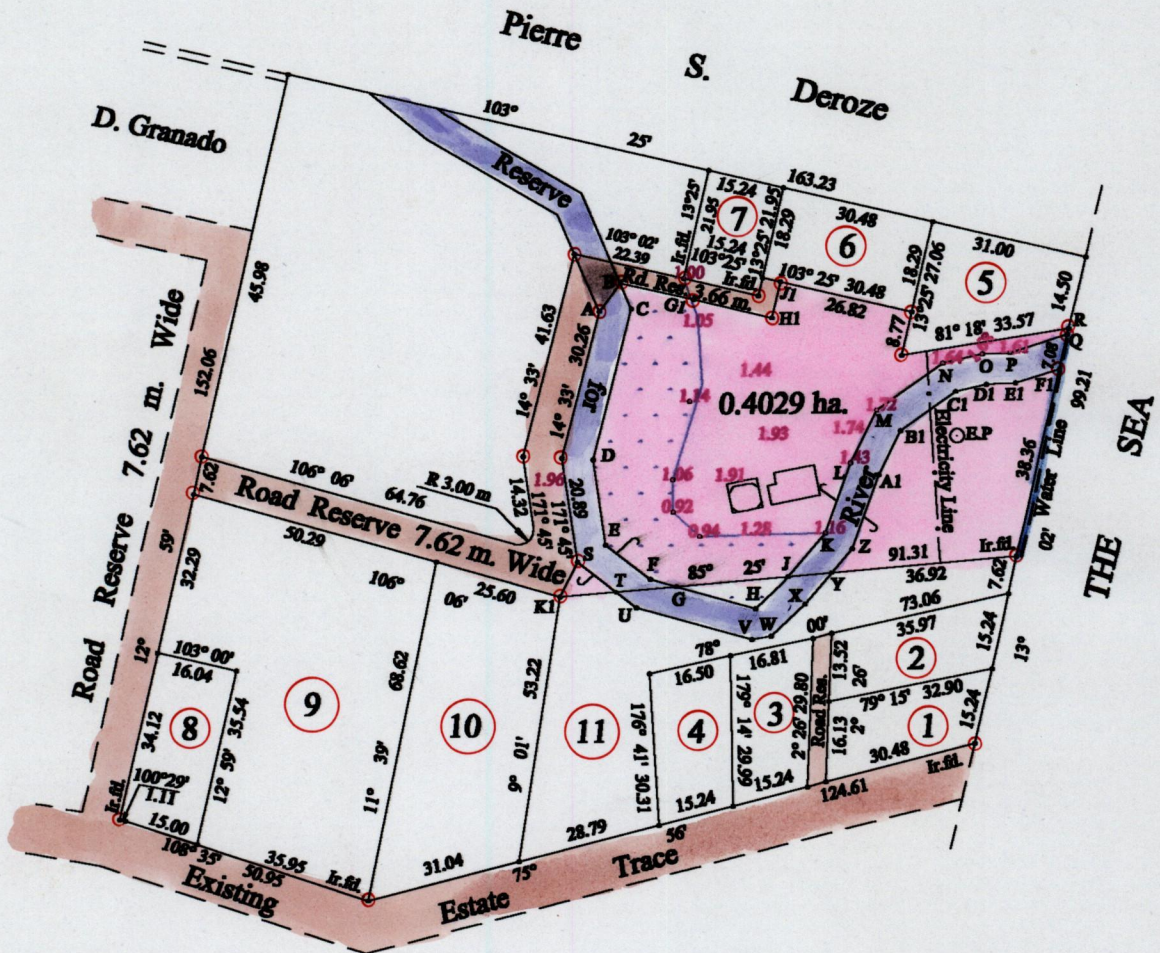

not located.

A - B	37° 36'	6.99	S - T	127° 53'	9.77	G - J	85° 25'	22.36
B - C	156° 47'	5.49	T - U	127° 53'	5.09	J - Y	85° 25'	8.72
C - D	194° 33'	31.12	U - V	105° 47'	23.88	H1 - J1	13° 25'	7.32
D - E	171° 45'	17.20	V - W	80° 48'	3.92	B - G1	103° 02'	14.91
E - F	127° 53'	11.21	W - X	46° 10'	10.87	G1 - H1	103° 25'	16.10
F - G	105° 47'	5.37	X - Y	41° 02'	6.51			
G - H	105° 47'	16.40	Y - Z	41° 02'	6.26			
H - J	46° 10'	9.02	Z - A1	20° 01'	15.62			
J - K	41° 02'	11.36	A1 - B1	26° 43'	9.90			
K - L	20° 01'	14.85	B1 - C1	54° 34'	13.37			
L - M	26° 43'	11.77	C1 - D1	77° 38'	6.25			
M - N	54° 34'	16.13	D1 - E1	87° 43'	5.80			
N - O	77° 38'	8.04	E1 - F1	72° 30'	9.17			
O - P	87° 43'	5.52	K1 - S	27° 03'	7.75			
P - Q	72° 30'	11.95	K1 - T	85° 25'	11.27			
Q - R	13° 02'	1.17	T - G	85° 25'	12.03			

○ Denotes Iron put except stated otherwise.

SCALE : 1:1500

Note: Bearings are cassini grid based on solar observations

Distances are in metres

PLAN of a Parcel of land coloured pink in the Ward of Guayaguayare  
Containing zero point four zero two nine hectare  
And also showing spot heights based on T.B.M. Ir.fd. 1.00 m.,  
and extent of low area and utility features.

Surveyed by me, with due authority, in May 2001 for David Granado  
In accordance with Rule 25 (1) of the Land Surveyors Regulations 1998,  
I certify that this plan is correct.

Entered

Trinidad & Tobago Land Surveyor

20.06.2001  
2001-08-13

